

NOTICE!!

These documents have been scanned!

Do not place un-scanned documents beneath this notice!

Do not remove this notice from this file!

GPO Jacket No. 560-102
Print Order 61540
Rise Business Services, LLC
Job=AZ15 7/9/2019



Box Number= AZ15153



Claim Begin-End: AMC450979-AMC451006

1 Initial Receipt



AZ15153-20

AMC449739-AMC451385

United States Department of the Interior
Bureau of Land Management
 DIV OF LANDS, MINRLS & ENERGY
 ONE N CENTRAL AVE
 PHOENIX, AZ 85004 -4427
 Phone: 602-417-9200

Receipt

No: 4170839

Transaction #: 4285246	
Date of Transaction: 05/24/2018	
CUSTOMER:	
	NICHOLAS BARR 5441 E MINING CAMP ST APACHE JUNCTION, AZ 85119-9577 US

ENTERED
 MAY 30 2018
 BY: RAm

LINE #	QTY	DESCRIPTION	REMARKS	UNIT PRICE	TOTAL
1	28.00	LOCATABLE MINERALS / MINING CLAIMS- NEW, UNADJUD, ONE OR MORE AUTH NOS / NEW MINING CLAIMS LOCATION FEE CASES: AMC450979/\$37.00, AMC450980/\$37.00, AMC450981/\$37.00, AMC450982/\$37.00, AMC450983/\$37.00, AMC450984/\$37.00, AMC450985/\$37.00, AMC450986/\$37.00, AMC450987/\$37.00, AMC450988/\$37.00, AMC450989/\$37.00, AMC450990/\$37.00, AMC450991/\$37.00, AMC450992/\$37.00, AMC450993/\$37.00, AMC450994/\$37.00, AMC450995/\$37.00, AMC450996/\$37.00, AMC450997/\$37.00, AMC450998/\$37.00, AMC450999/\$37.00, AMC451000/\$37.00, AMC451001/\$37.00, AMC451002/\$37.00, AMC451003/\$37.00, AMC451004/\$37.00, AMC451005/\$37.00, AMC451006/\$37.00		- n/a -	1036.00
2	28.00	LOCATABLE MINERALS / MINING CLAIMS- NEW, UNADJUD, ONE OR MORE AUTH NOS / NEW MINING CLAIM PROCESSING FEE CASES: AMC450979/\$20.00, AMC450980/\$20.00, AMC450981/\$20.00, AMC450982/\$20.00, AMC450983/\$20.00, AMC450984/\$20.00, AMC450985/\$20.00, AMC450986/\$20.00, AMC450987/\$20.00, AMC450988/\$20.00, AMC450989/\$20.00, AMC450990/\$20.00, AMC450991/\$20.00, AMC450992/\$20.00, AMC450993/\$20.00, AMC450994/\$20.00, AMC450995/\$20.00, AMC450996/\$20.00, AMC450997/\$20.00, AMC450998/\$20.00, AMC450999/\$20.00, AMC451000/\$20.00,		- n/a -	560.00

		AMC451001/\$20.00, AMC451002/\$20.00, AMC451003/\$20.00, AMC451004/\$20.00, AMC451005/\$20.00, AMC451006/\$20.00			
3	28.00	LOCATABLE MINERALS / MINING CLAIMS- NEW, UNADJUD, ONE OR MORE AUTH NOS / NEW MINING CLAIMS MAINTENANCE FEE CASES: AMC450979/\$155.00, AMC450980/\$155.00, AMC450981/\$155.00, AMC450982/\$155.00, AMC450983/\$155.00, AMC450984/\$155.00, AMC450985/\$155.00, AMC450986/\$155.00, AMC450987/\$155.00, AMC450988/\$155.00, AMC450989/\$155.00, AMC450990/\$155.00, AMC450991/\$155.00, AMC450992/\$155.00, AMC450993/\$155.00, AMC450994/\$155.00, AMC450995/\$155.00, AMC450996/\$155.00, AMC450997/\$155.00, AMC450998/\$155.00, AMC450999/\$155.00, AMC451000/\$155.00, AMC451001/\$155.00, AMC451002/\$155.00, AMC451003/\$155.00, AMC451004/\$155.00, AMC451005/\$155.00, AMC451006/\$155.00		- n/a -	4340.00
TOTAL:				\$5,936.00	

PAYMENT INFORMATION			
1	AMOUNT:	3392.00	POSTMARKED: N/A
	TYPE:	CHECK	RECEIVED: 05/22/2018
	CHECK NO:	6786103429	
	NAME:	BARR, NICHOLAS 5441 E MINING CAMP ST APACHE JUNCTION AZ 85119-9577 US	
2	AMOUNT:	2544.00	POSTMARKED: N/A
	TYPE:	CHECK	RECEIVED: 05/22/2018
	CHECK NO:	6786104052	
	NAME:	BARR, NICHOLAS 5441 E MINING CAMP ST APACHE JUNCTION AZ 85119-9577 US	

REMARKS

This receipt was generated by the automated BLM Collections and Billing System and is a paper representation of a portion of the official electronic record contained therein.

NOTICE!!

These documents have been scanned!

Do not place un-scanned documents beneath this notice!

Do not remove this notice from this file!

GPO Jacket No. 560-102
Print Order 61540
Rise Business Services, LLC
Job=AZ15 7/9/2019



Box Number= AZ15153



Claim Begin-End: AMC450979-AMC451006

2 Correspondence



AZ15153-20

AMC449739-AMC451385

**NO
DOCUMENTS
FOUND**

NO DOCUMENTS FOUND
NO DOCUMENTS FOUND

NOTICE!!

These documents have been scanned!

Do not place un-scanned documents beneath this notice!

Do not remove this notice from this file!

GPO Jacket No. 560-102
Print Order 61540
Rise Business Services, LLC
Job=AZ15 7/9/2019



Box Number= AZ15153



Claim Begin-End: AMC450979-AMC451006

3 Transfers



AZ15153-20

AMC449739-AMC451385

**NO
DOCUMENTS
FOUND**

NO DOCUMENTS FOUND
NO DOCUMENTS FOUND

NOTICE!!

These documents have been scanned!

Do not place un-scanned documents beneath this notice!

Do not remove this notice from this file!

GPO Jacket No. 560-102
Print Order 61540
Rise Business Services, LLC
Job=AZ15 7/9/2019



Box Number= AZ15153



Claim Begin-End: AMC450979-AMC451006

4 Annual Filings



AZ15153-20

AMC449739-AMC451385

DEPARTMENT OF THE INTERIOR
BUREAU OF LAND MANAGEMENT
MINING CLAIMS

Run Date/Time: 8/20/2018

MC Maintenance Fees Paid Through the BLM Pay Portal
(by Date Paid)

Page 253 Of 316

CBS Receipt: 4237277

Printed For Lead File # AMC450979

Agency Tracking ID: 1534423072

Assessment Year: 2019

Number of BLM Serial Nr: 50

Paid On: 8/16/2018

Total Amount Paid: \$7,750.00

Claim Name	BLM Serial No	Lead File No	Amount Paid
EN 32	AMC450944	AMC450942	\$155.00
EN 45	AMC450945	AMC450942	\$155.00
EN 46	AMC450946	AMC450942	\$155.00
EN 47	AMC450947	AMC450942	\$155.00
EN 48	AMC450948	AMC450942	\$155.00
EN 49	AMC450949	AMC450942	\$155.00
EN 50	AMC450950	AMC450942	\$155.00
EN 51	AMC450951	AMC450942	\$155.00
EN 52	AMC450952	AMC450942	\$155.00
EN 53	AMC450953	AMC450942	\$155.00
EN 54	AMC450954	AMC450942	\$155.00
EN 62	AMC450955	AMC450942	\$155.00
EN 63	AMC450956	AMC450942	\$155.00
EN 64	AMC450957	AMC450942	\$155.00
EN 72	AMC450958	AMC450942	\$155.00
EN 73	AMC450959	AMC450942	\$155.00
EN 74	AMC450960	AMC450942	\$155.00
EN 82	AMC450961	AMC450942	\$155.00
EN 83	AMC450962	AMC450942	\$155.00
EN 84	AMC450963	AMC450942	\$155.00
EN 92	AMC450964	AMC450942	\$155.00
EN 93	AMC450965	AMC450942	\$155.00
EN 94	AMC450966	AMC450942	\$155.00
EN 95	AMC450967	AMC450942	\$155.00

NO WARRANTY IS MADE BY BLM FOR USE OF THE DATA FOR PURPOSES NOT INTENDED BY BLM

**DEPARTMENT OF THE INTERIOR
BUREAU OF LAND MANAGEMENT
MINING CLAIMS**

Run Date/Time: 8/20/2018

**MC Maintenance Fees Paid Through the BLM Pay Portal
(by Date Paid)**

Page 254 Of 316

EN 96	AMC450968	AMC450942	\$155.00
EN 55	AMC450979	AMC450979	\$155.00
EN 56	AMC450980	AMC450979	\$155.00
EN 57	AMC450981	AMC450979	\$155.00
EN 58	AMC450982	AMC450979	\$155.00
EN 59	AMC450983	AMC450979	\$155.00
EN 60	AMC450984	AMC450979	\$155.00
EN 61	AMC450985	AMC450979	\$155.00
EN 65	AMC450986	AMC450979	\$155.00
EN 66	AMC450987	AMC450979	\$155.00
EN 67	AMC450988	AMC450979	\$155.00
EN 68	AMC450989	AMC450979	\$155.00
EN 69	AMC450990	AMC450979	\$155.00
EN 70	AMC450991	AMC450979	\$155.00
EN 71	AMC450992	AMC450979	\$155.00
EN 75	AMC450993	AMC450979	\$155.00
EN 76	AMC450994	AMC450979	\$155.00
EN 77	AMC450995	AMC450979	\$155.00
EN 78	AMC450996	AMC450979	\$155.00
EN 79	AMC450997	AMC450979	\$155.00
EN 80	AMC450998	AMC450979	\$155.00
EN 81	AMC450999	AMC450979	\$155.00
EN 85	AMC451000	AMC450979	\$155.00
EN 86	AMC451001	AMC450979	\$155.00
EN 87	AMC451002	AMC450979	\$155.00
EN 88	AMC451003	AMC450979	\$155.00

United States Department of the Interior

Bureau of Land Management

BUSINESS & SUPPORT SVCS DIV

ONE N CENTRAL AVE SUITE 800

PHOENIX, AZ 85004 -4427

Phone: 602-417-9200

Receipt

No:

4237277

Transaction #: 4352659	
Date of Transaction: 08/16/2018	
CUSTOMER:	
JOEL ADAMS 145 WEST 67TH # 33G NEW YORK, NY 10023 US	

LINE #	QTY	DESCRIPTION	REMARKS	UNIT PRICE	TOTAL
1	1.00	LOCATABLE MINERALS / MINING CLAIMS- NOT NEW-UNADJUD, ONE AUTH NO. ONLY / MINING CLAIM MONEY RECEIVED CASES: AMC450944/\$7750.00		- n/a -	7750.00
TOTAL:					\$7,750.00

PAYMENT INFORMATION			
NOTE: Items will appear on credit card statement as "BLM O Mining Claim".			
1	AMOUNT:	7750.00	POSTMARKED: N/A
	TYPE:	CREDIT CARD	RECEIVED: 08/16/2018
	NAME:	JOEL ADAMS 145 WEST 67TH # 33G NEW YORK NY 10023 US	
	CARD NO:	XXXXXXXXXXXX2270	AUTH CODE: 003908
	NAME ON CARD:	JOEL ADAMS	
	SIGNATURE:		

REMARKS

This receipt was generated by the automated BLM Collections and Billing System and is a paper representation of a portion of the official electronic record contained therein.

DEPARTMENT OF THE INTERIOR
BUREAU OF LAND MANAGEMENT
MINING CLAIMS

Run Date/Time: 9/26/2018

MC Maintenance Fees Paid Through the BLM Pay Portal
(by Date Paid)

Page 2 Of 4

CBS Receipt: 4237278

Printed For Lead File # AMC450979

Agency Tracking ID: 1534423521

Assessment Year: 2019

Number of BLM Serial Nr: 10

Paid On: 8/16/2018

Total Amount Paid: \$1,550.00

Claim Name	BLM Serial No	Lead File No	Amount Paid
EN 89	AMC451004	AMC450979	\$155.00
EN 90	AMC451005	AMC450979	\$155.00
EN 91	AMC451006	AMC450979	\$155.00
EN 139	AMC451026	AMC451026	\$155.00
EN 141	AMC451027	AMC451026	\$155.00
EN 143	AMC451028	AMC451026	\$155.00
EN 145	AMC451029	AMC451026	\$155.00
EN 147	AMC451030	AMC451026	\$155.00
EN 149	AMC451031	AMC451026	\$155.00
EN 97	AMC451342	AMC451342	\$155.00

United States Department of the Interior

Bureau of Land Management
 BUSINESS & SUPPORT SVCS DIV
 ONE N CENTRAL AVE SUITE 800
 PHOENIX, AZ 85004 -4427
 Phone: 602-417-9200

Receipt

No: 4237278

Transaction #: 4352660	
Date of Transaction: 08/16/2018	
CUSTOMER:	
JOEL ADAMS 145 WEST 67TH NEW YORK, NY 10023 US	

LINE #	QTY	DESCRIPTION	REMARKS	UNIT PRICE	TOTAL
1	1.00	LOCATABLE MINERALS / MINING CLAIMS-NOT NEW-UNADJUD, ONE AUTH NO. ONLY / MINING CLAIM MONEY RECEIVED CASES: AMC451004/\$1550.00		- n/a -	1550.00
TOTAL:					\$1,550.00

PAYMENT INFORMATION			
NOTE: Items will appear on credit card statement as "BLM O Mining Claim".			
1	AMOUNT:	1550.00	POSTMARKED: N/A
	TYPE:	CREDIT CARD	RECEIVED: 08/16/2018
	NAME:	JOEL ADAMS 145 WEST 67TH NEW YORK NY 10023 US	
	CARD NO:	XXXXXXXXXXXX2270	AUTH CODE: 033645
	NAME ON CARD:	JOEL ADAMS	
	SIGNATURE:		

REMARKS

This receipt was generated by the automated BLM Collections and Billing System and is a paper representation of a portion of the official electronic record contained therein.

NOTICE!!

These documents have been scanned!

Do not place un-scanned documents beneath this notice!

Do not remove this notice from this file!

GPO Jacket No. 560-102
Print Order 61540
Rise Business Services, LLC
Job=AZ15 7/9/2019



Box Number= AZ15153



Claim Begin-End: AMC450979-AMC451006

5 Miscellaneous



AZ15153-20

AMC449739-AMC451385

May 15, 2018

US Department of the Interior
Bureau of Land Management
1 North Central Avenue
Suite 800
Phoenix, AZ 85004

2018 MAY 22 P 1:23
PHOENIX, ARIZONA

Dear Sir/Madam

Please see enclosed, the documentation, including maps, for sixteen, (16), lode mining claims located on February 23, 2018 and filed and recorded by Mohave County on March 14, 2018 for Pershing Resources Company. All sixteen EN lode mining claims were located, dated and, posted by Nick Barr, acting as agent for Pershing Resources Company.

Also enclosed is a return envelope and a cashier's check to the US Department of the Interior for **\$3392.00** to cover the filing and initial maintenance fees for the sixteen lode mining claims at \$212.00 per claim filed/recorded and, a post-paid return envelope.

The sixteen, (16), EN Lode Mining Claims for BLM recordation are;

EN# 55	EN# 65	EN# 75	EN# 85
EN# 56	EN# 66	EN# 76	EN# 86
EN# 57	EN# 67	EN# 77	EN# 87
EN# 58	EN# 68	EN# 78	EN# 88

Please contact me directly if there is any information that is missing or that requires further explanation.
Thank you for your attention to this matter.

Kind regards,

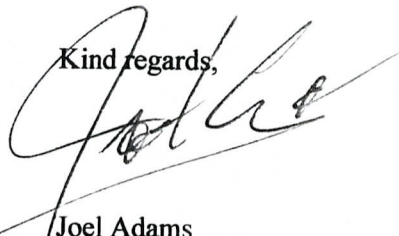

Joel Adams
Chief Operating Officer
Director and Corporate Secretary
Pershing Resources Company
200 South Virginia Street 8th Floor
Reno, Nevada 89501
jadams@pershingpm.com
646 387 6859 (cell)

May 16, 2018

US Department of the Interior
Bureau of Land Management
1 North Central Avenue
Suite 800
Phoenix, AZ 85004

2018 MAY 22 P 1:2
MEENIK, ARIELMA

Dear Sir/Madam

Please see enclosed, the documentation, including maps, for twelve, (12), lode mining claims located on February 23, 2018 and filed and recorded by Mohave County on March 14, 2018 for Pershing Resources Company. All twelve EN lode mining claims were located, dated and, posted by Nick Barr, acting as agent for Pershing Resources Company.

Also enclosed is a return envelope and a cashier's check to the US Department of the Interior for **\$2544.00** to cover the filing and initial maintenance fees for the twelve lode mining claims at \$212.00 per claim filed/recorded and, a post-paid return envelope.

The twelve, (12), EN Lode Mining Claims for BLM recordation are;

EN# 59	EN# 69	EN# 79	EN# 89
EN# 60	EN# 70	EN# 80	EN# 90
EN# 61	EN# 71	EN# 81	EN# 91

Please contact me directly if there is any information that is missing or that requires further explanation. Thank you for your attention to this matter.

Kind regards,

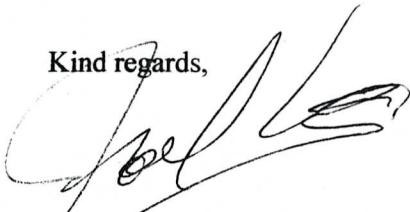

Joel Adams
Chief Operating Officer
Director and Corporate Secretary
Pershing Resources Company
200 South Virginia Street 8th Floor
Reno, Nevada 89501
jadams@pershingpm.com
646 387 6859 (cell)

NOTICE!!

These documents have been scanned!

Do not place un-scanned documents beneath this notice!

Do not remove this notice from this file!

GPO Jacket No. 560-102
Print Order 61540
Rise Business Services, LLC
Job=AZ15 7/9/2019



Box Number= AZ15153



Claim Begin-End: AMC450979-AMC451006

6 Location Notices-Amendments and Supporting Documents



AZ15153-20

AMC449739-AMC451385

MINING CLAIM STATUS REPORT

Data Entered: 5/30/18 RAM

MTP Checked By: 5/30/18 RAM

GEO Checked By: 5/30/18 RAM

LEAD SERIAL NUMBER: AMC 450979 thru AMC 451006

NUMBER OF CLAIMS & TYPE:

28 LODE
PLACER
ASSOCIATION PLACER
MILL SITE
TUNNEL SITE

CHARGES:

Processing Fee @ \$20 = \$ 560
Location Fee @ \$37 = \$ 1,036
Maintenance Fee @ \$155 = \$ 4,340
Add'l Maint Fee for Assoc Placer = \$
SUBTOTAL \$
Other Fees \$
Other Fees \$
TOTAL \$ 5,936

TOTAL ACREAGE: _____ Per Claim
(Placer Only)

NUMBER OF LOCATORS: _____

DOCUMENTS RECEIVED VIA: Over-the-Counter [] Mail [] TIMELY FILED: Yes No []

LEGAL DESCRIPTION: T 20N R 14W SEC 20, 6, 5, 7, 8
T _____ R _____ SEC _____
T _____ R _____ SEC _____
T _____ R _____ SEC _____
T _____ R _____ SEC _____

BLM [] FOREST SERVICE [] SUBJ TO PL 359: Yes [] No []
WILDERNESS AREA []

SPLIT ESTATE: N/A [] SX [] PX [] OTHER []
SRHA [] Was proper Notice filed if located on SHRA Land? Yes [] No []

RECONVEYED MINERALS ON BLM LAND REQUIRE OPENING ORDER FROM 1944 TO 1993:

Open to Entry On _____ N/A []

COMMENTS/STATUS: VOID [] PARTIALLY VOID [] PVT MINERALS [] WITHDRAWN LANDS []
OTHER []

AMC450979

[] Claimant acknowledges that portions of the following claim(s) site(s) may be void or voidable.

Printed Name of Claimant _____

Signature of Claimant _____

*****FINAL ADJUDICATION*****

DATE _____ INITIALS _____

2

FEE# 2018012441

OFFICIAL RECORDS OF MOHAVE COUNTY KRISTI BLAIR, COUNTY RECORDER



03/14/2018 11:36 AM Fee: \$10.00

PAGE: 1 of 2

After recording return to: Pershing Resources 200 S. Virginia St. 8th Floor Reno, Nevada 89501

LOCATION NOTICE FOR LODE MINING CLAIM

Amendment BLM Serial #

NOTICE IS HEREBY GIVEN that the EN# 55 lode mining claim has been located by Nicholas BARR (agent) whose current mailing address is 5441 E. Mining Camp St. Apache Junction, AZ 85119

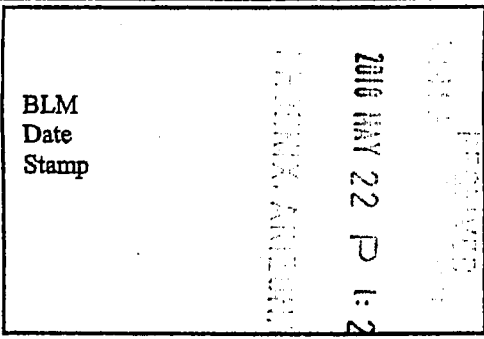

The general course of this claim is N-S and it is situated in Mohave County, Arizona. This claim is 1500 feet in length and 600 feet in width.

20 Total Claim Acreage. This claim runs from the location monument on which this location notice is posted on the centerline of the claim approximately 20 feet in a S direction to the S end line and 1480 feet in a N direction to the N end line. This claim is marked by six monuments, one at each corner and one at the center of each end line of the claim.

The location monument on which this notice is posted is situated within Section 6, Township 20 N, Range 14 W, Gila Salt River Base and Meridian, Arizona and this claim encompasses portions of the following quarter section(s), section(s), Township(s) and Range(s) NW 1/4 Section 6 T. 20 N., R. 14 W.

Gila Salt River Base and Meridian, Arizona.

The locality of this claim with reference to some natural object or permanent monument and additional information (if any) concerning its locality are as follows: The NW CORNER of claim is located 900 ft. EAST and 0 ft. NORTH of survey monument located at NE Corner Section 1, T. 20 N., R. 15 W. GSRB & M. The above information is shown on the attached map.

DATED AND POSTED on the ground this 23 day of February, 2018.

LOCATOR(s) AGENT

Print Name(s) Nicholas Barr Signature(s) Nicholas Barr

(Agent for Pershing Resources) Form MCF100

AHCH50979

R. 15 W.
R. 14 W.

MINING CLAIM MAP

Lode (X) Placer ()
Millsite ()

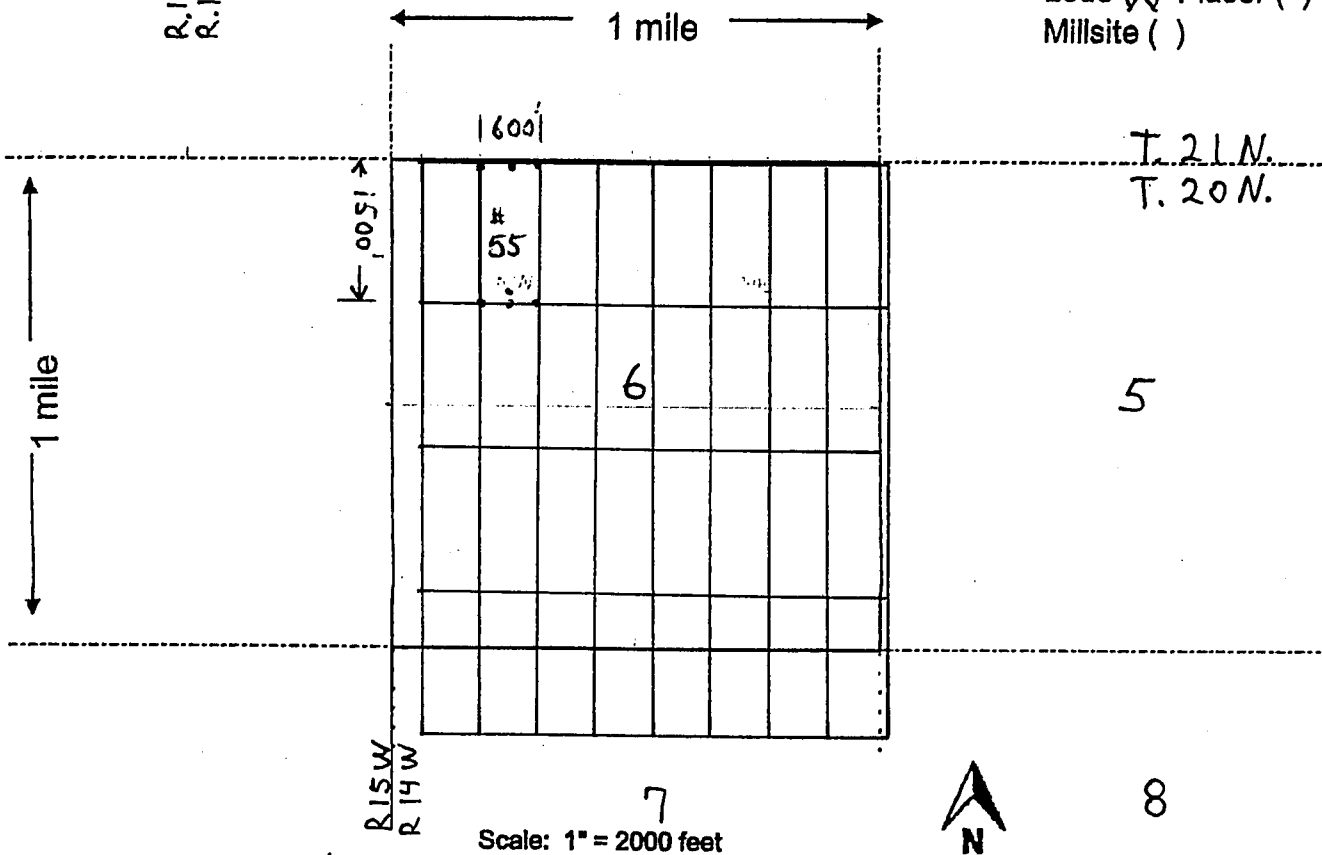

1. The above map depicts the EN # 55 mining claim, which is located in Section (s) 6, Township 20 N, Range 14 W, Gila and Salt River Base and Meridian, Mohave County, Arizona. Total claim acreage is 20 acres

2. The type of corner and location monuments used are as follows: 2" x 2" x 4 ft wood posts

3. The bearings and distances in degrees and feet between claim corners and to a public land survey monument are as depicted on the map.

4. If the claim is a placer or millsite claim with exterior limits conforming to legal subdivisions of the public survey, provide a legal description of the claim _____

Form MCF100a
Revised July 2014

2

FEE# 2018012442

OFFICIAL RECORDS OF MOHAVE COUNTY KRISTI BLAIR, COUNTY RECORDER



03/14/2018 11:36 AM Fee: \$10.00

PAGE: 1 of 2

After recording return to: Pershing Resources 200 S. Virginia St. 8th Floor Reno, Nevada 89501

LOCATION NOTICE FOR LODE MINING CLAIM

Amendment BLM Serial #

NOTICE IS HEREBY GIVEN that the EN# 56 lode mining claim has been located by Nicholas BARR (agent) whose current mailing address is 5441 E. Mining Camp St. Apache Junction, AZ 85119

BLM Date Stamp 2018 MAY 22 P 1:23

The general course of this claim is N-S and it is situated in Mohave County, Arizona. This claim is 1500 feet in length and 600 feet in width.

20 Total Claim Acreage. This claim runs from the location monument on which this location notice is posted on the centerline of the claim approximately 20 feet in a S direction to the S end line and 1480 feet in a N direction to the N end line. This claim is marked by six monuments, one at each corner and one at the center of each end line of the claim.

The location monument on which this notice is posted is situated within Section 6, Township 20 N, Range 14 W, Gila Salt River Base and Meridian, Arizona and this claim encompasses portions of the following quarter section(s), section(s), Township(s) and Range(s) NW 1/4 Section 6 T. 20 N., R. 14 W.

Gila Salt River Base and Meridian, Arizona.

The locality of this claim with reference to some natural object or permanent monument and additional information (if any) concerning its locality are as follows: The NW CORNER of claim is located 1500 ft. EAST and 0 ft. NORTH of survey monument located at NE Corner Section 1, T. 20 N., R. 15 W., GSRB & M. The above information is shown on the attached map.

DATED AND POSTED on the ground this 23 day of February, 2018.

LOCATOR(s) AGENT

Print Name(s) Nicholas Barr

Signature(s) Nicholas Barr (Agent for Pershing Resources) Form MCF100

AHC450980

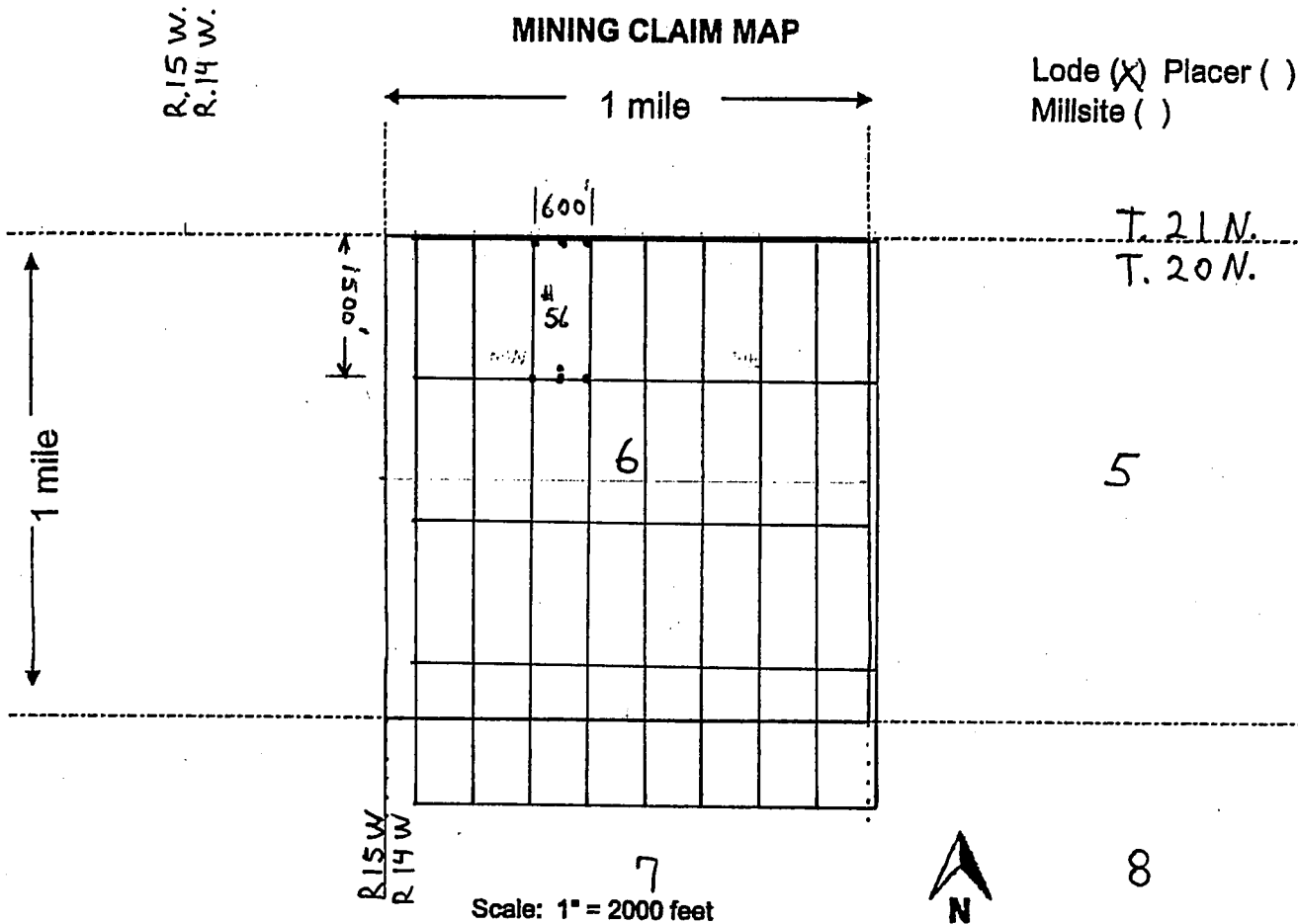

1. The above map depicts the EN # 56 mining claim, which is located in Section (s) 6, Township 20 N, Range 14 W, Gila and Salt River Base and Meridian, Mohave County, Arizona. Total claim acreage is 20 acres
2. The type of corner and location monuments used are as follows: 2" x 2" x 4 ft wood posts
3. The bearings and distances in degrees and feet between claim corners and to a public land survey monument are as depicted on the map.
4. If the claim is a placer or millsite claim with exterior limits conforming to legal subdivisions of the public survey, provide a legal description of the claim _____

Form MCF100a
Revised July 2014

FEE# 2018012443

OFFICIAL RECORDS OF MOHAVE COUNTY KRISTI BLAIR, COUNTY RECORDER



03/14/2018 11:36 AM Fee: \$10.00

PAGE: 1 of 2

After recording return to: Pershing Resources 200 S. Virginia St. 8th Floor Reno, Nevada 89501

LOCATION NOTICE FOR LODE MINING CLAIM

Amendment BLM Serial #

NOTICE IS HEREBY GIVEN that the EN# 57 lode mining claim has been located by Nicholas BARR (agent) whose current mailing address is 5441 E. Mining Camp St. Apache Junction, AZ 85119

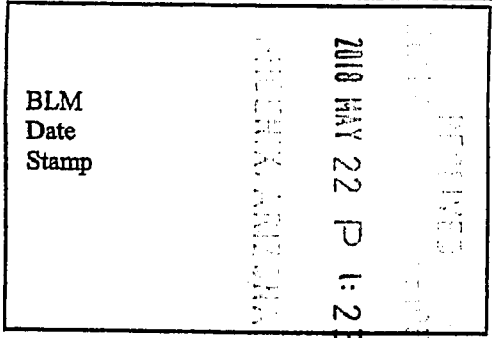

The general course of this claim is N-S and it is situated in Mohave County, Arizona. This claim is 1500 feet in length and 600 feet in width.

20 Total Claim Acreage. This claim runs from the location monument on which this location notice is posted on the centerline of the claim approximately 20 feet in a S direction to the S end line and 1480 feet in a N direction to the N end line. This claim is marked by six monuments, one at each corner and one at the center of each end line of the claim.

The location monument on which this notice is posted is situated within Section 6, Township 20 N, Range 14 W, Gila Salt River Base and Meridian, Arizona and this claim encompasses portions of the following quarter section(s), section(s), Township(s) and Range(s) NE & NW 1/4 Section 6 T. 20 N., R. 14 W.

Gila Salt River Base and Meridian, Arizona.

The locality of this claim with reference to some natural object or permanent monument and additional information (if any) concerning its locality are as follows: The NW CORNER of claim is located 2100 ft EAST and 0 ft NORTH of survey monument located at NE Corner Section 1, T. 20 N., R. 15 W., GSRB & M. The above information is shown on the attached map.

DATED AND POSTED on the ground this 23 day of February, 2018.

LOCATOR(s) AGENT

Print Name(s) Nicholas Barr

Signature(s) Nicholas Barr

(Agent for Pershing Resources) Form MCF100

AHCH450981

MINING CLAIM MAP

Lode (X) Placer ()
Millsite ()

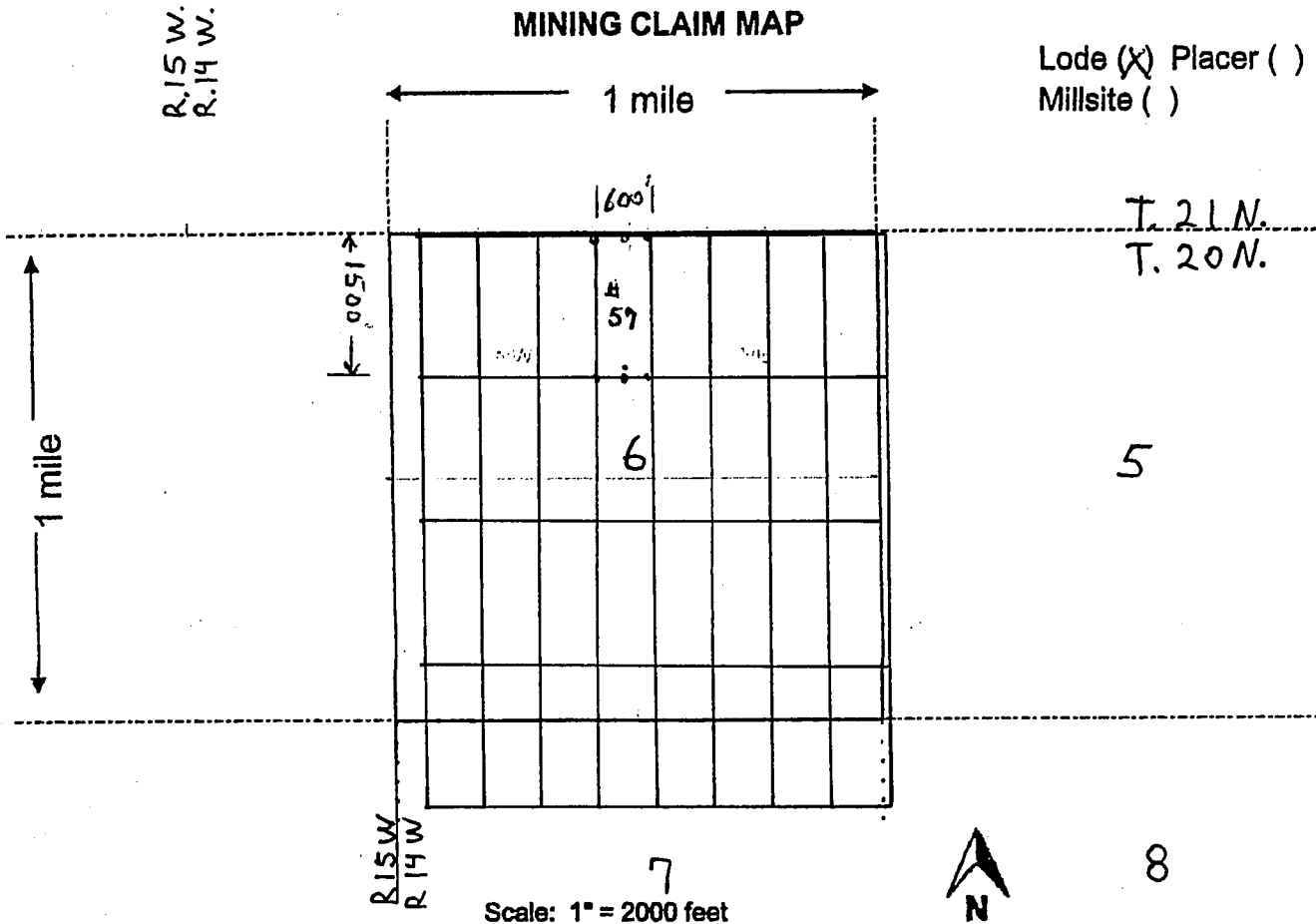

Scale: 1" = 2000 feet

1. The above map depicts the EN # 57 mining claim, which is located in Section (s) 6, Township 20 N, Range 14 W, Gila and Salt River Base and Meridian, Mohave County, Arizona. Total claim acreage is 20 acres

2. The type of corner and location monuments used are as follows: 2" x 2" x 4 ft wood posts

3. The bearings and distances in degrees and feet between claim corners and to a public land survey monument are as depicted on the map.

4. If the claim is a placer or millsite claim with exterior limits conforming to legal subdivisions of the public survey, provide a legal description of the claim _____

Form MCF100a
Revised July 2014

2

FEE# 2018012444

OFFICIAL RECORDS OF MOHAVE COUNTY KRISTI BLAIR, COUNTY RECORDER



03/14/2018 11:36 AM Fee: \$10.00

PAGE: 1 of 2

After recording return to: Pershing Resources 200 S. Virginia St. 8th Floor Reno, Nevada 89501

LOCATION NOTICE FOR LODE MINING CLAIM

Amendment BLM Serial#

NOTICE IS HEREBY GIVEN that the EN# 58 lode mining claim has been located

by Nicholas BARR (agent) whose current mailing address is 5441 E. Mining Camp St. Apache Junction, AZ 85119

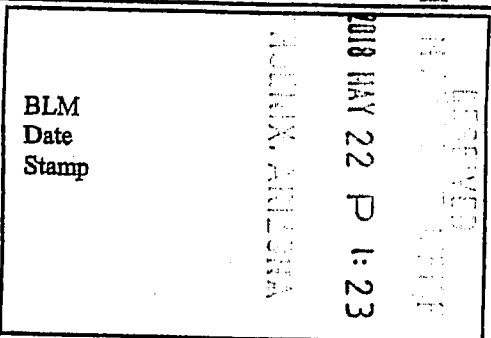

The general course of this claim is N-S and it is situated in Mohave County, Arizona. This claim is 1500 feet in length and 600 feet in width.

20 Total Claim Acreage. This claim runs from the location monument on which this location notice is posted on the centerline of the claim approximately 20 feet in a S direction to the S end line and 1480 feet in a N direction to the N end line. This claim is marked by six monuments, one at each corner and one at the center of each end line of the claim.

The location monument on which this notice is posted is situated within Section 6, Township 20 N, Range 14 W, Gila Salt River Base and Meridian, Arizona and this claim encompasses portions of the following quarter section(s), section(s), Township(s) and Range(s) NE 1/4 Section 6 T. 20 N., R. 14 W.

Gila Salt River Base and Meridian, Arizona.

The locality of this claim with reference to some natural object or permanent monument and additional information (if any) concerning its locality are as follows: The NW CORNER of claim is located 2700 ft. EAST and 0 ft. NORTH of survey monument located at NE Corner Section 1, T. 20 N., R. 15 W., GSRB & M. The above information is shown on the attached map.

DATED AND POSTED on the ground this 23 day of February, 2018.

LOCATOR(s) AGENT

Print Name(s) Nicholas Barr

Signature(s) Nicholas Barr

(Agent for Pershing Resources) Form MCF100

ANCH 50982

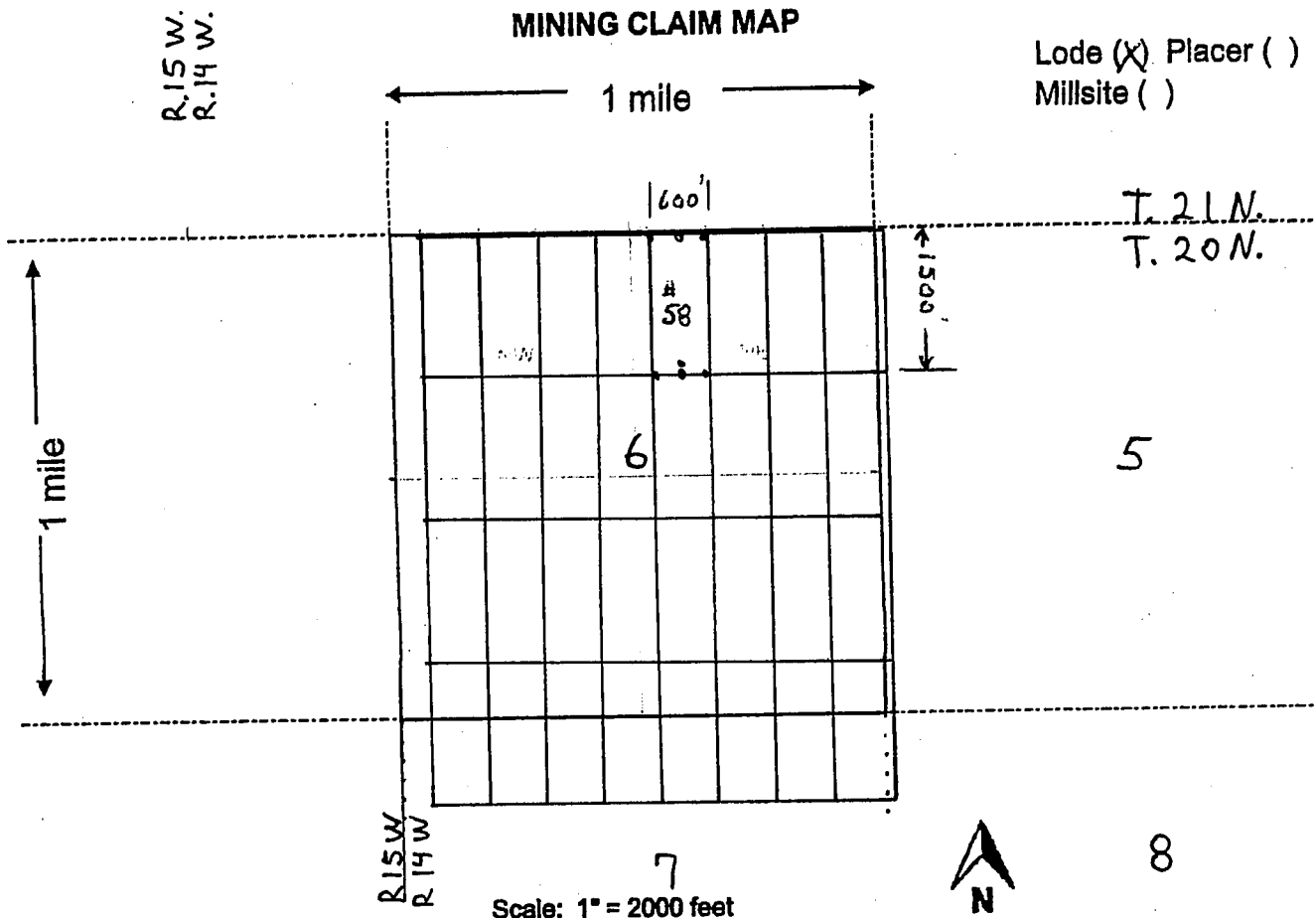

1. The above map depicts the EN # 58 mining claim, which is located in Section (s) 6, Township 20 N, Range 14 W, Gila and Salt River Base and Meridian, Mohave County, Arizona. Total claim acreage is 20 acres
2. The type of corner and location monuments used are as follows: 2" x 2" x 4 ft wood posts
3. The bearings and distances in degrees and feet between claim corners and to a public land survey monument are as depicted on the map.
4. If the claim is a placer or millsite claim with exterior limits conforming to legal subdivisions of the public survey, provide a legal description of the claim _____

Form MCF100a
Revised July 2014

2



FEE# 2018012445

OFFICIAL RECORDS OF MOHAVE COUNTY KRISTI BLAIR, COUNTY RECORDER

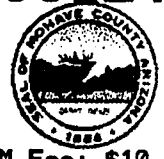

03/14/2018 11:36 AM Fee: \$10.00

PAGE: 1 of 2

After recording return to: Pershing Resources 200 S. Virginia St. 8th Floor Reno, Nevada 89501

LOCATION NOTICE FOR LODE MINING CLAIM

Amendment BLM Serial #

NOTICE IS HEREBY GIVEN that the EN# 59 lode mining claim has been located by Nicholas BARR (agent) whose current mailing address is 5441 E. Mining Camp St. Apache Junction, AZ 85119

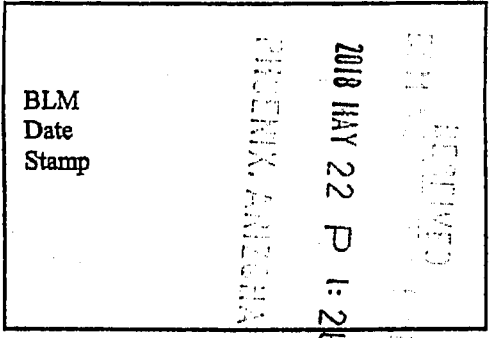

The general course of this claim is N-S and it is situated in Mohave County, Arizona. This claim is 1500 feet in length and 600 feet in width.

20 Total Claim Acreage. This claim runs from the location monument on which this location notice is posted on the centerline of the claim approximately 20 feet in a S direction to the S end line and 1480 feet in a N direction to the N end line. This claim is marked by six monuments, one at each corner and one at the center of each end line of the claim.

The location monument on which this notice is posted is situated within Section 6, Township 20 N, Range 14 W, Gila Salt River Base and Meridian, Arizona and this claim encompasses portions of the following quarter section(s), section(s), Township(s) and Range(s) NE 1/4 Section 6 T. 20 N., R. 14 W.

Gila Salt River Base and Meridian, Arizona.

The locality of this claim with reference to some natural object or permanent monument and additional information (if any) concerning its locality are as follows: The NW CORNER of claim is located 3300 ft. EAST and 0 ft. NORTH of survey monument located at NE Corner Section 1, T. 20 N., R. 15 W., GSRB & M. The above information is shown on the attached map.

DATED AND POSTED on the ground this 23 day of February, 2018.

LOCATOR(s) AGENT

Print Name(s) Nicholas Barr

Signature(s) Nicholas Barr

(Agent for Pershing Resources) Form MCF100

AHC450983

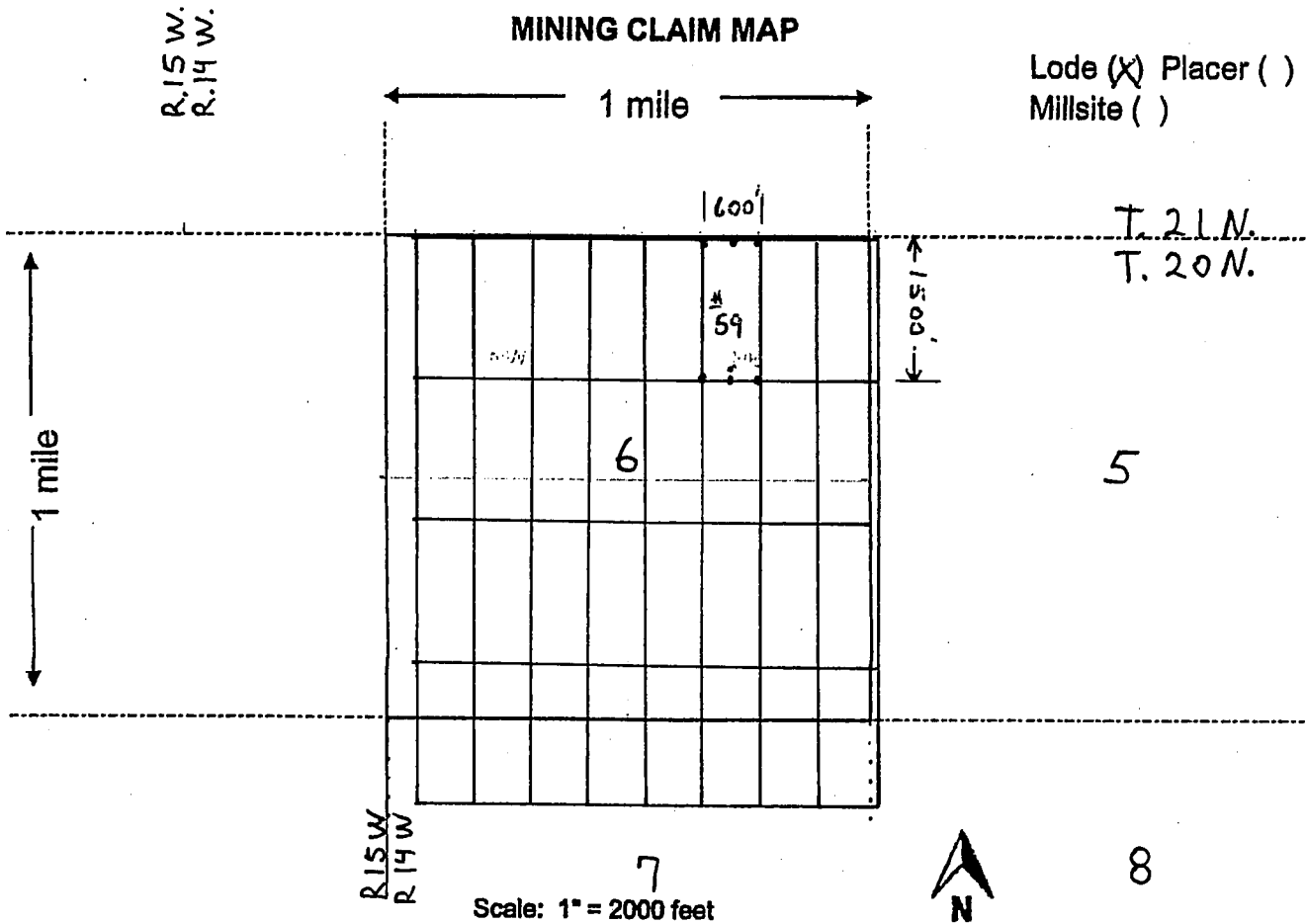

1. The above map depicts the EN # 59 mining claim, which is located in Section (s) 6, Township 20 N, Range 14 W, Gila and Salt River Base and Meridian, Mohave County, Arizona. Total claim acreage is 20 acres

2. The type of corner and location monuments used are as follows: 2" x 2" x 4 ft wood posts

3. The bearings and distances in degrees and feet between claim corners and to a public land survey monument are as depicted on the map.

4. If the claim is a placer or millsite claim with exterior limits conforming to legal subdivisions of the public survey, provide a legal description of the claim _____

2

FEE# 2018012446

OFFICIAL RECORDS OF MOHAVE COUNTY KRISTI BLAIR, COUNTY RECORDER



03/14/2018 11:36 AM Fee: \$10.00

PAGE: 1 of 2

After recording return to: Pershing Resources 200 S. Virginia St. 8th Floor Reno, Nevada 89501

LOCATION NOTICE FOR LODE MINING CLAIM

Amendment BLM Serial #

NOTICE IS HEREBY GIVEN that the EN# 60 lode mining claim has been located by Nicholas BARR (agent) whose current mailing address is 5441 E. Mining Camp St. Apache Junction, AZ 85119

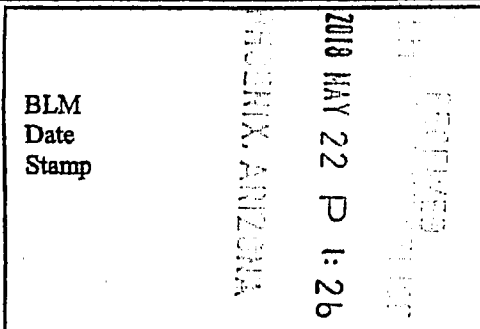

The general course of this claim is N-S and it is situated in Mohave County, Arizona. This claim is 1500 feet in length and 600 feet in width.

20 Total Claim Acreage. This claim runs from the location monument on which this location notice is posted on the centerline of the claim approximately 20 feet in a S direction to the S end line and 1480 feet in a N direction to the N end line. This claim is marked by six monuments, one at each corner and one at the center of each end line of the claim.

The location monument on which this notice is posted is situated within Section 6, Township 20 N, Range 14 W, Gila Salt River Base and Meridian, Arizona and this claim encompasses portions of the following quarter section(s), section(s), Township(s) and Range(s) NE 1/4 Section 6 T. 20 N., R. 14 W.

Gila Salt River Base and Meridian, Arizona.

The locality of this claim with reference to some natural object or permanent monument and additional information (if any) concerning its locality are as follows: The NW CORNER of claim is located 3900 ft EAST and 0 ft NORTH of survey monument located at NE Corner Section 1, T. 20 N., R. 15 W., GSRB & M. The above information is shown on the attached map.

DATED AND POSTED on the ground this 23 day of February, 2018.

LOCATOR(s) AGENT

Print Name(s) Nicholas Barr Signature(s) Nicholas Barr

(Agent for Pershing Resources) Form MCF100

AHC450984

MINING CLAIM MAP

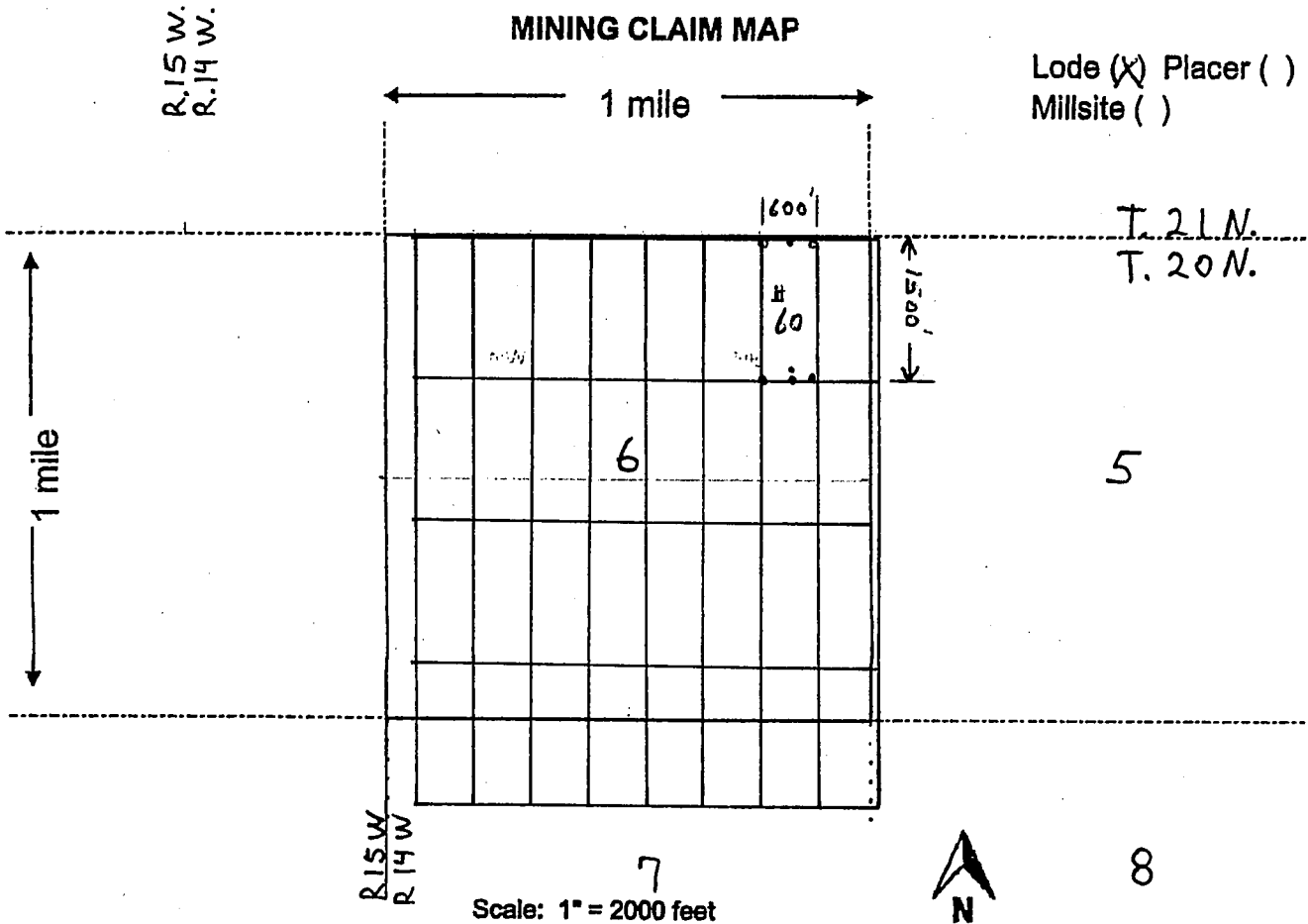

1. The above map depicts the EN # 60 mining claim, which is located in Section (s) 6, Township 20 N, Range 14 W, Gila and Salt River Base and Meridian, Mohave County, Arizona. Total claim acreage is 20 acres

2. The type of corner and location monuments used are as follows: 2" x 2" x 4 ft wood posts

3. The bearings and distances in degrees and feet between claim corners and to a public land survey monument are as depicted on the map.

4. If the claim is a placer or millsite claim with exterior limits conforming to legal subdivisions of the public survey, provide a legal description of the claim _____

FEE# 2018012447

OFFICIAL RECORDS OF MOHAVE COUNTY KRISTI BLAIR, COUNTY RECORDER



03/14/2018 11:36 AM Fee: \$10.00

PAGE: 1 of 2

After recording return to: Pershing Resources 200 S. Virginia St. 8th Floor Reno, Nevada 89501

LOCATION NOTICE FOR LODE MINING CLAIM

Amendment BLM Serial #

NOTICE IS HEREBY GIVEN that the EN# 61 lode mining claim has been located by Nicholas BARR (agent) whose current mailing address is 5441 E. Mining Camp St. Apache Junction, AZ 85119

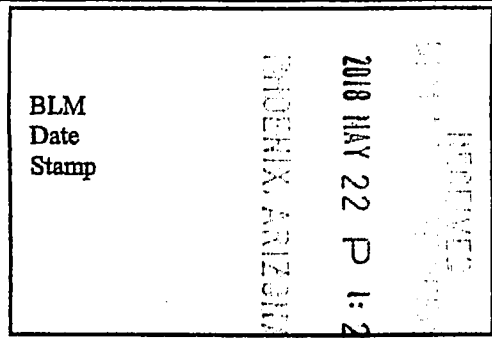

The general course of this claim is N-S and it is situated in Mohave County, Arizona. This claim is 1500 feet in length and 600 feet in width.

20 Total Claim Acreage. This claim runs from the location monument on which this location notice is posted on the centerline of the claim approximately 20 feet in a S direction to the S end line and 1480 feet in a N direction to the N end line. This claim is marked by six monuments, one at each corner and one at the center of each end line of the claim.

The location monument on which this notice is posted is situated within Section 6, Township 20 N, Range 14 W, Gila Salt River Base and Meridian, Arizona and this claim encompasses portions of the following quarter section(s), section(s), Township(s) and Range(s) NE 1/4 Section 6 T. 20 N., R. 14 W., NW 1/4 Section 5 T. 20 N., R. 14 W.

Gila Salt River Base and Meridian, Arizona.

The locality of this claim with reference to some natural object or permanent monument and additional information (if any) concerning its locality are as follows: The NW CORNER of claim is located 4500 ft. EAST and 0 ft. NORTH of survey monument located at NE Corner Section 1, T. 20 N., R. 15 W., GSRB & M. The above information is shown on the attached map.

DATED AND POSTED on the ground this 23 day of February, 2018.

LOCATOR(s) AGENT

Print Name(s) Nicholas Barr

Signature(s) Nicholas Barr

(Agent for Pershing Resources) Form MCF100

AH0450985

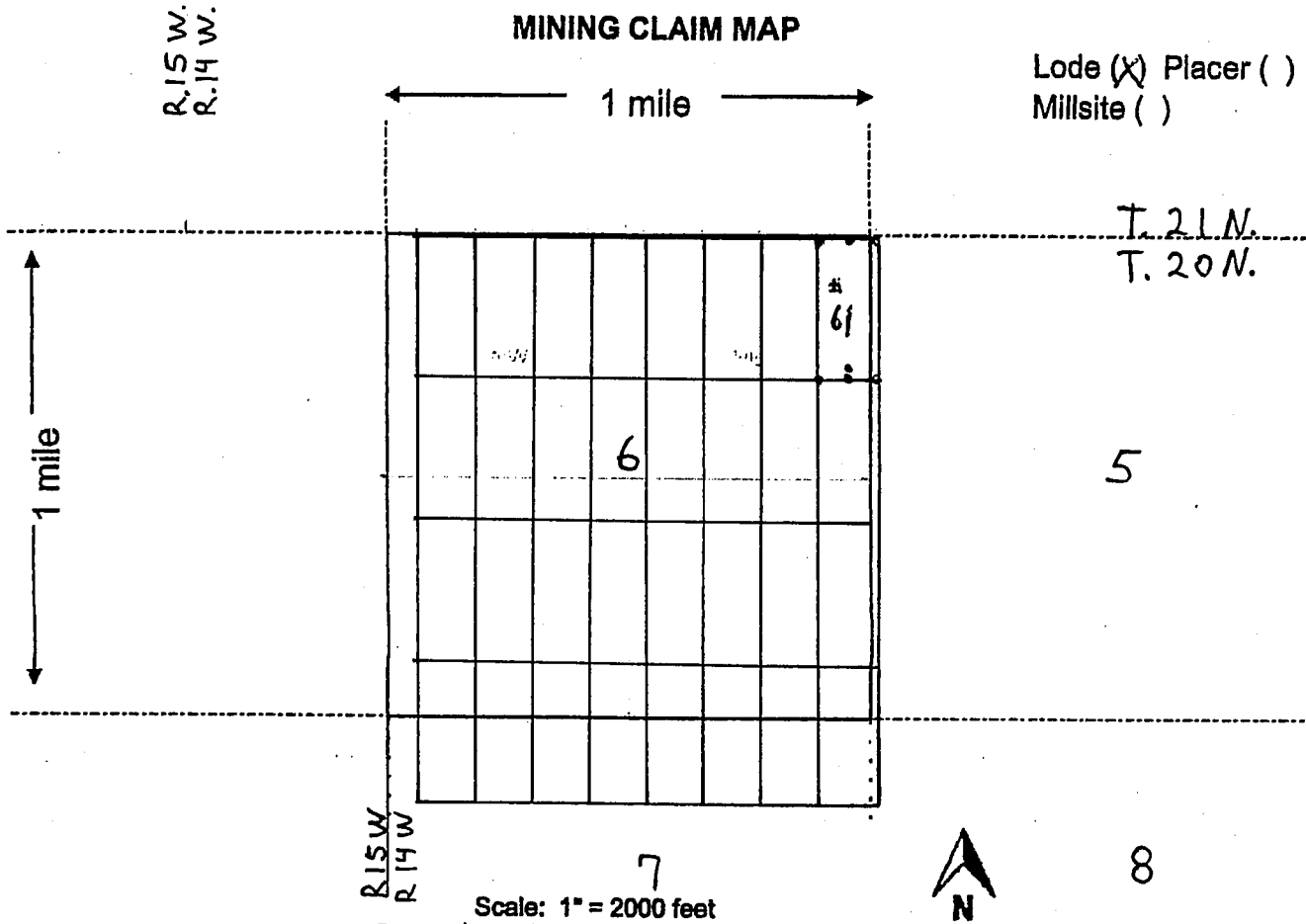

1. The above map depicts the EN # 61 mining claim, which is located in Section (s) 5 & 6, Township 20 N, Range 14 W, Gila and Salt River Base and Meridian, Mohave County, Arizona. Total claim acreage is 20 acres

2. The type of corner and location monuments used are as follows: 2" x 2" x 4 ft wood posts

3. The bearings and distances in degrees and feet between claim corners and to a public land survey monument are as depicted on the map.

4. If the claim is a placer or millsite claim with exterior limits conforming to legal subdivisions of the public survey, provide a legal description of the claim _____

FEE# 2018012451

OFFICIAL RECORDS OF MOHAVE COUNTY KRISTI BLAIR, COUNTY RECORDER



03/14/2018 11:36 AM Fee: \$10.00

PAGE: 1 of 2

After recording return to: Pershing Resources 200 S. Virginia St. 8th Floor Reno, Nevada 89501

LOCATION NOTICE FOR LODE MINING CLAIM

Amendment BLM Serial #

NOTICE IS HEREBY GIVEN that the EN# 65 lode mining claim has been located by Nicholas BARR (agent) whose current mailing address is 5441 E. Mining Camp St. Apache Junction, AZ 85119

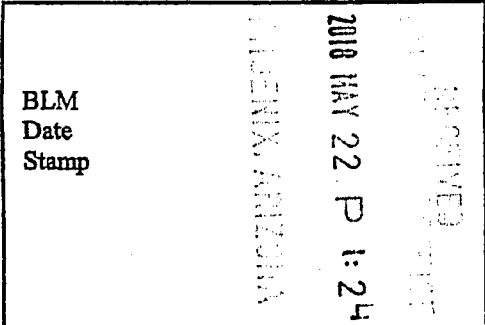

The general course of this claim is N-S and it is situated in Mohave County, Arizona. This claim is 1500 feet in length and 600 feet in width.

20 Total Claim Acreage. This claim runs from the location monument on which this location notice is posted on the centerline of the claim approximately 20 feet in a N direction to the N end line and 1480 feet in a S direction to the S end line. This claim is marked by six monuments, one at each corner and one at the center of each end line of the claim.

The location monument on which this notice is posted is situated within Section 6, Township 20 N, Range 14 W, Gila Salt River Base and Meridian, Arizona and this claim encompasses portions of the following quarter section(s), section(s), Township(s) and Range(s) NW 1/4 Section 6 T. 20 N., R. 14 W.

Gila Salt River Base and Meridian, Arizona.

The locality of this claim with reference to some natural object or permanent monument and additional information (if any) concerning its locality are as follows: The NW CORNER of claim is located 900 ft. EAST and 1500 ft. SOUTH of survey monument located at NE Corner Section 1, T. 20 N., R. 15 W., GSRB & M. The above information is shown on the attached map.

DATED AND POSTED on the ground this 23 day of February, 2018.

LOCATOR(s) AGENT

Print Name(s) Nicholas Barr

Signature(s) Nicholas Barr

(Agent for Pershing Resources) Form MCF100

AHC 450986

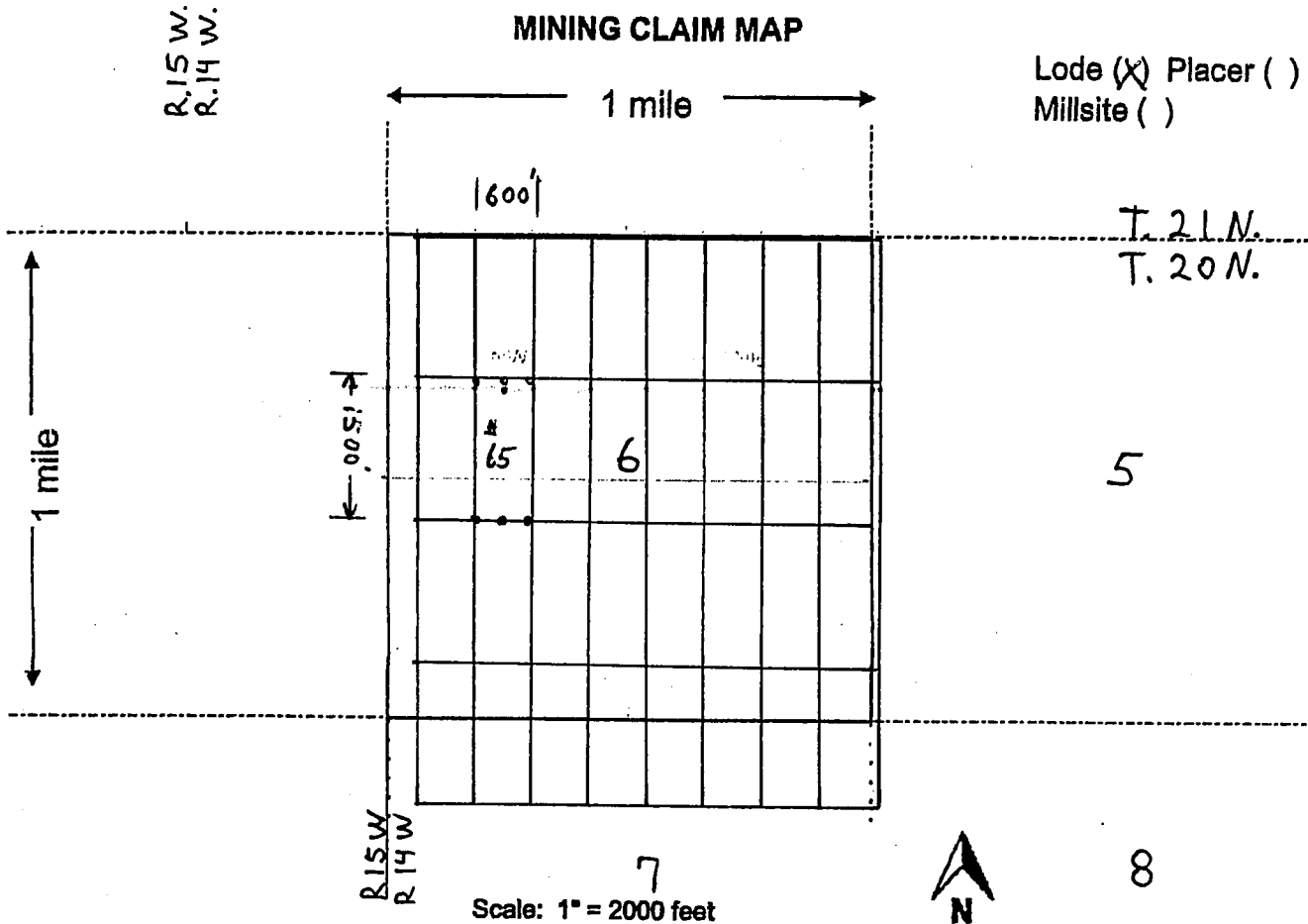

1. The above map depicts the EN # 65 mining claim, which is located in Section (s) 6, Township 20 N, Range 14 W, Gila and Salt River Base and Meridian, Mohave County, Arizona. Total claim acreage is 20 acres

2. The type of corner and location monuments used are as follows: 2" x 2" x 4 ft wood posts

3. The bearings and distances in degrees and feet between claim corners and to a public land survey monument are as depicted on the map.

4. If the claim is a placer or millsite claim with exterior limits conforming to legal subdivisions of the public survey, provide a legal description of the claim _____

2

FEE# 2018012452

OFFICIAL RECORDS OF MOHAVE COUNTY KRISTI BLAIR, COUNTY RECORDER



03/14/2018 11:36 AM Fee: \$10.00

PAGE: 1 of 2

After recording return to: Pershing Resources 200 S. Virginia St. 8th Floor Reno, Nevada 89501

LOCATION NOTICE FOR LODE MINING CLAIM

Amendment BLM Serial #

NOTICE IS HEREBY GIVEN that the EN# 66 lode mining claim has been located by Nicholas BARR (agent) whose current mailing address is 5441 E. Mining Camp St. Apache Junction, AZ 85119

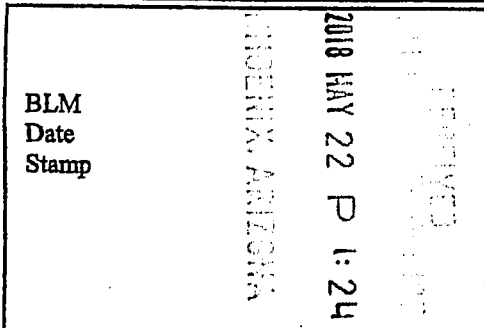

The general course of this claim is N-S and it is situated in Mohave County, Arizona. This claim is 1500 feet in length and 600 feet in width.

20 Total Claim Acreage. This claim runs from the location monument on which this location notice is posted on the centerline of the claim approximately 20 feet in a N direction to the N end line and 1480 feet in a S direction to the S end line. This claim is marked by six monuments, one at each corner and one at the center of each end line of the claim.

The location monument on which this notice is posted is situated within Section 6, Township 20 N, Range 14 W, Gila Salt River Base and Meridian, Arizona and this claim encompasses portions of the following quarter section(s), section(s), Township(s) and Range(s) NW & SW 1/4 Section 6 T. 20 N., R. 14 W.

Gila Salt River Base and Meridian, Arizona.

The locality of this claim with reference to some natural object or permanent monument and additional information (if any) concerning its locality are as follows: The NW CORNER of claim is located 1500 ft. EAST and 1500 ft. SOUTH of survey monument located at NE Corner Section 1, T. 20 N., R. 15 W., GSRBM. The above information is shown on the attached map.

DATED AND POSTED on the ground this 23 day of February, 2018.

LOCATOR(s) AGENT

Print Name(s) Nicholas Barr

Signature(s) Nicholas Barr

(Agent for Pershing Resources) Form MCF100

AHC450987

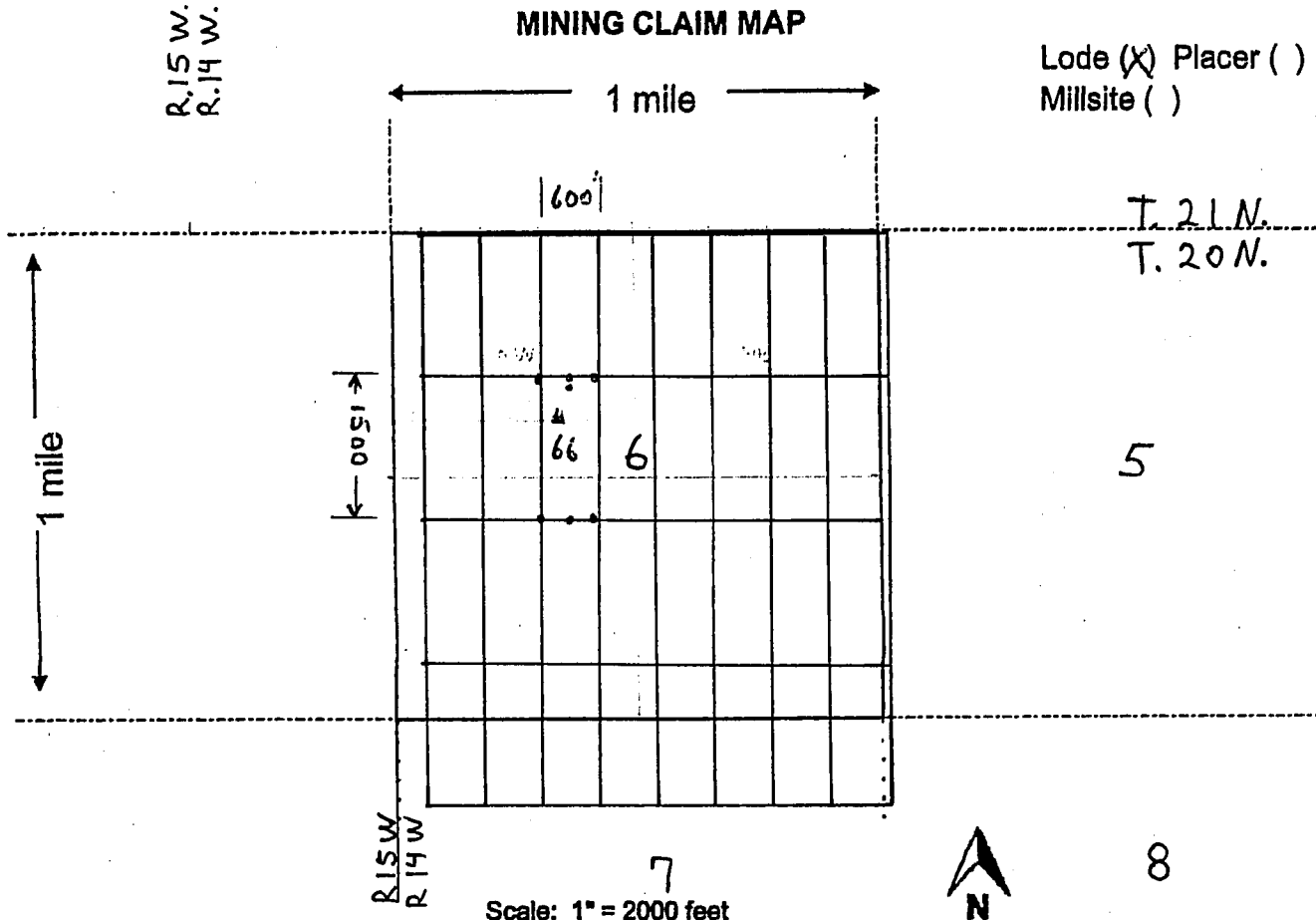

1. The above map depicts the EN # 66 mining claim, which is located in Section (s) 6, Township 20 N, Range 14 W, Gila and Salt River Base and Meridian, Mohave County, Arizona. Total claim acreage is 20 acres
2. The type of corner and location monuments used are as follows: 2" x 2" x 4 ft wood posts
3. The bearings and distances in degrees and feet between claim corners and to a public land survey monument are as depicted on the map.
4. If the claim is a placer or millsite claim with exterior limits conforming to legal subdivisions of the public survey, provide a legal description of the claim _____

Form MCF100a
Revised July 2014

FEE# 2018012453

OFFICIAL RECORDS OF MOHAVE COUNTY KRISTI BLAIR, COUNTY RECORDER



03/14/2018 11:36 AM Fee: \$10.00

PAGE: 1 of 2

After recording return to: Pershing Resources 200 S. Virginia St. 8th Floor Reno, Nevada 89501

LOCATION NOTICE FOR LODE MINING CLAIM

Amendment BLM Serial #

NOTICE IS HEREBY GIVEN that the EN# 67 lode mining claim has been located by Nicholas BARR (agent) whose current mailing address is 5441 E. Mining Camp St. Apache Junction, AZ 85119

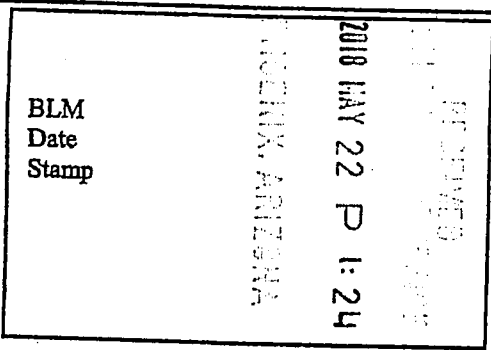

The general course of this claim is N-S and it is situated in Mohave County, Arizona. This claim is 1500 feet in length and 600 feet in width.

20 Total Claim Acreage. This claim runs from the location monument on which this location notice is posted on the centerline of the claim approximately 20 feet in a N direction to the N end line and 1480 feet in a S direction to the S end line. This claim is marked by six monuments, one at each corner and one at the center of each end line of the claim.

The location monument on which this notice is posted is situated within Section 6, Township 20 N, Range 14 W, Gila Salt River Base and Meridian, Arizona and this claim encompasses portions of the following quarter section(s), section(s), Township(s) and Range(s) NW, SW, NE, & NW 1/4 Sec. 6 T. 20 N., R. 14 W.

Gila Salt River Base and Meridian, Arizona.

The locality of this claim with reference to some natural object or permanent monument and additional information (if any) concerning its locality are as follows: The NW CORNER of claim is located 2100 ft. EAST and 1500 ft. SOUTH of survey monument located at NE Corner Section 1, T. 20 N., R. 15 W., GSRB & M. The above information is shown on the attached map.

DATED AND POSTED on the ground this 23 day of February, 2018.

LOCATOR(s) AGENT

Print Name(s) Nicholas Barr Signature(s) Nicholas Barr (Agent for Pershing Resources) Form MCF100

AMC450988

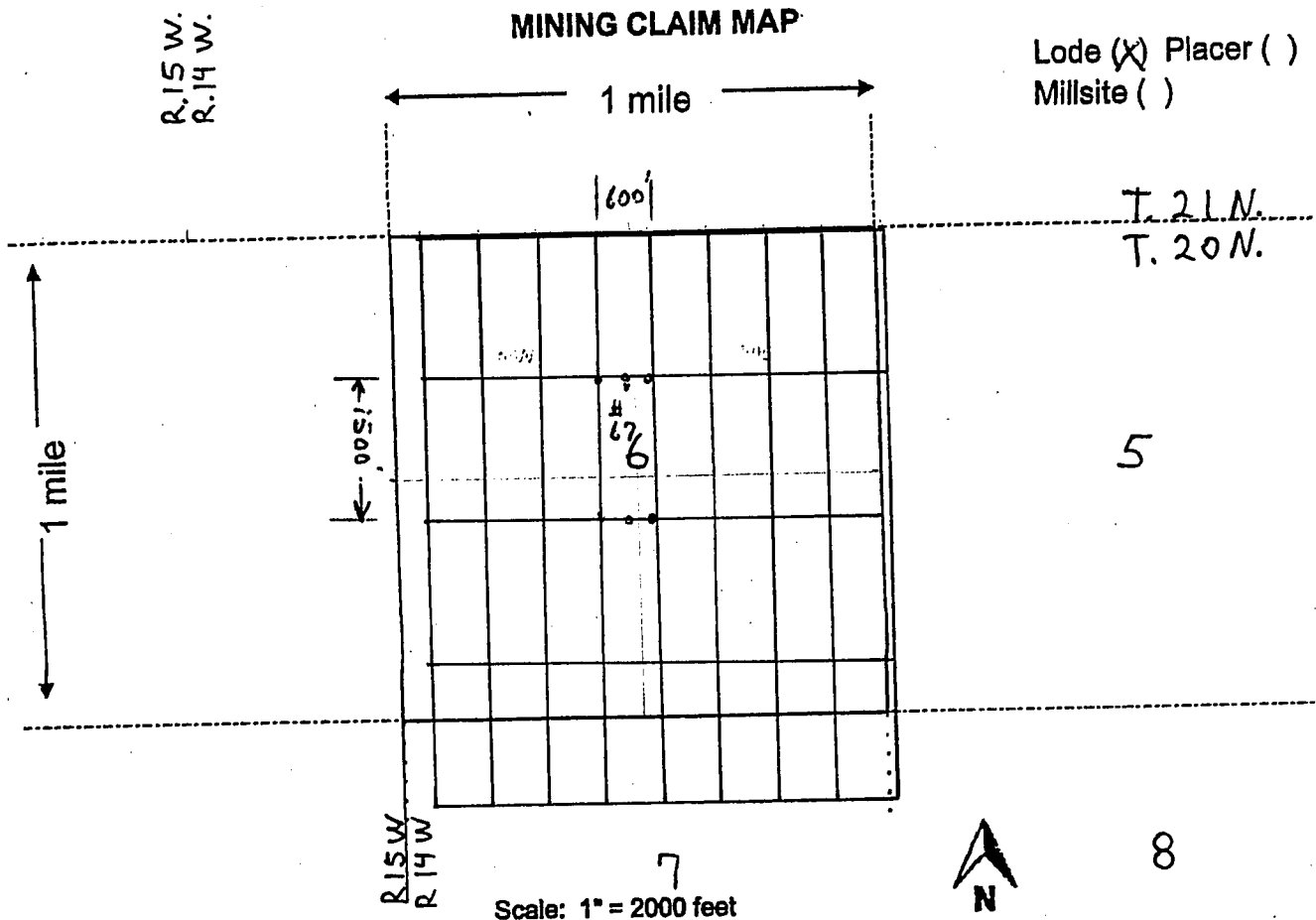

1. The above map depicts the EN # 67 mining claim, which is located in Section (s) 6, Township 20 N, Range 14 W, Gila and Salt River Base and Meridian, Mohave County, Arizona. Total claim acreage is 20 acres
2. The type of corner and location monuments used are as follows: 2" x 2" x 4 ft wood posts
3. The bearings and distances in degrees and feet between claim corners and to a public land survey monument are as depicted on the map.
4. If the claim is a placer or millsite claim with exterior limits conforming to legal subdivisions of the public survey, provide a legal description of the claim _____

Form MCF100a
Revised July 2014

2

FEE# 2018012454

OFFICIAL RECORDS OF MOHAVE COUNTY KRISTI BLAIR, COUNTY RECORDER



03/14/2018 11:36 AM Fee: \$10.00

PAGE: 1 of 2

After recording return to: Pershing Resources 200 S. Virginia St. 8th Floor Reno, Nevada 89501

LOCATION NOTICE FOR LODE MINING CLAIM

Amendment BLM Serial #

NOTICE IS HEREBY GIVEN that the EN# 68 lode mining claim has been located by Nicholas BARR (agent) whose current mailing address is 5441 E. Mining Camp St. Apache Junction, AZ 85119

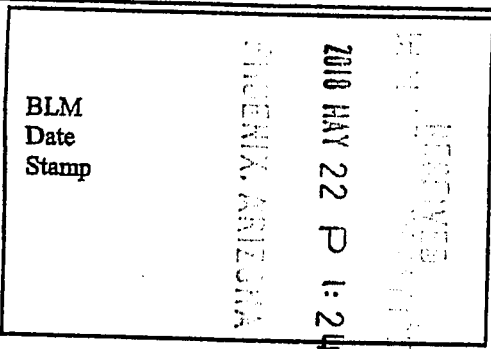

The general course of this claim is N-S and it is situated in Mohave County, Arizona. This claim is 1500 feet in length and 600 feet in width.

20 Total Claim Acreage. This claim runs from the location monument on which this location notice is posted on the centerline of the claim approximately 20 feet in a N direction to the N end line and 1480 feet in a S direction to the S end line. This claim is marked by six monuments, one at each corner and one at the center of each end line of the claim.

The location monument on which this notice is posted is situated within Section 6, Township 20 N, Range 14 W, Gila Salt River Base and Meridian, Arizona and this claim encompasses portions of the following quarter section(s), section(s), Township(s) and Range(s) NE & SE 1/4 Section 6 T. 20 N., R. 14 W.

Gila Salt River Base and Meridian, Arizona.

The locality of this claim with reference to some natural object or permanent monument and additional information (if any) concerning its locality are as follows: The NW CORNER of claim is located 2700 ft. EAST and 1500 ft. SOUTH of survey monument located at NE Corner Section 1, T. 20 N., R. 15 W., GSRB & M. The above information is shown on the attached map.

DATED AND POSTED on the ground this 23 day of February, 2018.

LOCATOR(s) AGENT

Print Name(s) Nicholas Barr

Signature(s) Nicholas Barr

(Agent for Pershing Resources) Form MCF100

AMC450989

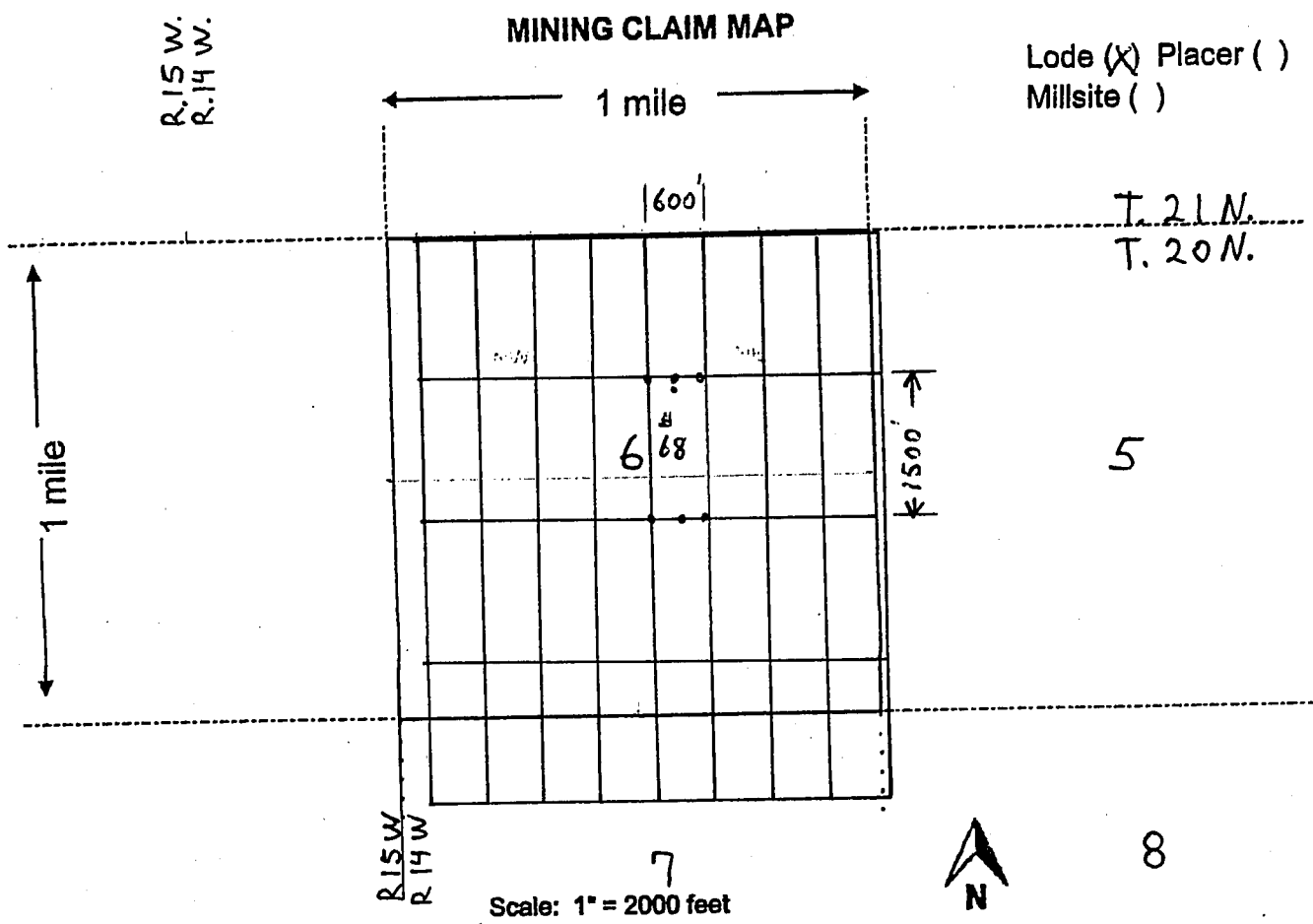

1. The above map depicts the EN # 68 mining claim, which is located in Section (s) 6, Township 20 N, Range 14 W, Gila and Salt River Base and Meridian, Mohave County, Arizona. Total claim acreage is 20 acres
2. The type of corner and location monuments used are as follows: 2" x 2" x 4 ft wood posts
3. The bearings and distances in degrees and feet between claim corners and to a public land survey monument are as depicted on the map.
4. If the claim is a placer or millsite claim with exterior limits conforming to legal subdivisions of the public survey, provide a legal description of the claim _____

Form MCF100a
Revised July 2014

2

FEE# 2018012455

OFFICIAL RECORDS OF MOHAVE COUNTY KRISTI BLAIR, COUNTY RECORDER



03/14/2018 11:36 AM Fee: \$10.00

PAGE: 1 of 2

After recording return to: Pershing Resources 200 S. Virginia St. 8th Floor Reno, Nevada 89501

LOCATION NOTICE FOR LODE MINING CLAIM

Amendment BLM Serial #

NOTICE IS HEREBY GIVEN that the EN# 69 lode mining claim has been located by Nicholas BARR (agent) whose current mailing address is 5441 E. Mining Camp St. Apache Junction, AZ 85119

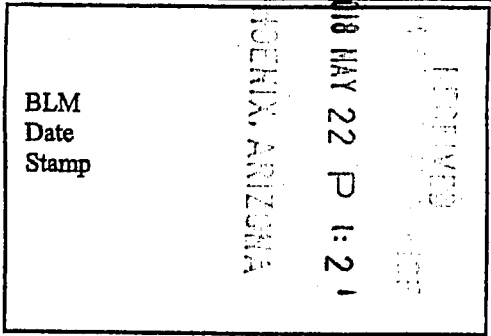

The general course of this claim is N-S and it is situated in Mohave County, Arizona. This claim is 1500 feet in length and 600 feet in width.

20 Total Claim Acreage. This claim runs from the location monument on which this location notice is posted on the centerline of the claim approximately 20 feet in a N direction to the N end line and 1480 feet in a S direction to the S end line. This claim is marked by six monuments, one at each corner and one at the center of each end line of the claim.

The location monument on which this notice is posted is situated within Section 6, Township 20 N, Range 14 W, Gila Salt River Base and Meridian, Arizona and this claim encompasses portions of the following quarter section(s), section(s), Township(s) and Range(s) NE 1/4 & SE 1/4 Sec 6 T. 20 N., R. 14 W.

Gila Salt River Base and Meridian, Arizona.

The locality of this claim with reference to some natural object or permanent monument and additional information (if any) concerning its locality are as follows: The NW CORNER of claim is located 3300 ft. EAST and 1500 ft. SOUTH of survey monument located at NE Corner Section 1, T. 20 N., R. 15 W. GSRB & M. The above information is shown on the attached map.

DATED AND POSTED on the ground this 23 day of February, 2018.

LOCATOR(s) AGENT

Print Name(s) Nicholas Barr

Signature(s) Nicholas Barr

(Agent for Pershing Resources) Form MCF100

AHC450990

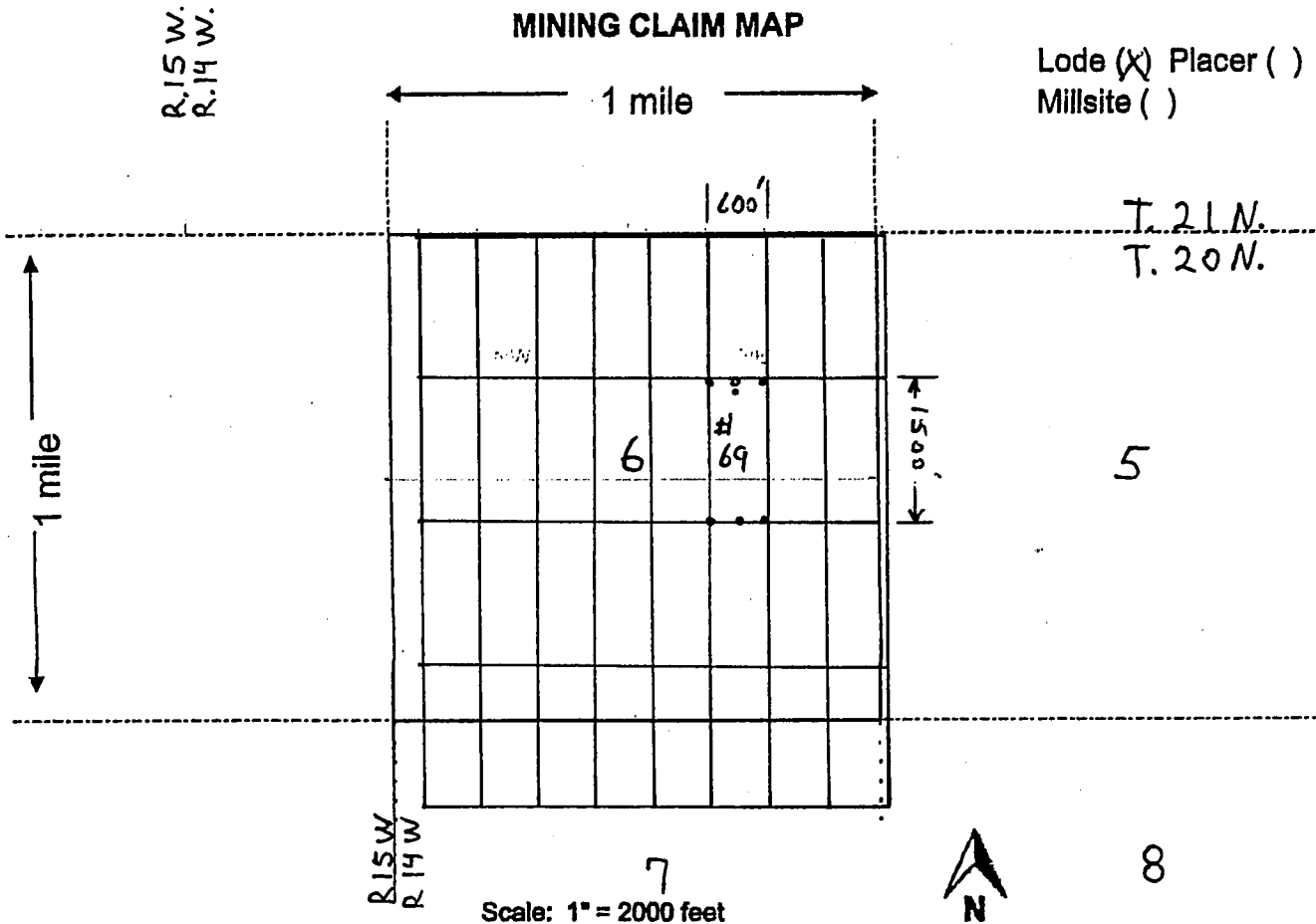

1. The above map depicts the EN # 69 mining claim, which is located in Section (s) 6, Township 20 N, Range 14 W, Gila and Salt River Base and Meridian, Mohave County, Arizona. Total claim acreage is 20 acres
2. The type of corner and location monuments used are as follows: 2" x 2" x 4 ft wood posts
3. The bearings and distances in degrees and feet between claim corners and to a public land survey monument are as depicted on the map.
4. If the claim is a placer or millsite claim with exterior limits conforming to legal subdivisions of the public survey, provide a legal description of the claim _____

Form MCF100a
Revised July 2014

2



FEE# 2018012456

OFFICIAL RECORDS OF MOHAVE COUNTY KRISTI BLAIR, COUNTY RECORDER



03/14/2018 11:36 AM Fee: \$10.00

PAGE: 1 of 2

After recording return to: Pershing Resources 200 S. Virginia St. 8th Floor Reno, Nevada 89501

LOCATION NOTICE FOR LODE MINING CLAIM

Amendment BLM Serial #

NOTICE IS HEREBY GIVEN that the EN # 70 lode mining claim has been located

by Nicholas BARR (agent) whose current mailing address is 5441 E. Mining Camp St. Apache Junction, AZ 85119

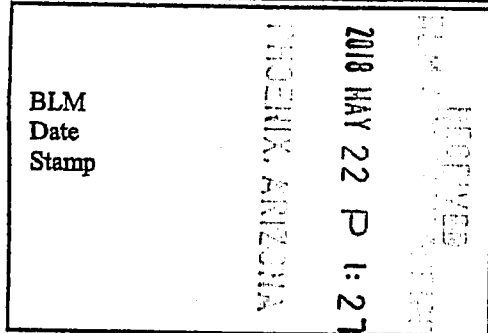

The general course of this claim is N-S and it is situated in Mohave County, Arizona. This claim is 1500 feet in length and 600 feet in width.

20 Total Claim Acreage. This claim runs from the location monument on which this location notice is posted on the centerline of the claim approximately 20 feet in a N direction to the N end line and 1480 feet in a S direction to the S end line. This claim is marked by six monuments, one at each corner and one at the center of each end line of the claim.

The location monument on which this notice is posted is situated within Section 6, Township 20 N, Range 14 W, Gila Salt River Base and Meridian, Arizona and this claim encompasses portions of the following quarter section(s), section(s), Township(s) and Range(s) NE & SE 1/4 Section 6 T. 20 N., R. 14 W.

Gila Salt River Base and Meridian, Arizona.

The locality of this claim with reference to some natural object or permanent monument and additional information (if any) concerning its locality are as follows: The NW CORNER of claim is located 3900 ft. EAST and 1500 ft. SOUTH of survey monument located at NE Corner Section 1, T. 20 N., R. 15 W., GSRBM. The above information is shown on the attached map.

DATED AND POSTED on the ground this 23 day of February, 2018.

LOCATOR(s) AGENT

Print Name(s) Nicholas Barr

Signature(s) Nicholas Barr

(Agent for Pershing Resources) Form MCF100

AHC450991

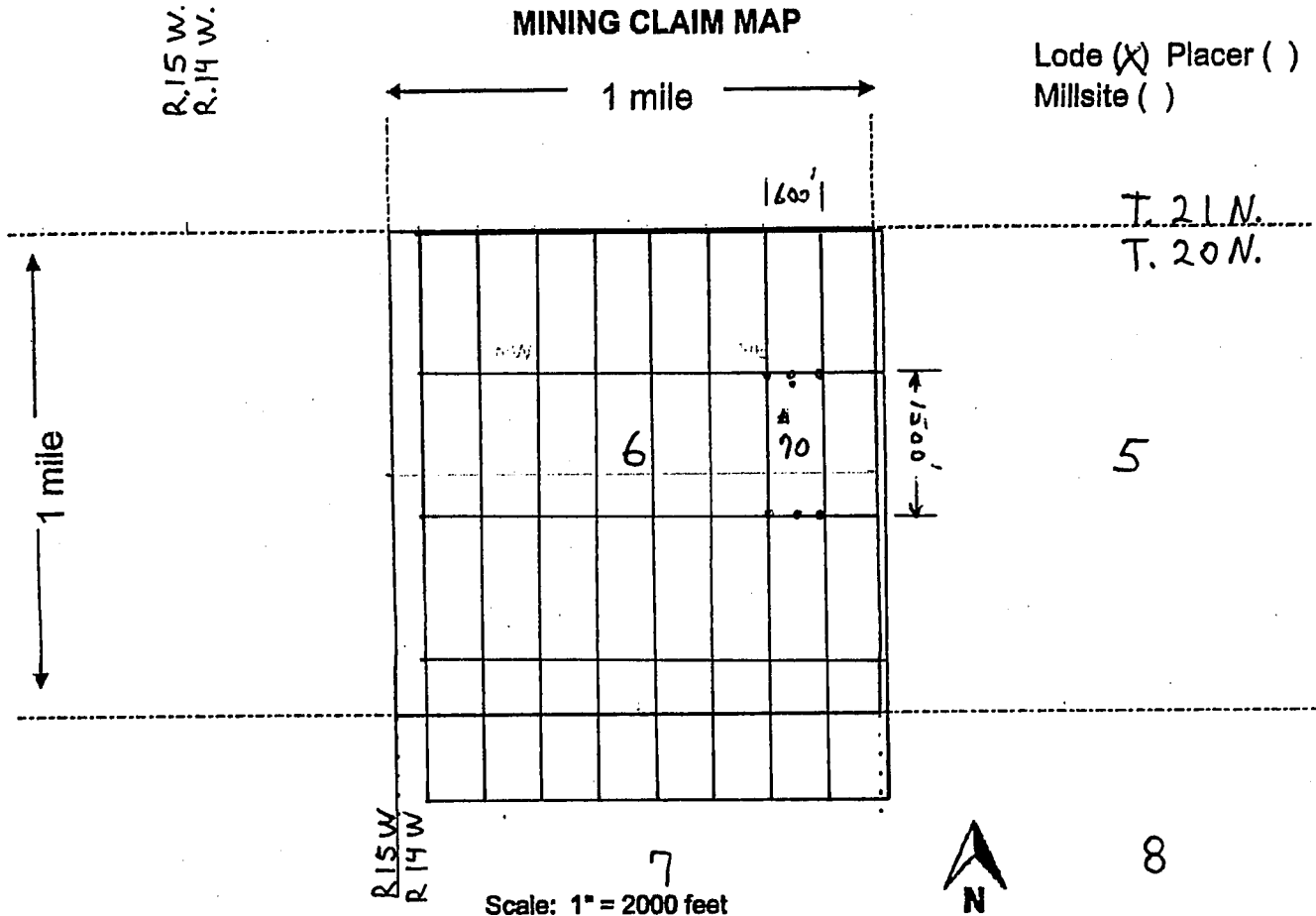

1. The above map depicts the EN # 70 mining claim, which is located in Section (s) 6, Township 20 N, Range 14 W, Gila and Salt River Base and Meridian, Mohave County, Arizona. Total claim acreage is 20 acres
2. The type of corner and location monuments used are as follows: 2" x 2" x 4 ft wood posts
3. The bearings and distances in degrees and feet between claim corners and to a public land survey monument are as depicted on the map.
4. If the claim is a placer or millsite claim with exterior limits conforming to legal subdivisions of the public survey, provide a legal description of the claim _____

Form MCF100a
Revised July 2014

2



FEE# 2018012457

OFFICIAL RECORDS OF MOHAVE COUNTY KRISTI BLAIR, COUNTY RECORDER



03/14/2018 11:36 AM Fee: \$10.00

PAGE: 1 of 2

After recording return to: Pershing Resources 200 S. Virginia St. 8th Floor Reno, Nevada 89501

LOCATION NOTICE FOR LODE MINING CLAIM

Amendment BLM Serial #

NOTICE IS HEREBY GIVEN that the EN # 71 lode mining claim has been located by Nicholas BARR (agent) whose current mailing address is 5441 E. Mining Camp St. Apache Junction, AZ 85119

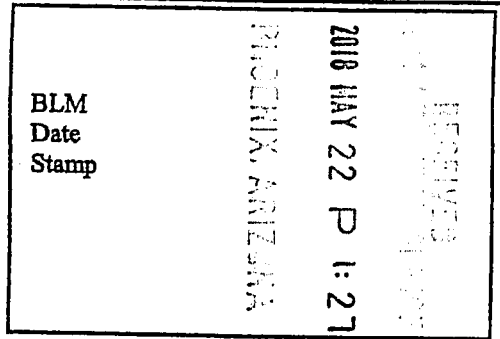

The general course of this claim is N-S and it is situated in Mohave County, Arizona. This claim is 1500 feet in length and 600 feet in width.

20 Total Claim Acreage. This claim runs from the location monument on which this location notice is posted on the centerline of the claim approximately 20 feet in a N direction to the N end line and 1480 feet in a S direction to the S end line. This claim is marked by six monuments, one at each corner and one at the center of each end line of the claim.

The location monument on which this notice is posted is situated within Section 6, Township 20 N, Range 14 W, Gila Salt River Base and Meridian, Arizona and this claim encompasses portions of the following quarter section(s), section(s), Township(s) and Range(s) NE & SE 1/4 Section 6 T. 20 N., R. 14 W. & NW & SW 1/4 Section 5 T. 20 N., R. 14 W Gila Salt River Base and Meridian, Arizona.

The locality of this claim with reference to some natural object or permanent monument and additional information (if any) concerning its locality are as follows: The NW CORNER of claim is located 4500 ft. EAST and 1500 ft. SOUTH of survey monument located at NE Corner Section 1, T. 20 N., R. 15 W. GSRB & M. The above information is shown on the attached map.

DATED AND POSTED on the ground this 23 day of February, 2018.

LOCATOR(s) AGENT

Print Name(s) Nicholas Barr Signature(s) Nicholas Barr (Agent for Pershing Resources) Form MCF100

AHC450992

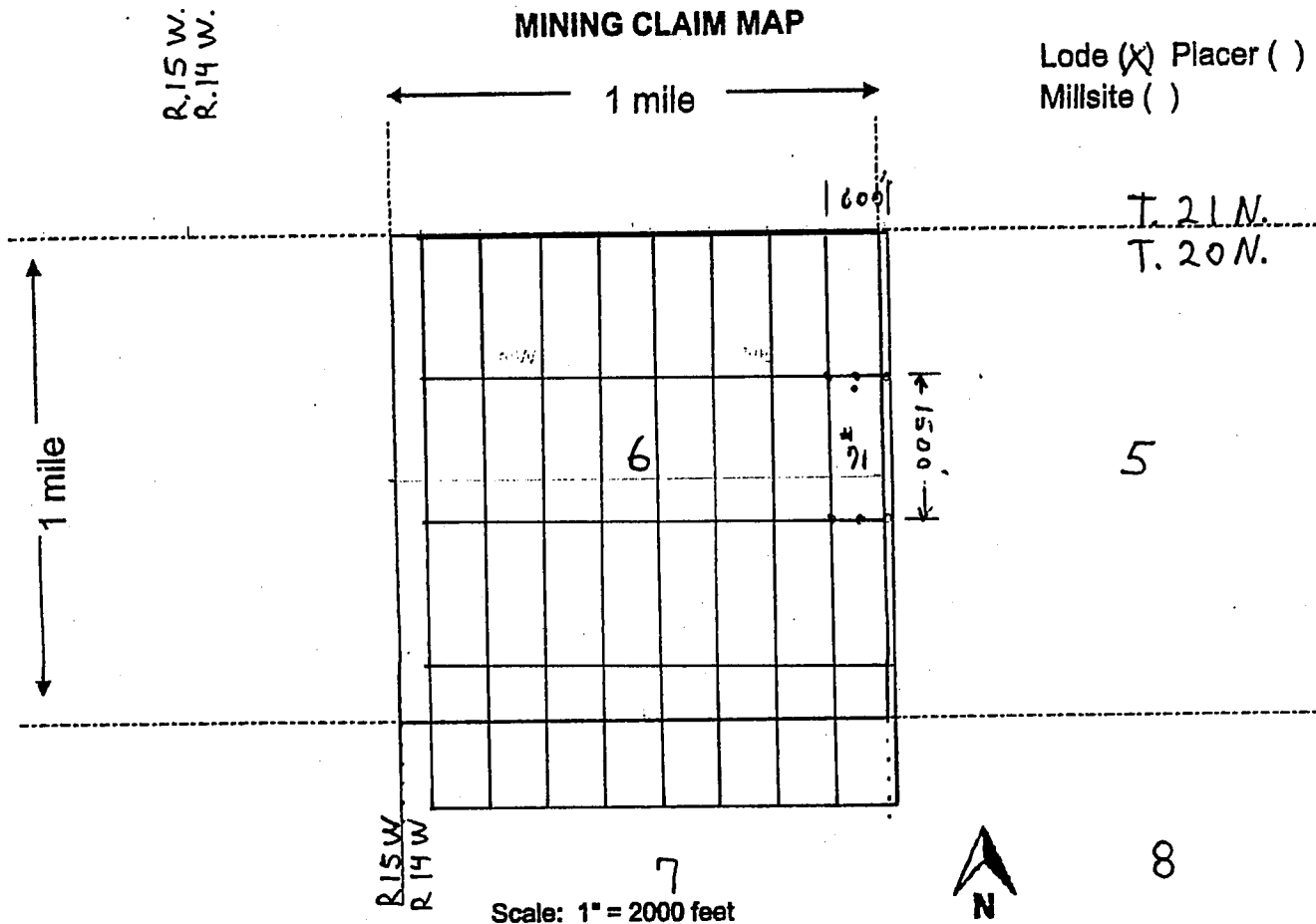

1. The above map depicts the EN # 71 mining claim, which is located in Section (s) 516, Township 20 N, Range 14 W, Gila and Salt River Base and Meridian, Mohave County, Arizona. Total claim acreage is 20 acres
2. The type of corner and location monuments used are as follows: 2" x 2" x 4 ft wood posts
3. The bearings and distances in degrees and feet between claim corners and to a public land survey monument are as depicted on the map.
4. If the claim is a placer or millsite claim with exterior limits conforming to legal subdivisions of the public survey, provide a legal description of the claim _____

Form MCF100a
Revised July 2014

FEE# 2018012461

OFFICIAL RECORDS OF MOHAVE COUNTY KRISTI BLAIR, COUNTY RECORDER



03/14/2018 11:36 AM Fee: \$10.00

PAGE: 1 of 2

After recording return to: Pershing Resources 200 S. Virginia St. 8th Floor Reno, Nevada 89501

LOCATION NOTICE FOR LODE MINING CLAIM

Amendment BLM Serial #

NOTICE IS HEREBY GIVEN that the EN# 75 lode mining claim has been located by Nicholas BARR (agent) whose current mailing address is 5441 E. Mining Camp St. Apache Junction, AZ 85119

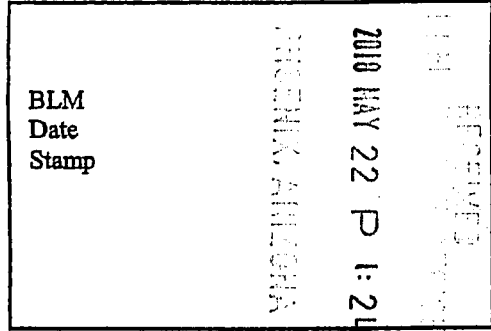

The general course of this claim is N-S and it is situated in Mohave County, Arizona. This claim is 1500 feet in length and 600 feet in width.

20 Total Claim Acreage. This claim runs from the location monument on which this location notice is posted on the centerline of the claim approximately 20 feet in a S direction to the S end line and 1480 feet in a N direction to the N end line. This claim is marked by six monuments, one at each corner and one at the center of each end line of the claim.

The location monument on which this notice is posted is situated within Section 6, Township 20 N, Range 14 W, Gila Salt River Base and Meridian, Arizona and this claim encompasses portions of the following quarter section(s), section(s), Township(s) and Range(s) SW 1/4 Section 6 T. 20 N., R. 14 W.

Gila Salt River Base and Meridian, Arizona.

The locality of this claim with reference to some natural object or permanent monument and additional information (if any) concerning its locality are as follows: The NW CORNER of claim is located 900 ft. EAST and 3000 ft. SOUTH of survey monument located at NE Corner Section 1, T. 20 N., R. 15 W., GSRB & M. The above information is shown on the attached map.

DATED AND POSTED on the ground this 23 day of February, 2018.

LOCATOR(s) AGENT

Print Name(s) Nicholas Barr

Signature(s) Nicholas Barr

(Agent for Pershing Resources) Form MCF100

AHC450993

MINING CLAIM MAP

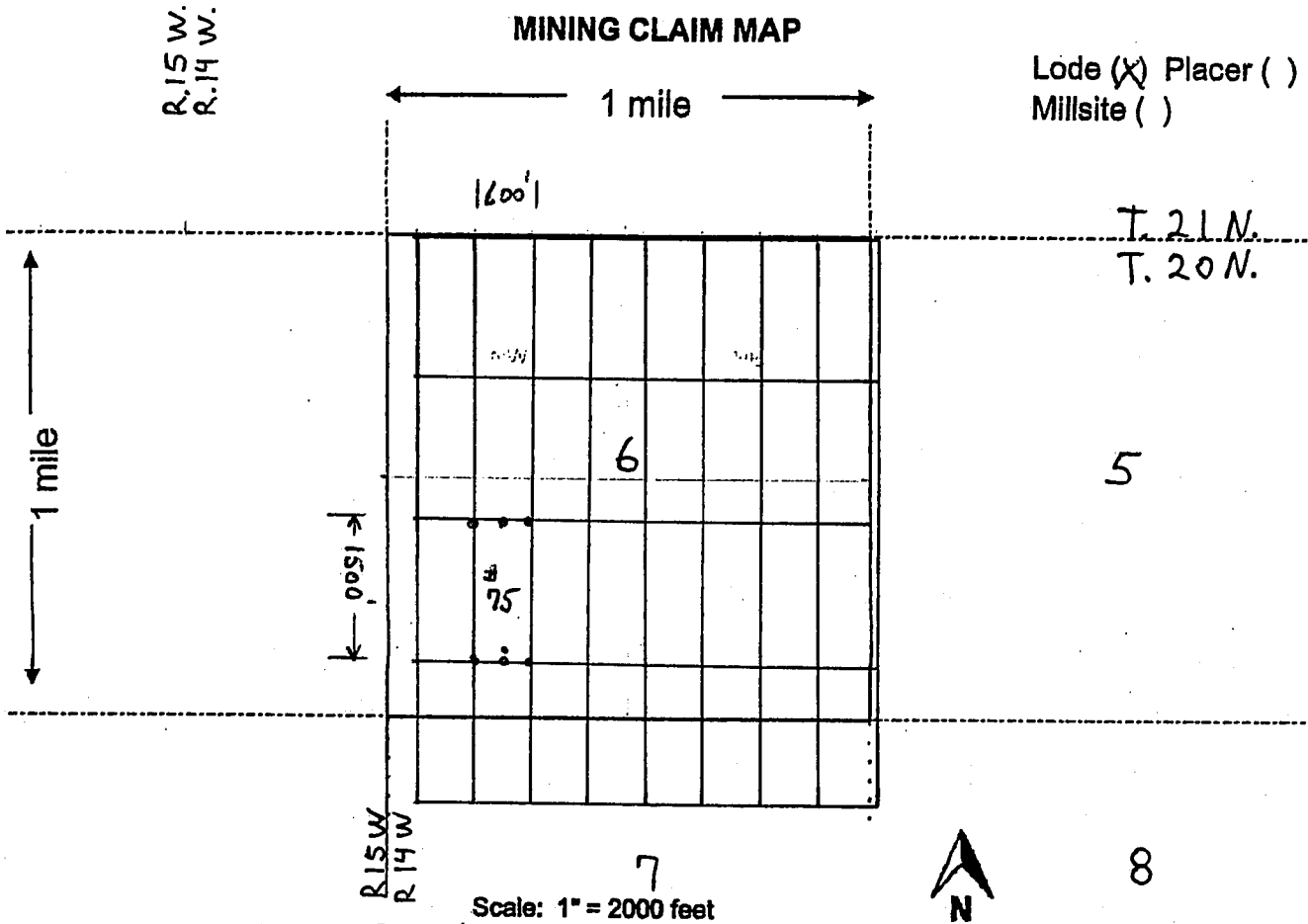

Lode (X) Placer ()
Millsite ()

1. The above map depicts the EN # 75 mining claim, which is located in Section (s) 6, Township 20 N, Range 14 W, Gila and Salt River Base and Meridian, Mohave County, Arizona. Total claim acreage is 20 acres

2. The type of corner and location monuments used are as follows: 2" x 2" x 4 ft wood posts

3. The bearings and distances in degrees and feet between claim corners and to a public land survey monument are as depicted on the map.

4. If the claim is a placer or millsite claim with exterior limits conforming to legal subdivisions of the public survey, provide a legal description of the claim _____

Form MCF100a
Revised July 2014

2

FEE# 2018012462

OFFICIAL RECORDS OF MOHAVE COUNTY KRISTI BLAIR, COUNTY RECORDER



03/14/2018 11:36 AM Fee: \$10.00

PAGE: 1 of 2

After recording return to: Pershing Resources 200 S. Virginia St. 8th Floor Reno, Nevada 89501

LOCATION NOTICE FOR LODE MINING CLAIM

Amendment BLM Serial #

NOTICE IS HEREBY GIVEN that the EN# 76 lode mining claim has been located by Nicholas BARR (agent) whose current mailing address is 5441 E. Mining Camp St. Apache Junction, AZ 85119

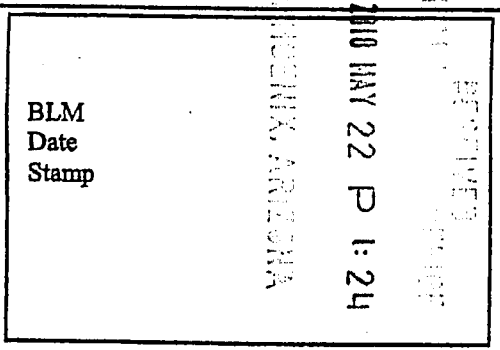

The general course of this claim is N-S and it is situated in Mohave County, Arizona. This claim is 1500 feet in length and 600 feet in width.

20 Total Claim Acreage. This claim runs from the location monument on which this location notice is posted on the centerline of the claim approximately 20 feet in a S direction to the S end line and 1480 feet in a N direction to the N end line. This claim is marked by six monuments, one at each corner and one at the center of each end line of the claim.

The location monument on which this notice is posted is situated within Section 6, Township 20 N, Range 14 W, Gila Salt River Base and Meridian, Arizona and this claim encompasses portions of the following quarter section(s), section(s), Township(s) and Range(s) SW 1/4 Section 6 T. 20 N., R. 14 W.

Gila Salt River Base and Meridian, Arizona.

The locality of this claim with reference to some natural object or permanent monument and additional information (if any) concerning its locality are as follows: The NW CORNER of claim is located 1500 ft EAST and 3000 ft SOUTH of survey monument located at NE Corner Section 1, T. 20 N., R. 15 W., GSRB & M. The above information is shown on the attached map.

DATED AND POSTED on the ground this 23 day of February, 2018.

LOCATOR(s) AGENT

Print Name(s) Nicholas Barr

Signature(s) Nicholas Barr

(Agent for Pershing Resources) Form MCF100

AHC450994

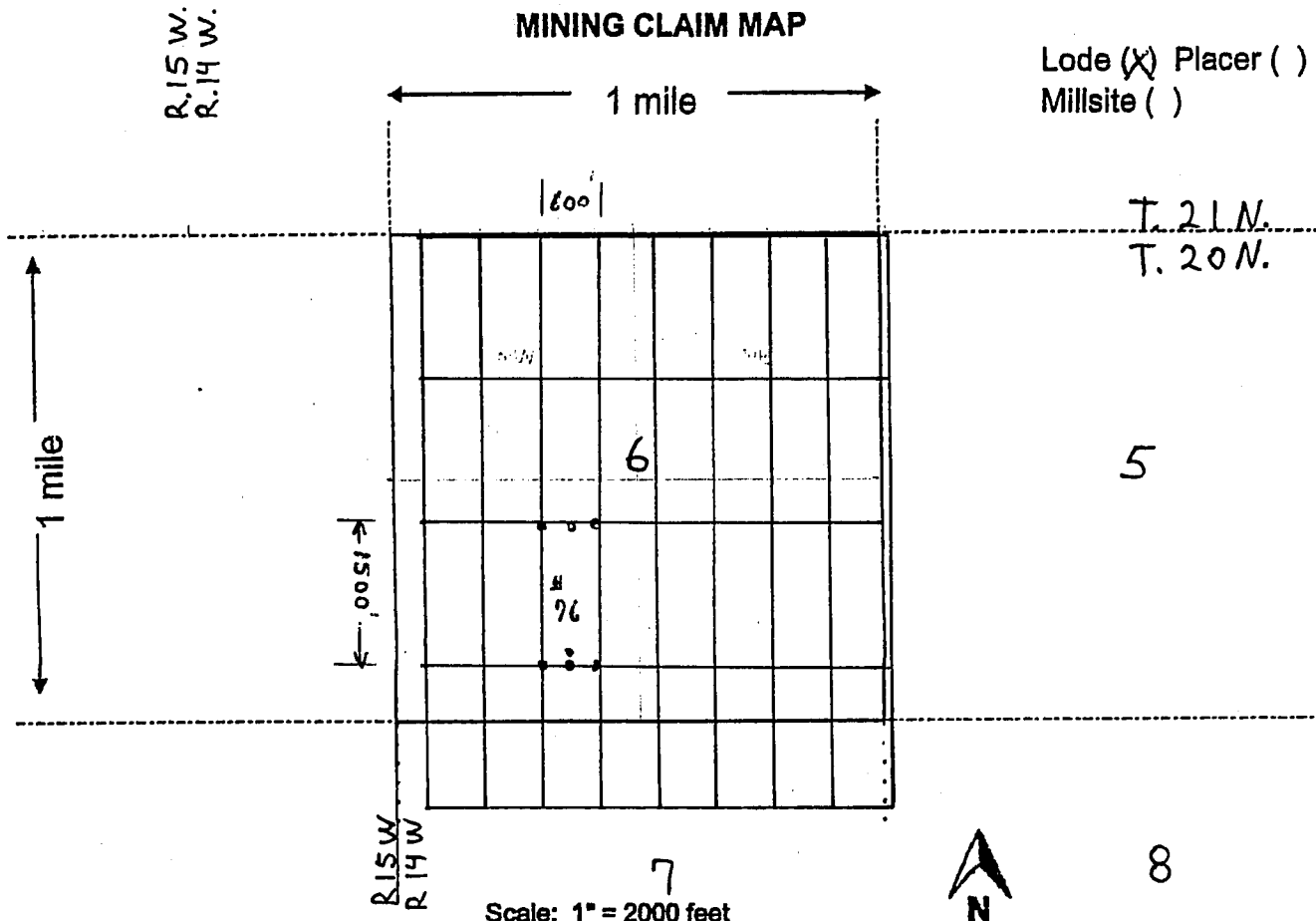

1. The above map depicts the EN # 76 mining claim, which is located in Section (s) 6, Township 20 N, Range 14 W, Gila and Salt River Base and Meridian, Mohave County, Arizona. Total claim acreage is 20 acres
2. The type of corner and location monuments used are as follows: 2" x 2" x 4 ft wood posts
3. The bearings and distances in degrees and feet between claim corners and to a public land survey monument are as depicted on the map.
4. If the claim is a placer or millsite claim with exterior limits conforming to legal subdivisions of the public survey, provide a legal description of the claim _____

Form MCF100a
Revised July 2014

2

FEE# 2018012463

OFFICIAL RECORDS OF MOHAVE COUNTY KRISTI BLAIR, COUNTY RECORDER



03/14/2018 11:36 AM Fee: \$10.00

PAGE: 1 of 2

After recording return to: Pershing Resources 200 S. Virginia St. 8th Floor Reno, Nevada 89501

LOCATION NOTICE FOR LODE MINING CLAIM

Amendment BLM Serial #

NOTICE IS HEREBY GIVEN that the EN# 77 lode mining claim has been located by Nicholas BARR (agent) whose current mailing address is 5441 E. Mining Camp St. Apache Junction, AZ 85119

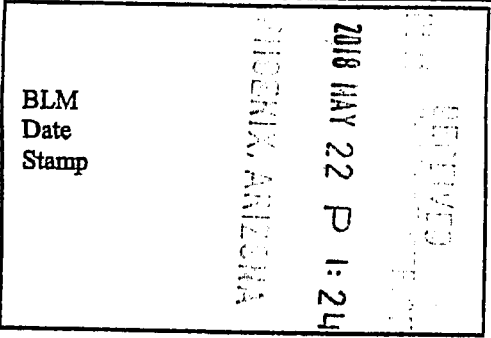

The general course of this claim is N-S and it is situated in Mohave County, Arizona. This claim is 1500 feet in length and 600 feet in width.

20 Total Claim Acreage. This claim runs from the location monument on which this location notice is posted on the centerline of the claim approximately 20 feet in a S direction to the S end line and 1480 feet in a N direction to the N end line. This claim is marked by six monuments, one at each corner and one at the center of each end line of the claim.

The location monument on which this notice is posted is situated within Section 6, Township 20 N, Range 14 W, Gila Salt River Base and Meridian, Arizona and this claim encompasses portions of the following quarter section(s), section(s), Township(s) and Range(s) SW 1 SE 4 Section 6 T. 20 N. R. 14 W.

Gila Salt River Base and Meridian, Arizona.

The locality of this claim with reference to some natural object or permanent monument and additional information (if any) concerning its locality are as follows: The NW CORNER of claim is located 2100 ft. EAST and 3000 ft. SOUTH of survey monument located at NE Corner Section 1, T. 20 N., R. 15 W., GSRB & M. The above information is shown on the attached map.

DATED AND POSTED on the ground this 23 day of February, 2018.

LOCATOR(s) AGENT

Print Name(s) Nicholas Barr

Signature(s) Nicholas Barr

(Agent for Pershing Resources) Form MCF100

AHC450995

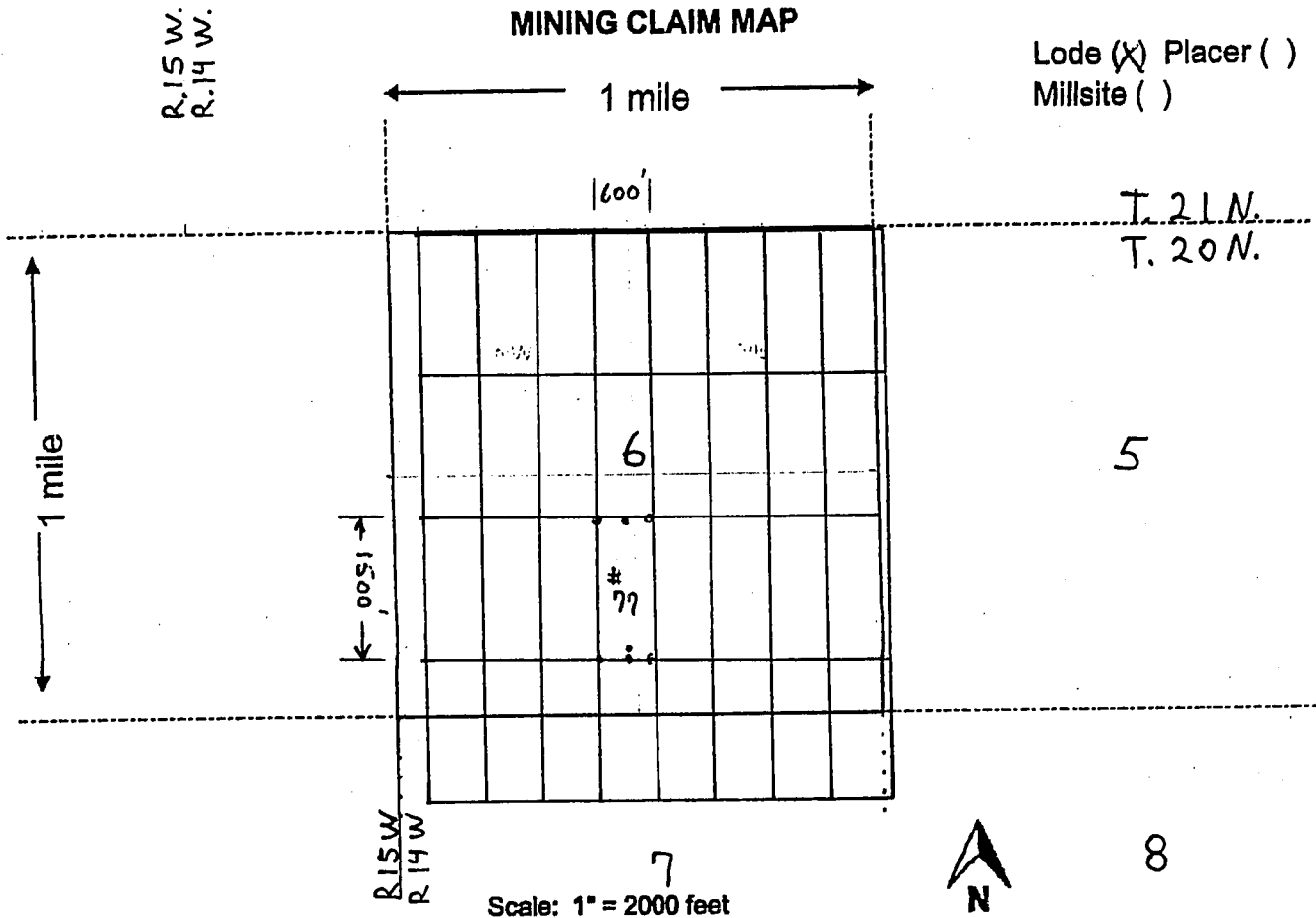

1. The above map depicts the EN # 77 mining claim, which is located in Section (s) 6, Township 20 N, Range 14 W, Gila and Salt River Base and Meridian, Mohave County, Arizona. Total claim acreage is 20 acres
2. The type of corner and location monuments used are as follows: 2" x 2" x 4 ft wood posts
3. The bearings and distances in degrees and feet between claim corners and to a public land survey monument are as depicted on the map.
4. If the claim is a placer or millsite claim with exterior limits conforming to legal subdivisions of the public survey, provide a legal description of the claim _____

Form MCF100a
Revised July 2014

FEE# 2018012464

OFFICIAL RECORDS OF MOHAVE COUNTY KRISTI BLAIR, COUNTY RECORDER



03/14/2018 11:36 AM Fee: \$10.00

PAGE: 1 of 2

After recording return to: Pershing Resources 200 S. Virginia St. 8th Floor Reno, Nevada 89501

LOCATION NOTICE FOR LODE MINING CLAIM

Amendment BLM Serial #

NOTICE IS HEREBY GIVEN that the EN# 78 lode mining claim has been located

by Nicholas BARR (agent) whose current mailing address is 5441 E. Mining Camp St. Apache Junction, AZ 85119

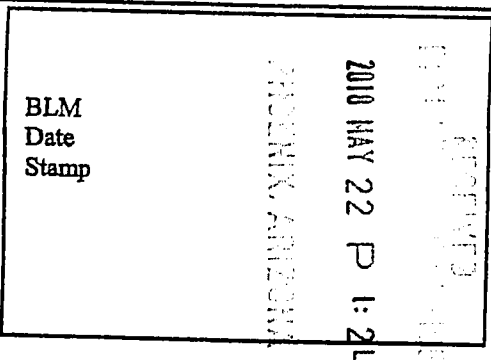

The general course of this claim is N-S and it is situated in Mohave County, Arizona. This claim is 1500 feet in length and 600 feet in width.

20 Total Claim Acreage. This claim runs from the location monument on which this location notice is posted on the centerline of the claim approximately 20 feet in a S direction to the S end line and 1480 feet in a N direction to the N end line. This claim is marked by six monuments, one at each corner and one at the center of each end line of the claim.

The location monument on which this notice is posted is situated within Section 6, Township 20 N, Range 14 W, Gila Salt River Base and Meridian, Arizona and this claim encompasses portions of the following quarter section(s), section(s), Township(s) and Range(s) SE 1/4 Section 6 T. 20 N. R. 14 W.

Gila Salt River Base and Meridian, Arizona.

The locality of this claim with reference to some natural object or permanent monument and additional information (if any) concerning its locality are as follows: The NW CORNER of claim is located 2700 ft. EAST and 3000 ft. SOUTH of survey monument located at NE Corner Section 1, T. 20 N., R. 15 W., GSRB & M. The above information is shown on the attached map.

DATED AND POSTED on the ground this 23 day of February, 2018.

LOCATOR(s) AGENT

Print Name(s) Nicholas Barr

Signature(s) Nicholn Barr

(Agent for Pershing Resources) Form MCF100

AHCH450996

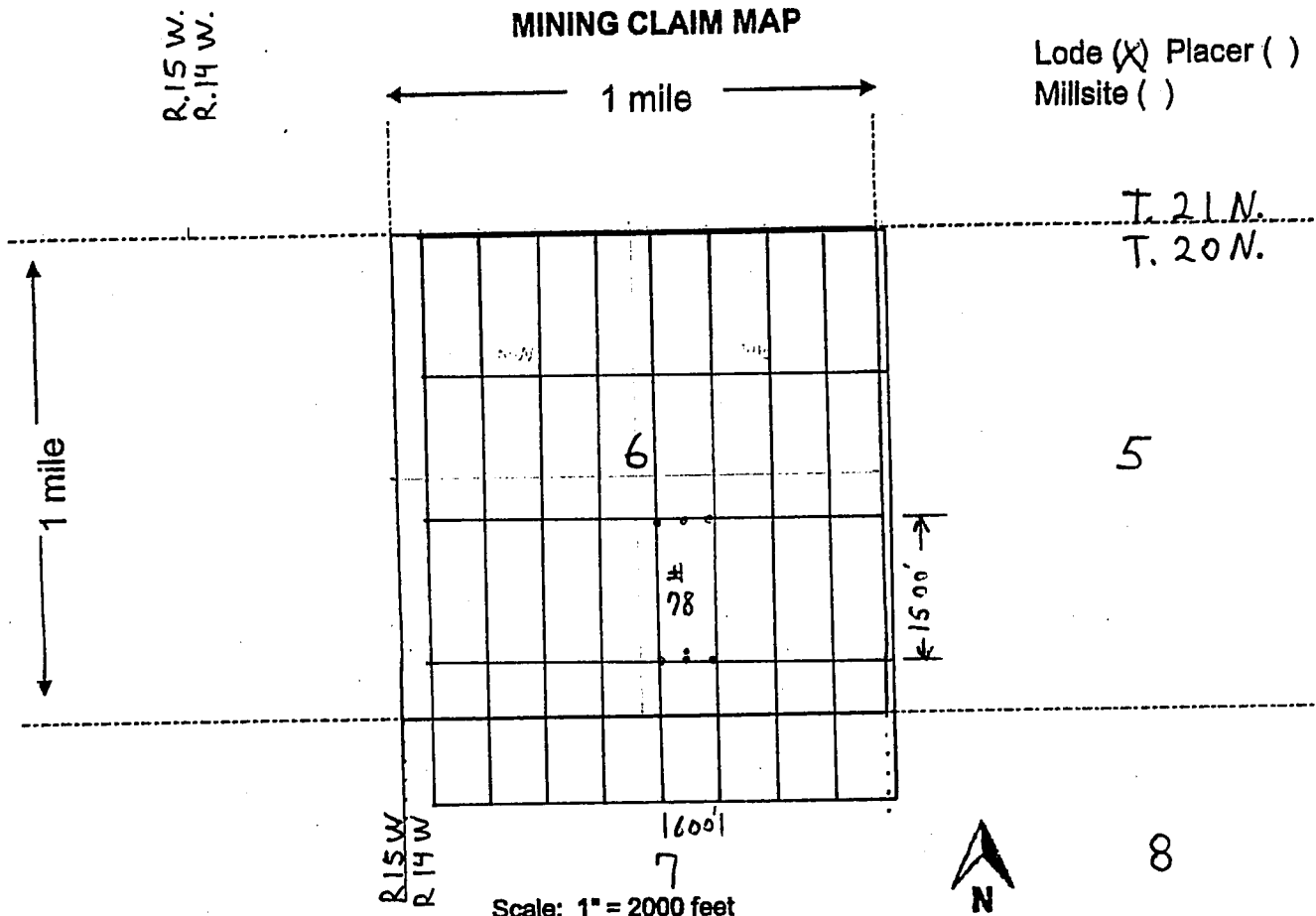

- The above map depicts the EN # 78 mining claim, which is located in Section (s) 6, Township 20 N, Range 14 W, Gila and Salt River Base and Meridian, Mohave County, Arizona. Total claim acreage is 20 acres
- The type of corner and location monuments used are as follows: 2" x 2" x 4 ft wood posts
- The bearings and distances in degrees and feet between claim corners and to a public land survey monument are as depicted on the map.
- If the claim is a placer or millsite claim with exterior limits conforming to legal subdivisions of the public survey, provide a legal description of the claim _____

Form MCF100a
Revised July 2014

2

FEE# 2018012465

OFFICIAL RECORDS OF MOHAVE COUNTY KRISTI BLAIR, COUNTY RECORDER



03/14/2018 11:36 AM Fee: \$10.00

PAGE: 1 of 2

After recording return to: Pershing Resources 200 S. Virginia St. 8th Floor Reno, Nevada 89501

LOCATION NOTICE FOR LODE MINING CLAIM

Amendment BLM Serial #

NOTICE IS HEREBY GIVEN that the EN# 79 lode mining claim has been located by Nicholas BARR (agent) whose current mailing address is 5441 E. Mining Camp St. Apache Junction, AZ 85119

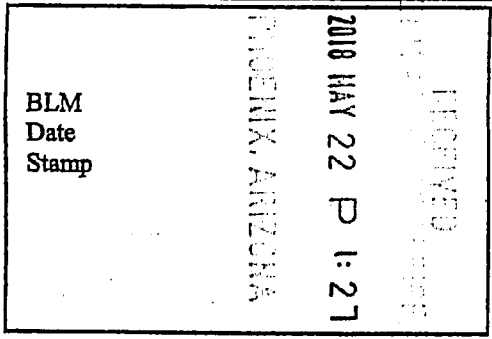

The general course of this claim is N-S and it is situated in Mohave County, Arizona. This claim is 1500 feet in length and 600 feet in width.

20 Total Claim Acreage. This claim runs from the location monument on which this location notice is posted on the centerline of the claim approximately 20 feet in a S direction to the S end line and 1480 feet in a N direction to the N end line. This claim is marked by six monuments, one at each corner and one at the center of each end line of the claim.

The location monument on which this notice is posted is situated within Section 6, Township 20 N, Range 14 W, Gila Salt River Base and Meridian, Arizona and this claim encompasses portions of the following quarter section(s), section(s), Township(s) and Range(s) SE 1/4 Section 6 T. 20 N., R. 14 W.

Gila Salt River Base and Meridian, Arizona.

The locality of this claim with reference to some natural object or permanent monument and additional information (if any) concerning its locality are as follows: The NW CORNER of claim is located 3300 ft EAST and 3000 ft SOUTH of survey monument located at NE Corner Section 1, T. 20 N., R. 15 W., GSRB & M. The above information is shown on the attached map.

DATED AND POSTED on the ground this 23 day of February, 2018.

LOCATOR(s) AGENT

Print Name(s) Nicholas Barr

Signature(s) Nicholas Barr

(Agent for Pershing Resources) Form MCF100

AHC450997

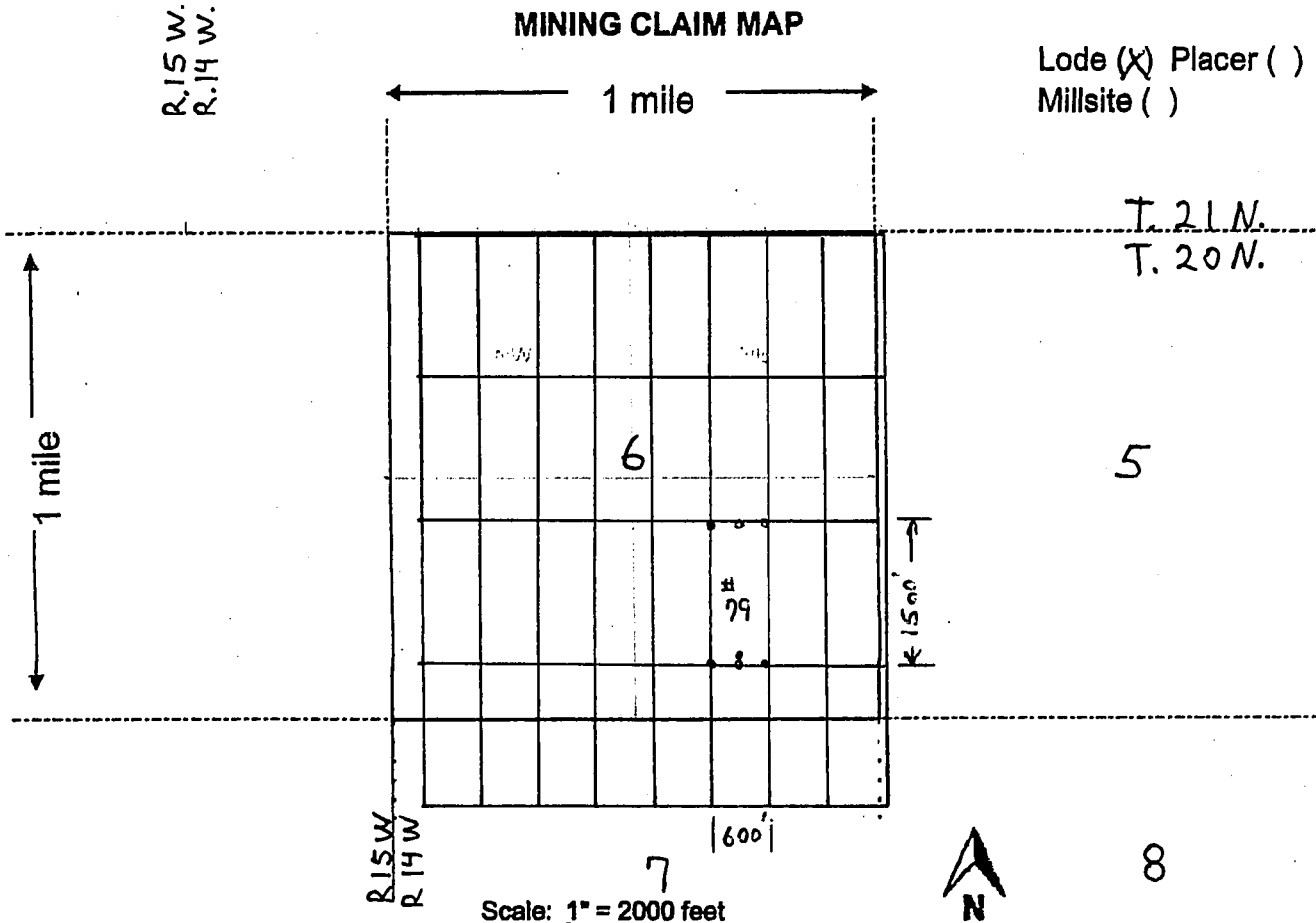

Lode (X) Placer ()
Millsite ()

- The above map depicts the EN # 79 mining claim, which is located in Section (s) 6, Township 20 N, Range 14 W, Gila and Salt River Base and Meridian, Mohave County, Arizona. Total claim acreage is 20 acres
- The type of corner and location monuments used are as follows: 2" x 2" x 4 ft wood posts
- The bearings and distances in degrees and feet between claim corners and to a public land survey monument are as depicted on the map.
- If the claim is a placer or millsite claim with exterior limits conforming to legal subdivisions of the public survey, provide a legal description of the claim _____

Form MCF100a
Revised July 2014

This form is available from the Arizona Geology Survey and may be reproduced.

FEE# 2018012466

OFFICIAL RECORDS OF MOHAVE COUNTY KRISTI BLAIR, COUNTY RECORDER



03/14/2018 11:36 AM Fee: \$10.00

PAGE: 1 of 2

After recording return to: Pershing Resources 200 S. Virginia St. 8th Floor Reno, Nevada 89501

LOCATION NOTICE FOR LODE MINING CLAIM

Amendment BLM Serial #

NOTICE IS HEREBY GIVEN that the EN# 80 lode mining claim has been located by Nicholas BARR (agent) whose current mailing address is 5441 E. Mining Camp St. Apache Junction, AZ 85119

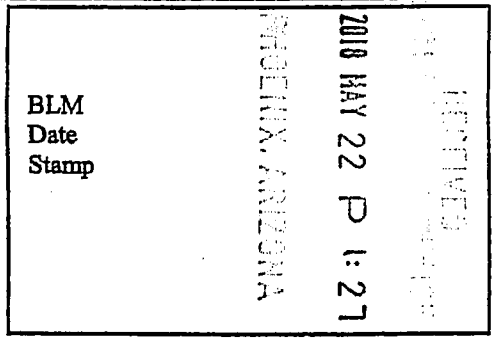

The general course of this claim is N-S and it is situated in Mohave County, Arizona. This claim is 1500 feet in length and 600 feet in width.

20 Total Claim Acreage. This claim runs from the location monument on which this location notice is posted on the centerline of the claim approximately 20 feet in a S direction to the S end line and 1480 feet in a N direction to the N end line. This claim is marked by six monuments, one at each corner and one at the center of each end line of the claim.

The location monument on which this notice is posted is situated within Section 6, Township 20 N, Range 14 W, Gila Salt River Base and Meridian, Arizona and this claim encompasses portions of the following quarter section(s), section(s), Township(s) and Range(s) SE 1/4 Section 6 T. 20 N., R. 14 W.

Gila Salt River Base and Meridian, Arizona.

The locality of this claim with reference to some natural object or permanent monument and additional information (if any) concerning its locality are as follows: The NW CORNER of claim is located 3900 ft. EAST and 3000 ft. SOUTH of survey monument located at NE Corner Section 1, T. 20 N., R. 15 W. GSRB & M. The above information is shown on the attached map.

DATED AND POSTED on the ground this 23 day of February, 2018.

LOCATOR(s) AGENT

Print Name(s) Nicholas Barr Signature(s) Nicholas Barr (Agent for Pershing Resources) Form MCF100

AH0450998

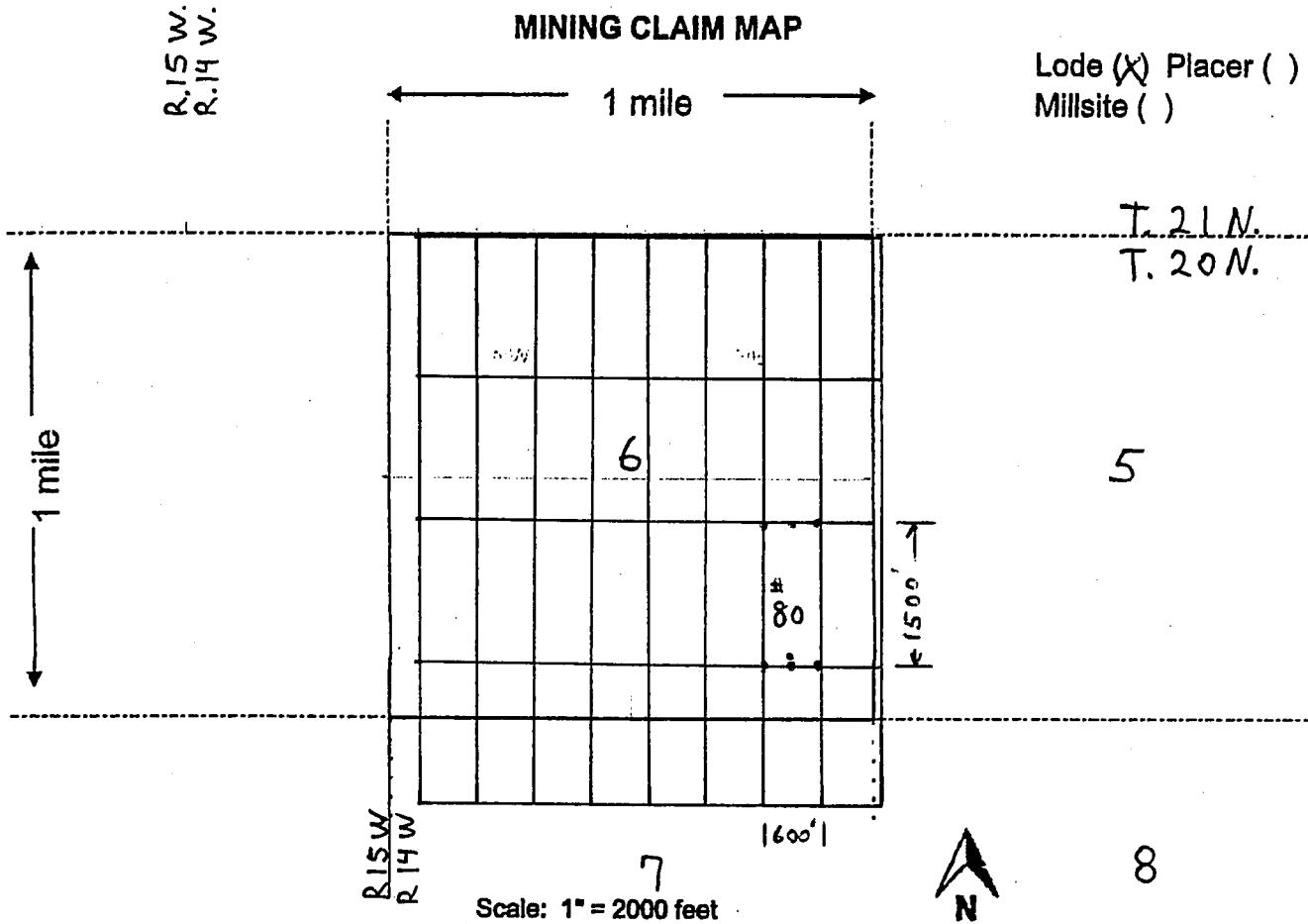

1. The above map depicts the EN # 80 mining claim, which is located in Section (s) 6, Township 20 N, Range 14 W, Gila and Salt River Base and Meridian, Mohave County, Arizona. Total claim acreage is 20 acres
2. The type of corner and location monuments used are as follows: 2" x 2" x 4 ft wood posts
3. The bearings and distances in degrees and feet between claim corners and to a public land survey monument are as depicted on the map.
4. If the claim is a placer or millsite claim with exterior limits conforming to legal subdivisions of the public survey, provide a legal description of the claim _____

Form MCF100a
Revised July 2014



FEE# 2018012467

OFFICIAL RECORDS OF MOHAVE COUNTY KRISTI BLAIR, COUNTY RECORDER



03/14/2018 11:36 AM Fee: \$10.00

PAGE: 1 of 2

After recording return to: Pershing Resources 200 S. Virginia St. 8th Floor Reno, Nevada 89501

LOCATION NOTICE FOR LODE MINING CLAIM

Amendment BLM Serial #

NOTICE IS HEREBY GIVEN that the EN # 81 lode mining claim has been located

by Nicholas BARR (agent) whose current mailing address is 5441 E. Mining Camp St. Apache Junction, AZ 85119

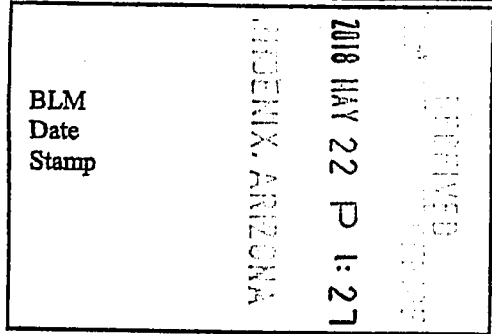

The general course of this claim is N-S and it is situated in Mohave County, Arizona. This claim is 1500 feet in length and 600 feet in width.

20 Total Claim Acreage. This claim runs from the location monument on which this location notice is posted on the centerline of the claim approximately 20 feet in a S direction to the S end line and 1480 feet in a N direction to the N end line. This claim is marked by six monuments, one at each corner and one at the center of each end line of the claim.

The location monument on which this notice is posted is situated within Section 6, Township 20 N, Range 14 W, Gila Salt River Base and Meridian, Arizona and this claim encompasses portions of the following quarter section(s), section(s), Township(s) and Range(s) SE 1/4 Sec 6 & SW 1/4 Sec 5 T. 20 N., R. 14 W.

Gila Salt River Base and Meridian, Arizona.

The locality of this claim with reference to some natural object or permanent monument and additional information (if any) concerning its locality are as follows: The NW CORNER of claim is located 4500 ft EAST and 3000 ft SOUTH of survey monument located at NE Corner Section 1, T. 20 N., R. 15 W., GSRB & M. The above information is shown on the attached map.

DATED AND POSTED on the ground this 23 day of February, 2018.

LOCATOR(s) AGENT

Print Name(s) Nicholas Barr

Signature(s) Nicholas Barr

(Agent for Pershing Resources) Form MCF100

AHC450999

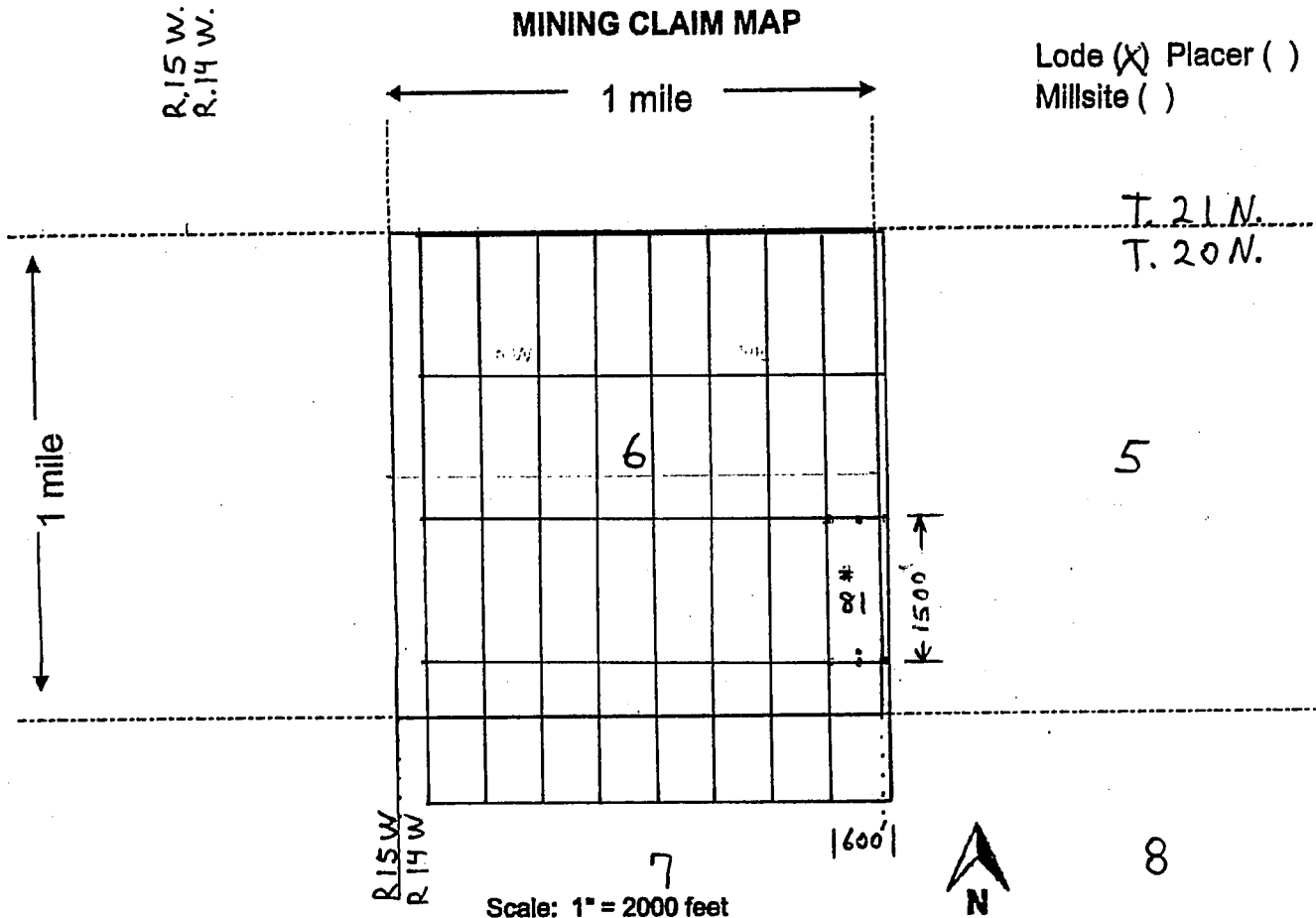

1. The above map depicts the EN # 81 mining claim, which is located in Section (s) 5 & 6, Township 20 N, Range 14 W, Gila and Salt River Base and Meridian, Mohave County, Arizona. Total claim acreage is 20 acres
2. The type of corner and location monuments used are as follows: 2" x 2" x 4 ft wood posts
3. The bearings and distances in degrees and feet between claim corners and to a public land survey monument are as depicted on the map.
4. If the claim is a placer or millsite claim with exterior limits conforming to legal subdivisions of the public survey, provide a legal description of the claim _____

Form MCF100a
Revised July 2014

FEE# 2018012471

OFFICIAL RECORDS OF MOHAVE COUNTY KRISTI BLAIR, COUNTY RECORDER



03/14/2018 11:36 AM Fee: \$10.00

PAGE: 1 of 2

After recording return to: Pershing Resources 200 S. Virginia St. 8th Floor Reno, Nevada 89501

LOCATION NOTICE FOR LODE MINING CLAIM

Amendment BLM Serial #

NOTICE IS HEREBY GIVEN that the EN# 85 lode mining claim has been located by Nicholas BARR (agent) whose current mailing address is 5441 E. Mining Camp St. Apache Junction, AZ 85119

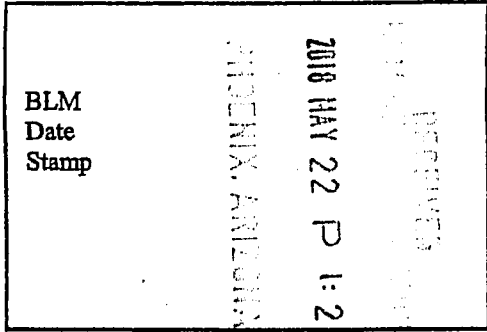

The general course of this claim is N-S and it is situated in Mohave County, Arizona. This claim is 1500 feet in length and 600 feet in width.

20 Total Claim Acreage. This claim runs from the location monument on which this location notice is posted on the centerline of the claim approximately 20 feet in a N direction to the N end line and 1480 feet in a S direction to the S end line. This claim is marked by six monuments, one at each corner and one at the center of each end line of the claim.

The location monument on which this notice is posted is situated within Section 6, Township 20 N, Range 14 W, Gila Salt River Base and Meridian, Arizona and this claim encompasses portions of the following quarter section(s), section(s), Township(s) and Range(s) SW 1/4 Sec 6 & NW 1/4 Sec 7 T. 20 N., R. 14 W.

Gila Salt River Base and Meridian, Arizona.

The locality of this claim with reference to some natural object or permanent monument and additional information (if any) concerning its locality are as follows: The NW CORNER of claim is located 900 ft. EAST and 4500 ft. SOUTH of survey monument located at NE Corner Section 1, T. 20 N., R. 15 W., GSRB & M. The above information is shown on the attached map.

DATED AND POSTED on the ground this 23 day of February, 2018.

LOCATOR(s) AGENT

Print Name(s) Nicholas Barr Signature(s) Nicklas Barr (Agent for Pershing Resources) Form MCF100

AHC451000

MINING CLAIM MAP

Lode (X) Placer ()
Millsite ()

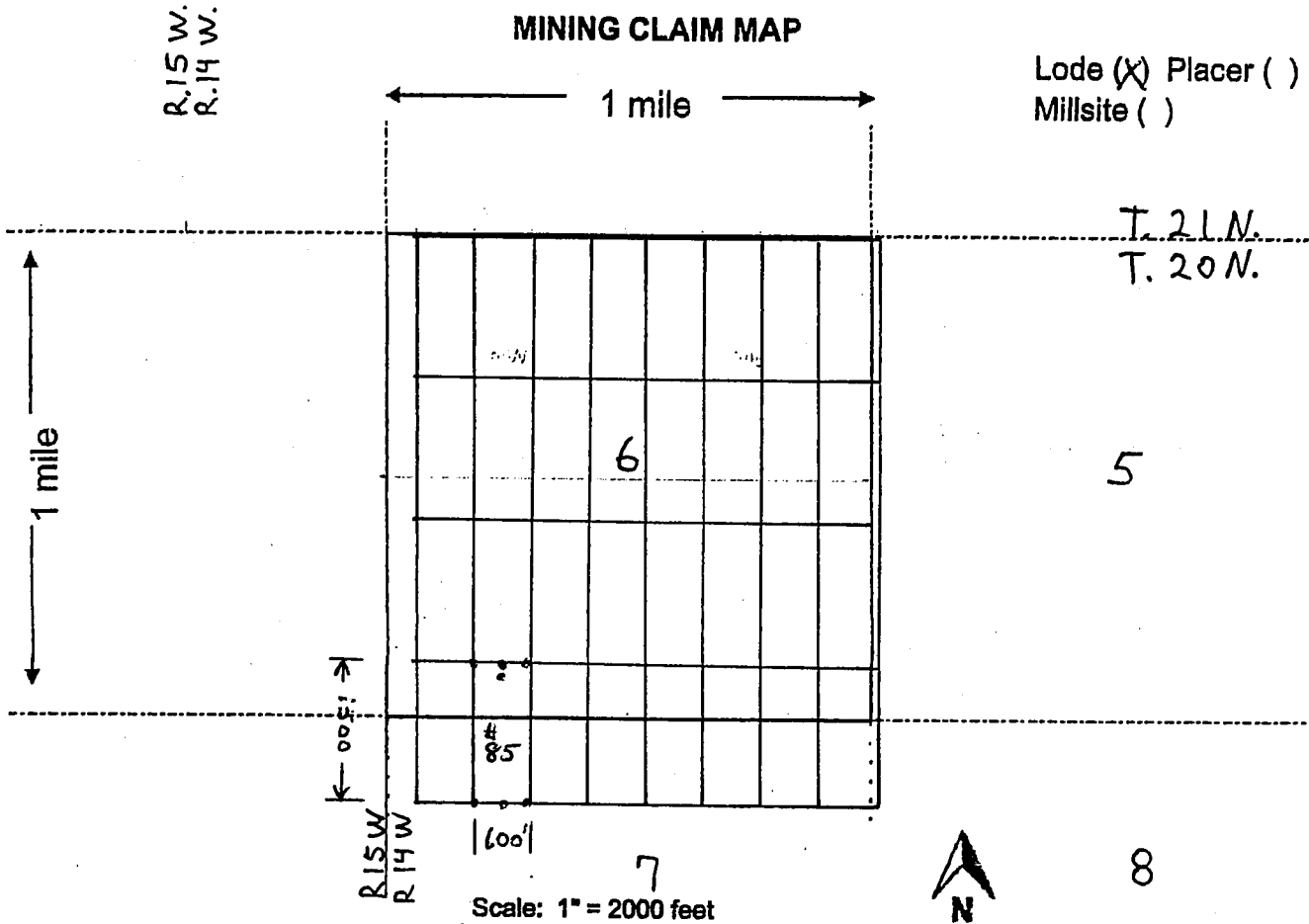

1. The above map depicts the EN # 85 mining claim, which is located in Section (s) 6 & 7, Township 20 N, Range 14 W, Gila and Salt River Base and Meridian, Mohave County, Arizona. Total claim acreage is 20 acres

2. The type of corner and location monuments used are as follows: 2" x 2" x 4 ft wood posts

3. The bearings and distances in degrees and feet between claim corners and to a public land survey monument are as depicted on the map.

4. If the claim is a placer or millsite claim with exterior limits conforming to legal subdivisions of the public survey, provide a legal description of the claim _____

22

FEE# 2018012472

OFFICIAL RECORDS OF MOHAVE COUNTY KRISTI BLAIR, COUNTY RECORDER



03/14/2018 11:36 AM Fee: \$10.00

PAGE: 1 of 2

After recording return to: Pershing Resources 200 S. Virginia St. 8th Floor Reno, Nevada 89501

LOCATION NOTICE FOR LODE MINING CLAIM

Amendment BLM Serial #

NOTICE IS HEREBY GIVEN that the EN# 86 lode mining claim has been located by Nicholas BARR (agent) whose current mailing address is 5441 E. Mining Camp St. Apache Junction, AZ 85119

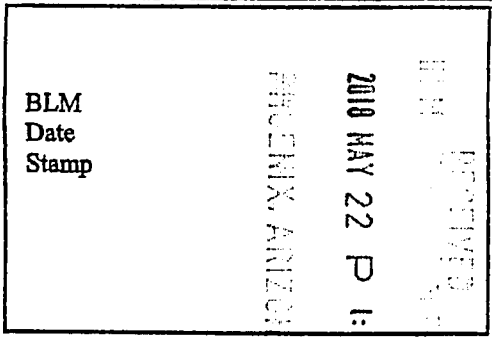

The general course of this claim is N-S and it is situated in Mohave County, Arizona. This claim is 1500 feet in length and 600 feet in width.

20 Total Claim Acreage. This claim runs from the location monument on which this location notice is posted on the centerline of the claim approximately 20 feet in a N direction to the N end line and 1480 feet in a S direction to the S end line. This claim is marked by six monuments, one at each corner and one at the center of each end line of the claim.

The location monument on which this notice is posted is situated within Section 6, Township 20 N, Range 14 W, Gila Salt River Base and Meridian, Arizona and this claim encompasses portions of the following quarter section(s), section(s), Township(s) and Range(s) SW 1/4 Sec 6 & NW 1/4 Sec 7 T. 20 N., R. 14 W.

Gila Salt River Base and Meridian, Arizona.

The locality of this claim with reference to some natural object or permanent monument and additional information (if any) concerning its locality are as follows: The NW CORNER of claim is located 1500 ft EAST and 4500 ft. SOUTH of survey monument located at NE Corner Section 1, T. 20 N., R. 15 W., GSRB & M. The above information is shown on the attached map.

DATED AND POSTED on the ground this 23 day of February, 2018.

LOCATOR(s) AGENT

Print Name(s) Nicholas Barr

Signature(s) Nicholas Barr

(Agent for Pershing Resources) Form MCF100

AHC451001

MINING CLAIM MAP

Lode (X) Placer ()
Millsite ()

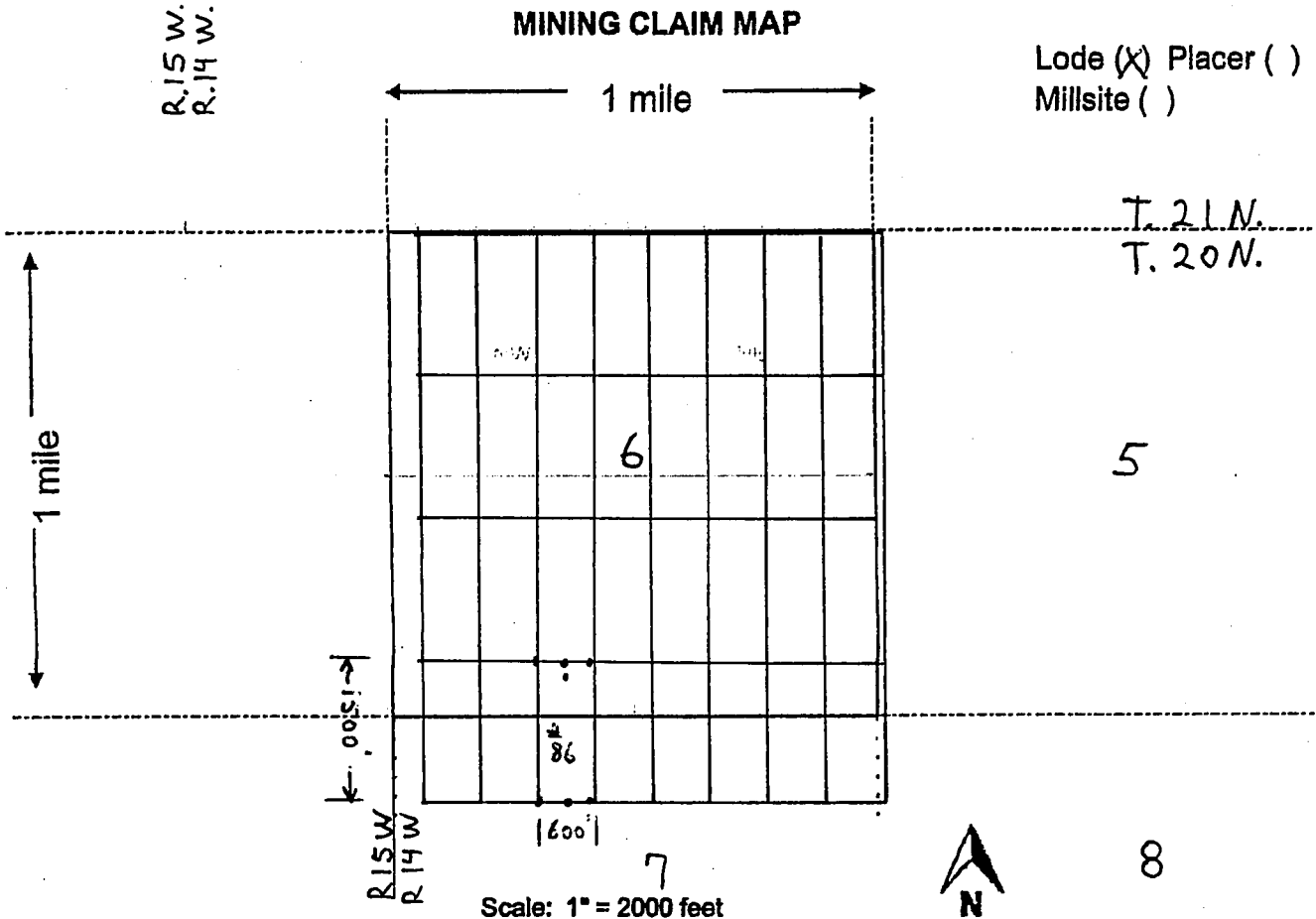

1. The above map depicts the EN # 86 mining claim, which is located in Section (s) 6 & 7, Township 20 N, Range 14 W, Gila and Salt River Base and Meridian, Mohave County, Arizona. Total claim acreage is 20 acres

2. The type of corner and location monuments used are as follows: 2" x 2" x 4 ft wood posts

3. The bearings and distances in degrees and feet between claim corners and to a public land survey monument are as depicted on the map.

4. If the claim is a placer or millsite claim with exterior limits conforming to legal subdivisions of the public survey, provide a legal description of the claim _____

FEE# 2018012473

OFFICIAL RECORDS OF MOHAVE COUNTY KRISTI BLAIR, COUNTY RECORDER



03/14/2018 11:36 AM Fee: \$10.00

PAGE: 1 of 2

After recording return to: Pershing Resources 200 S. Virginia St. 8th Floor Reno, Nevada 89501

LOCATION NOTICE FOR LOSE MINING CLAIM

Amendment BLM Serial #

NOTICE IS HEREBY GIVEN that the EN# 87 lode mining claim has been located

by Nicholas BARR (agent) whose current mailing address is 5441 E. Mining Camp St. Apache Junction, AZ 85119

BLM Date Stamp 2018 MAY 22 P 1:25 PHOENIX, ARIZONA

The general course of this claim is N-S and it is situated in Mohave County, Arizona. This claim is 1500 feet in length and 600 feet in width.

20 Total Claim Acreage. This claim runs from the location monument on which this location notice is posted on the centerline of the claim approximately 20 feet in a N direction to the N end line and 1480 feet in a S direction to the S end line. This claim is marked by six monuments, one at each corner and one at the center of each end line of the claim.

The location monument on which this notice is posted is situated within Section 6, Township 20 N, Range 14 W, Gila Salt River Base and Meridian, Arizona and this claim encompasses portions of the following quarter section(s), section(s), Township(s) and Range(s) SW 1/4 Sec 6, NW 1/4 Sec 7 T. 20 N., R. 14 W.

Gila Salt River Base and Meridian, Arizona.

The locality of this claim with reference to some natural object or permanent monument and additional information (if any) concerning its locality are as follows: The NW CORNER of claim is located 2100 ft. EAST and 4500 ft. SOUTH of survey monument located at NE Corner Section 1, T. 20 N., R. 15 W., GSRB & M. The above information is shown on the attached map.

DATED AND POSTED on the ground this 23 day of February, 2018.

LOCATOR(s) AGENT

Print Name(s) Nicholas Barr

Signature(s) Nicholas Barr

(Agent for Pershing Resources) Form MCF100

AHC451002

MINING CLAIM MAP

Lode (X) Placer ()
Millsite ()

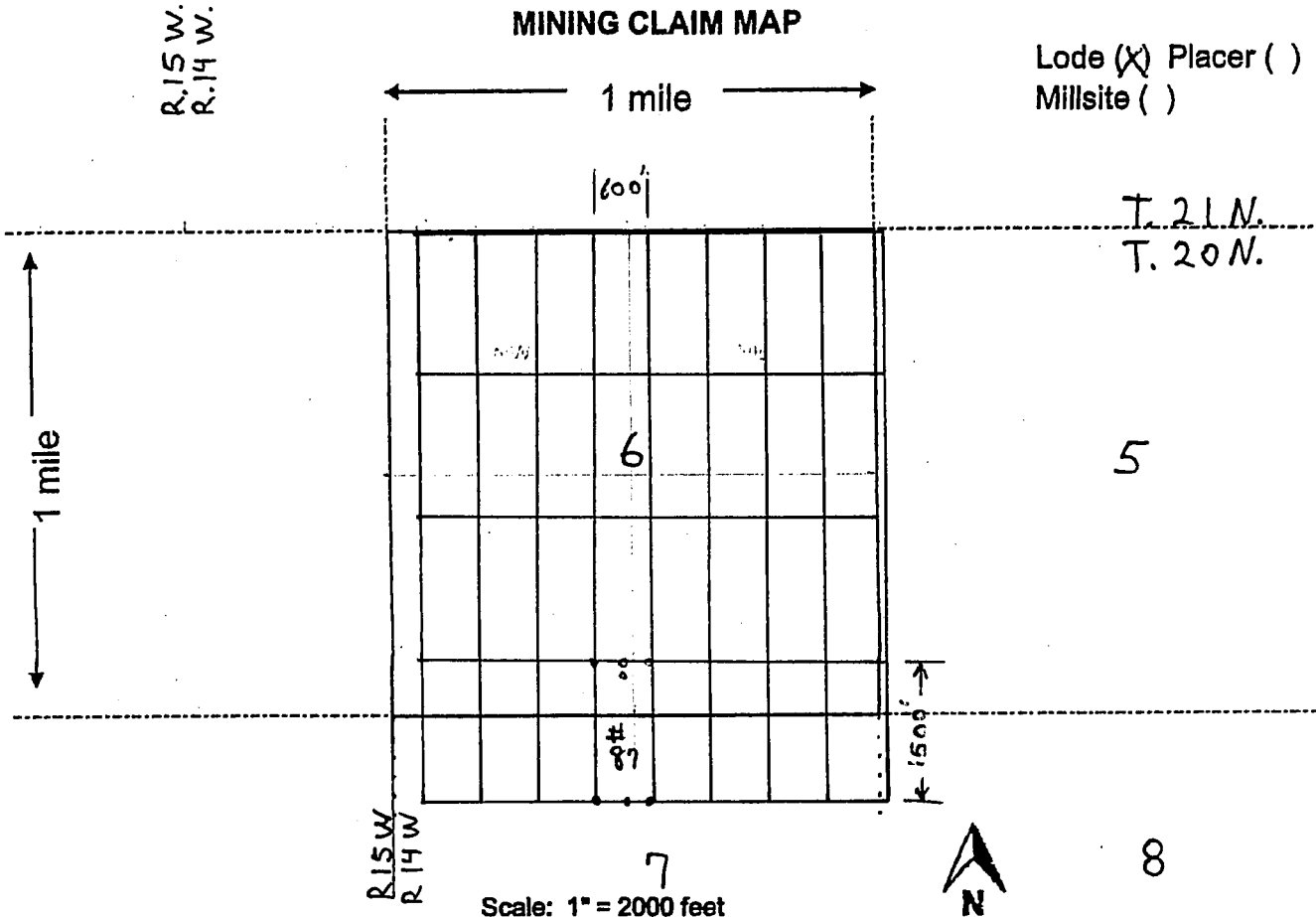

1. The above map depicts the EN # 87 mining claim, which is located in Section (s) 6 & 7, Township 20 N, Range 14 W, Gila and Salt River Base and Meridian, Mohave County, Arizona. Total claim acreage is 20 acres

2. The type of corner and location monuments used are as follows: 2" x 2" x 4 ft wood posts

3. The bearings and distances in degrees and feet between claim corners and to a public land survey monument are as depicted on the map.

4. If the claim is a placer or millsite claim with exterior limits conforming to legal subdivisions of the public survey, provide a legal description of the claim _____

2

FEE# 2018012474

OFFICIAL RECORDS OF MOHAVE COUNTY KRISTI BLAIR, COUNTY RECORDER



03/14/2018 11:36 AM Fee: \$10.00

PAGE: 1 of 2

After recording return to: Pershing Resources 200 S. Virginia St. 8th Floor Reno, Nevada 89501

LOCATION NOTICE FOR LODE MINING CLAIM

Amendment BLM Serial #

NOTICE IS HEREBY GIVEN that the EN# 88 lode mining claim has been located by Nicholas BARR (agent) whose current mailing address is 5441 E. Mining Camp St. Apache Junction, AZ 85119

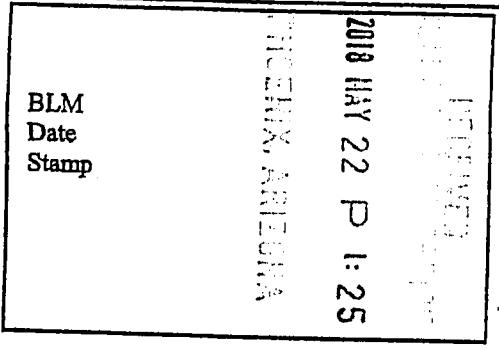

The general course of this claim is N-S and it is situated in Mohave County, Arizona. This claim is 1500 feet in length and 600 feet in width.

20 Total Claim Acreage. This claim runs from the location monument on which this location notice is posted on the centerline of the claim approximately 20 feet in a N direction to the N end line and 1480 feet in a S direction to the S end line. This claim is marked by six monuments, one at each corner and one at the center of each end line of the claim.

The location monument on which this notice is posted is situated within Section 6, Township 20 N, Range 14 W, Gila Salt River Base and Meridian, Arizona and this claim encompasses portions of the following quarter section(s), section(s), Township(s) and Range(s) SE 1/4 Sec 6 & NE 1/4 Sec 7 T. 20 N., R. 14 W.

Gila Salt River Base and Meridian, Arizona.

The locality of this claim with reference to some natural object or permanent monument and additional information (if any) concerning its locality are as follows: The NW CORNER of claim is located 2700 ft. EAST and 4500 ft. SOUTH of survey monument located at NE Corner Section 1, T. 20 N., R. 15 W., GSRB&M. The above information is shown on the attached map.

DATED AND POSTED on the ground this 23 day of February, 2018.

LOCATOR(s) AGENT

Print Name(s) Nicholas Barr Signature(s) Nicholas Barr

(Agent for Pershing Resources) Form MCF100

AHC451003

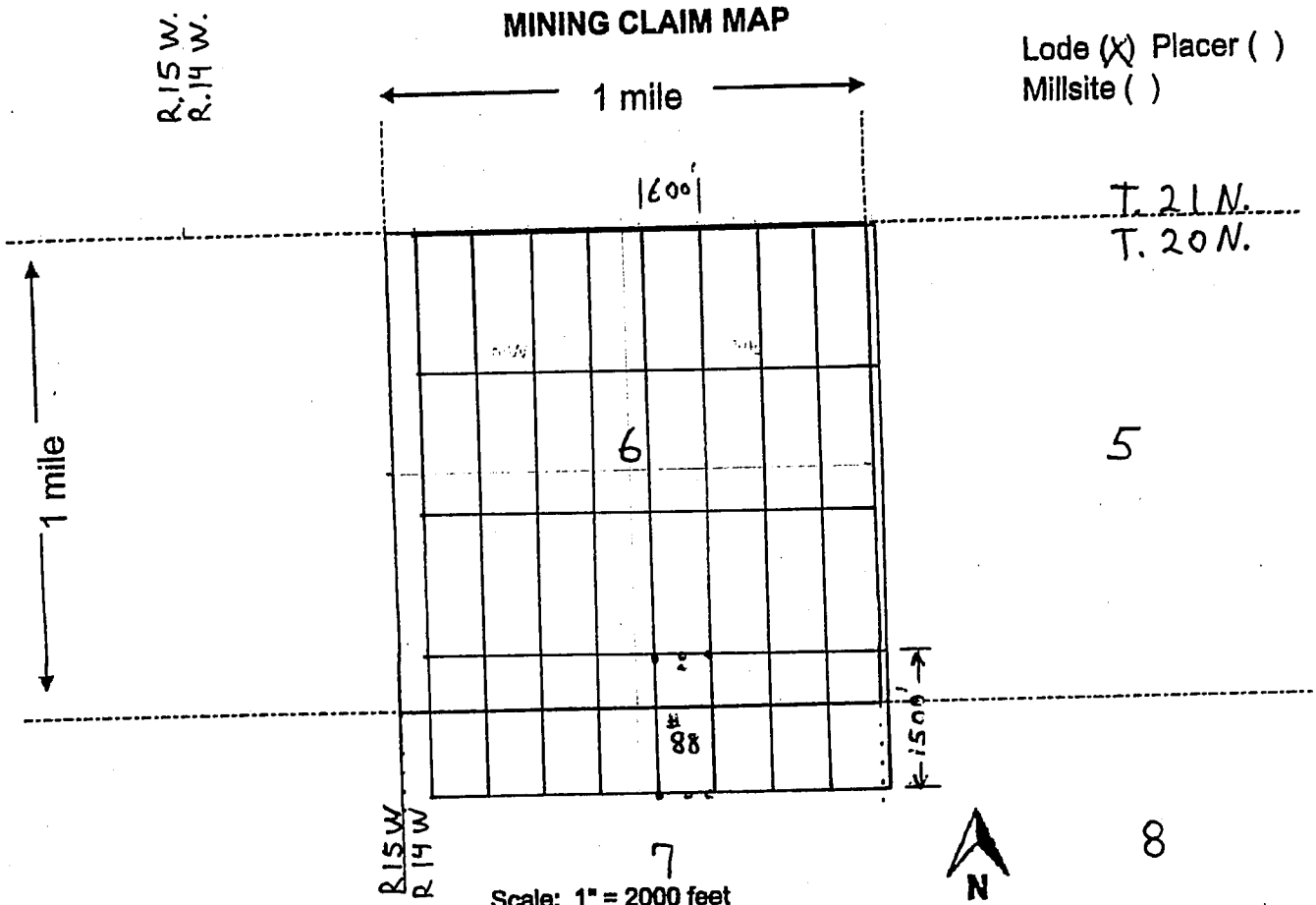

1. The above map depicts the EN # 88 mining claim, which is located in Section (s) 647, Township 20 N, Range 14 W, Gila and Salt River Base and Meridian, Mohave County, Arizona. Total claim acreage is 20 acres

2. The type of corner and location monuments used are as follows: 2" x 2" x 4 ft wood posts

3. The bearings and distances in degrees and feet between claim corners and to a public land survey monument are as depicted on the map.

4. If the claim is a placer or millsite claim with exterior limits conforming to legal subdivisions of the public survey, provide a legal description of the claim _____

2

FEE# 2018012475

OFFICIAL RECORDS OF MOHAVE COUNTY KRISTI BLAIR, COUNTY RECORDER



03/14/2018 11:36 AM Fee: \$10.00

PAGE: 1 of 2

After recording return to: Pershing Resources 200 S. Virginia St. 8th Floor Reno, Nevada 89501

LOCATION NOTICE FOR LODE MINING CLAIM

Amendment BLM Serial #

NOTICE IS HEREBY GIVEN that the EN# 89 lode mining claim has been located by Nicholas BARR (agent) whose current mailing address is 5441 E. Mining Camp St. Apache Junction, AZ 85119

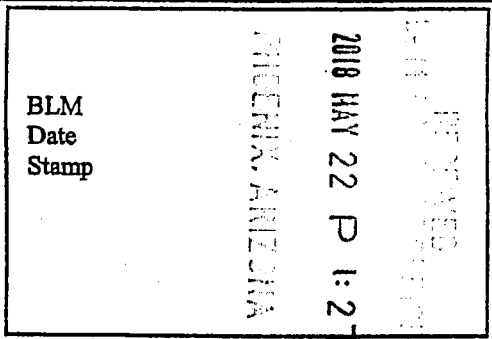

The general course of this claim is N-S and it is situated in Mohave County, Arizona. This claim is 1500 feet in length and 600 feet in width.

20 Total Claim Acreage. This claim runs from the location monument on which this location notice is posted on the centerline of the claim approximately 20 feet in a N direction to the N end line and 1480 feet in a S direction to the S end line. This claim is marked by six monuments, one at each corner and one at the center of each end line of the claim.

The location monument on which this notice is posted is situated within Section 6, Township 20 N, Range 14 W, Gila Salt River Base and Meridian, Arizona and this claim encompasses portions of the following quarter section(s), section(s), Township(s) and Range(s) SE 1/4 Sec 6 & NE 1/4 Sec 7 T. 20 N., R. 14 W.

Gila Salt River Base and Meridian, Arizona.

The locality of this claim with reference to some natural object or permanent monument and additional information (if any) concerning its locality are as follows: The NW CORNER of claim is located 3300 ft. EAST and 4500 ft. SOUTH of survey monument located at NE Corner Section 1, T. 20 N., R. 15 W. GSRB & M. The above information is shown on the attached map.

DATED AND POSTED on the ground this 23 day of February, 2018.

LOCATOR(s) AGENT

Print Name(s) Nicholas Barr

Signature(s) Nicholas Barr

(Agent for Pershing Resources) Form MCF100

AHC451004

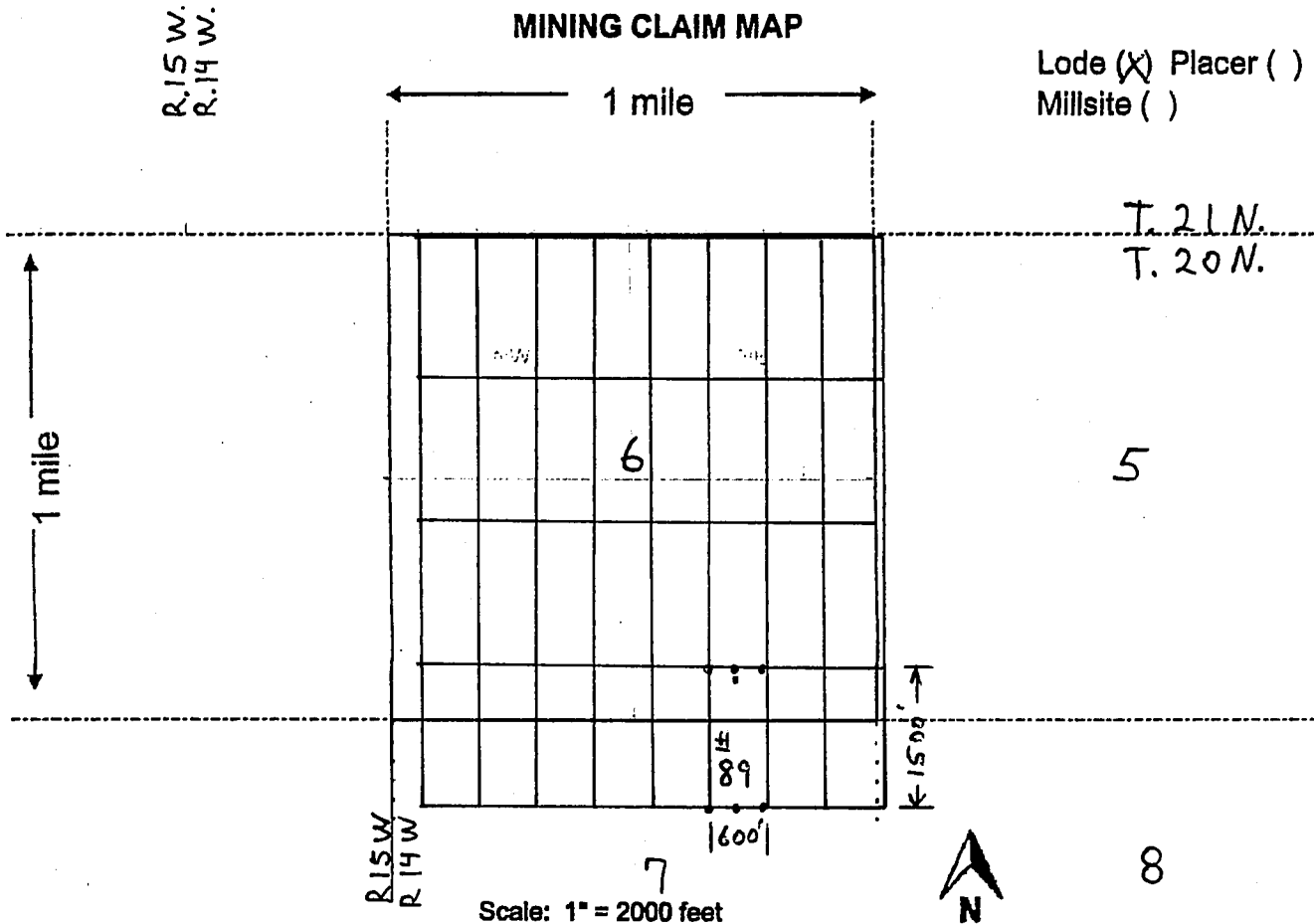

1. The above map depicts the EN # 89 mining claim, which is located in Section (s) 6 & 7, Township 20 N, Range 14 W, Gila and Salt River Base and Meridian, Mohave County, Arizona. Total claim acreage is 20 acres
2. The type of corner and location monuments used are as follows: 2" x 2" x 4 ft wood posts
3. The bearings and distances in degrees and feet between claim corners and to a public land survey monument are as depicted on the map.
4. If the claim is a placer or millsite claim with exterior limits conforming to legal subdivisions of the public survey, provide a legal description of the claim _____

Form MCF100a
Revised July 2014

FEE# 2018012476

OFFICIAL RECORDS OF MOHAVE COUNTY KRISTI BLAIR, COUNTY RECORDER



03/14/2018 11:36 AM Fee: \$10.00

PAGE: 1 of 2

After recording return to: Pershing Resources 200 S. Virginia St. 8th Floor Reno, Nevada 89501

LOCATION NOTICE FOR LODE MINING CLAIM

Amendment BLM Serial #

NOTICE IS HEREBY GIVEN that the

EN# 90 lode mining claim has been located by Nicholas BARR (agent) whose current mailing address is 5441 E. Mining Camp St. Apache Junction, AZ 85119

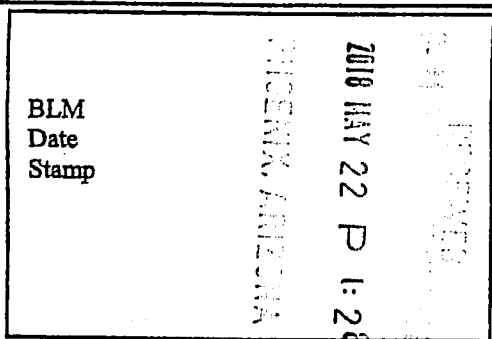

The general course of this claim is N-S and it is situated in Mohave County, Arizona. This claim is 1500 feet in length and 600 feet in width.

20 Total Claim Acreage. This claim runs from the location monument on which this location notice is posted on the centerline of the claim approximately 20 feet in a N direction to the N end line and 1480 feet in a S direction to the S end line. This claim is marked by six monuments, one at each corner and one at the center of each end line of the claim.

The location monument on which this notice is posted is situated within Section 6, Township 20 N, Range 14 W, Gila Salt River Base and Meridian, Arizona and this claim encompasses portions of the following quarter section(s), section(s), Township(s) and Range(s) SE 1/4 Sec 6 & NE 1/4 Sec 7 T. 20 N. R. 14 W.

Gila Salt River Base and Meridian, Arizona.

The locality of this claim with reference to some natural object or permanent monument and additional information (if any) concerning its locality are as follows: The NW CORNER of claim is located 3900 ft. EAST and 4500 ft. SOUTH of survey monument located at NE Corner Section 1, T. 20 N. R. 15 W. GSRB & M. The above information is shown on the attached map.

DATED AND POSTED on the ground this 23 day of February, 2018.

LOCATOR(s) AGENT

Print Name(s) Nicholas Barr

Signature(s) Nicholas Barr

(Agent for Pershing Resources) Form MCF100

AHC451005

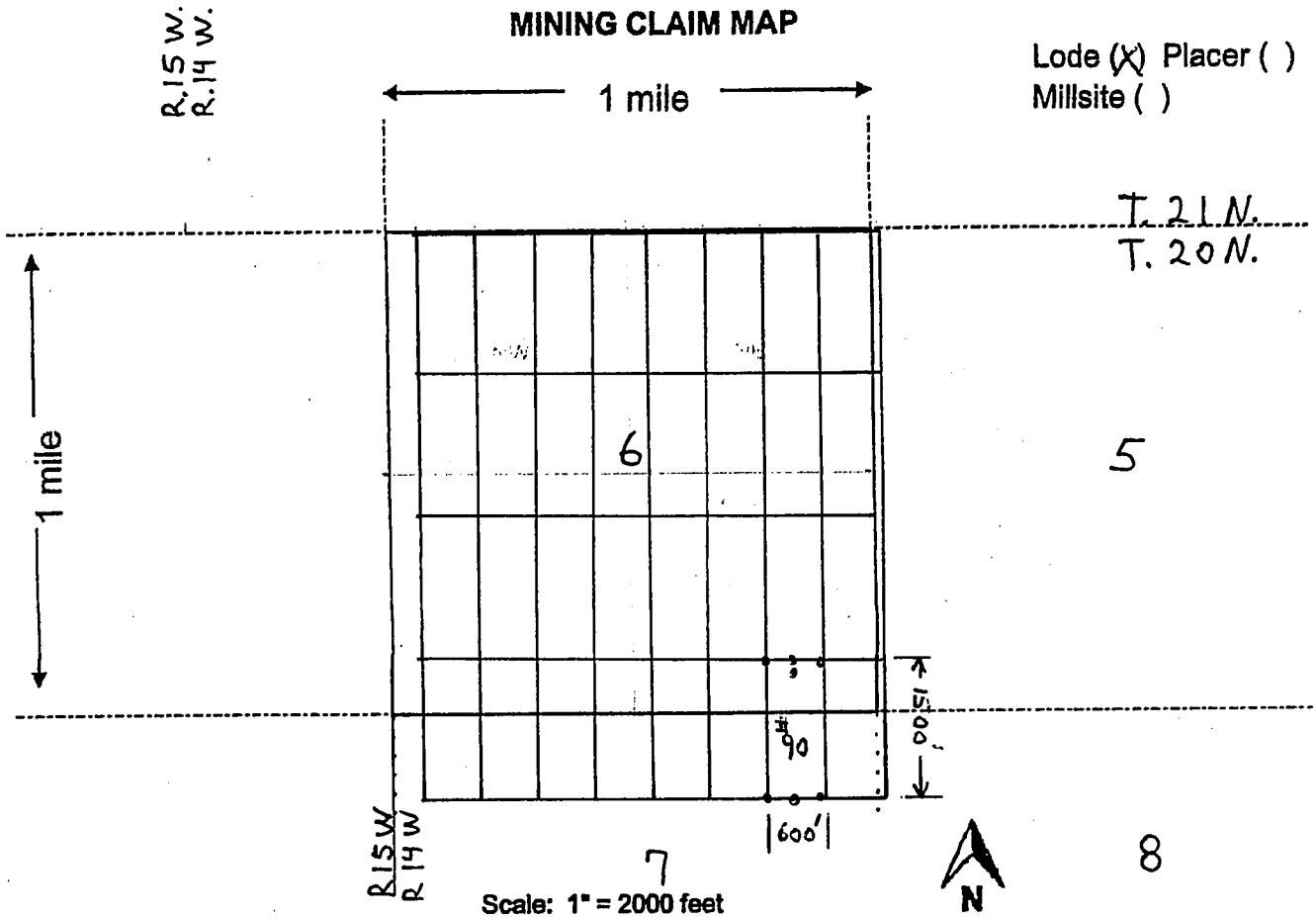

1. The above map depicts the EN # 90 mining claim, which is located in Section (s) 6 & 7, Township 20 N, Range 14 W, Gila and Salt River Base and Meridian, Mohave County, Arizona. Total claim acreage is 20 acres
2. The type of corner and location monuments used are as follows: 2" x 2" x 4 ft wood posts
3. The bearings and distances in degrees and feet between claim corners and to a public land survey monument are as depicted on the map.
4. If the claim is a placer or millsite claim with exterior limits conforming to legal subdivisions of the public survey, provide a legal description of the claim _____

Form MCF100a
Revised July 2014

FEE# 2018012477

OFFICIAL RECORDS OF MOHAVE COUNTY KRISTI BLAIR, COUNTY RECORDER



03/14/2018 11:36 AM Fee: \$10.00

PAGE: 1 of 2

After recording return to: Pershing Resources 200 S. Virginia St. 8th Floor Reno, Nevada 89501

LOCATION NOTICE FOR LODE MINING CLAIM

Amendment BLM Serial #

NOTICE IS HEREBY GIVEN that the EN # 91 lode mining claim has been located by Nicholas BARR (agent) whose current mailing address is 5441 E. Mining Camp St. Apache Junction, AZ 85119

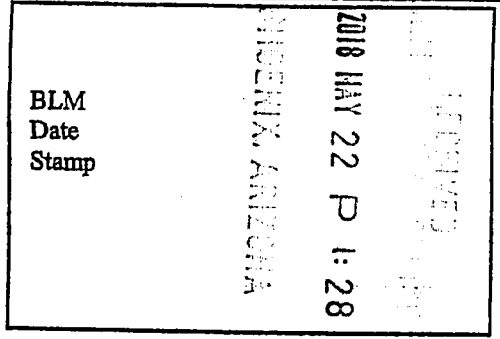

The general course of this claim is N-S and it is situated in Mohave County, Arizona. This claim is 1500 feet in length and 600 feet in width.

20 Total Claim Acreage. This claim runs from the location monument on which this location notice is posted on the centerline of the claim approximately 20 feet in a N direction to the N end line and 1480 feet in a S direction to the S end line. This claim is marked by six monuments, one at each corner and one at the center of each end line of the claim.

The location monument on which this notice is posted is situated within Section 6, Township 20 N, Range 14 W, Gila Salt River Base and Meridian, Arizona and this claim encompasses portions of the following quarter section(s), section(s), Township(s) and Range(s) SE 1/4 Sec 6, SW 1/4 Sec 5 T. 20 N., R. 14 W. & NE 1/4 Sec 7 & NW 1/4 Sec 8 T. 20 N., R. 14 W Gila Salt River Base and Meridian, Arizona.

The locality of this claim with reference to some natural object or permanent monument and additional information (if any) concerning its locality are as follows: The NW CORNER of claim is located 4500 ft. EAST and 4500 ft. SOUTH of survey monument located at NE Corner Section 1, T. 20 N., R. 15 W., GSRB & M. The above information is shown on the attached map.

DATED AND POSTED on the ground this 23 day of February, 2018.

LOCATOR(s) AGENT

Print Name(s) Nicholas Barr

Signature(s) [Handwritten Signature]

(Agent for Pershing Resources) Form MCF100

AHC451006

MINING CLAIM MAP

Lode (X) Placer ()
Millsite ()

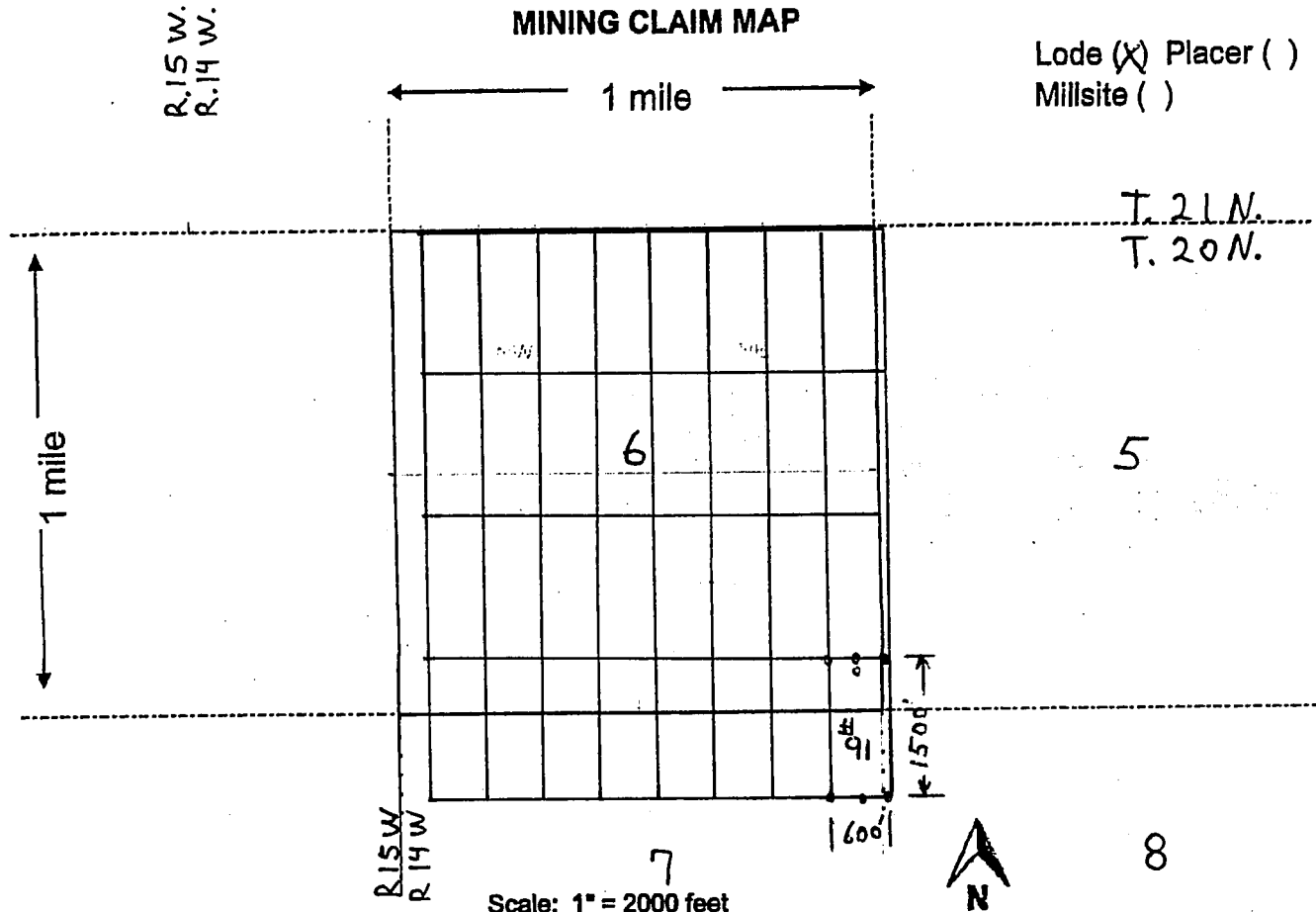

Scale: 1" = 2000 feet

1. The above map depicts the EN # 91 mining claim, which is located in Section (s) 5, 6, 7 & 8, Township 20 N, Range 14 W, Gila and Salt River Base and Meridian, Mohave County, Arizona. Total claim acreage is 20 acres

2. The type of corner and location monuments used are as follows: 2" x 2" x 4 ft wood posts

3. The bearings and distances in degrees and feet between claim corners and to a public land survey monument are as depicted on the map.

4. If the claim is a placer or millsite claim with exterior limits conforming to legal subdivisions of the public survey, provide a legal description of the claim _____

Form MCF100a
Revised July 2014

DEPARTMENT OF INTERIOR
BUREAU OF LAND MANAGEMENT

Input Parameters for Geographic Report with Land

System Id = CR

Admin State = AZ

Geo State =

Casetype Begins With

Case Disp Txt = AUTHORIZED, CANCELLED, EXPIRED, PENDING, REJECTED, VOID, WITHDRAWN

Mer Twp Rng =

Section =

Mtrs = 14 0200N 0140W 005, 14 0200N 0140W 006, 14 0200N 0140W 007, 14 0200N 0140W 008, 14 0200N 0140W 020, 14 0200N 0140W 999

Commodity =

Commodity Txt =

Pending Org =

Pend Org Decode =

Total Rows Returned: 14

RUN TIME: 11:28 AM

UNITED STATES DEPARTMENT OF INTERIOR
BUREAU OF LAND MANAGEMENT
GEOGRAPHIC REPORT WITH LAND
Sorted by Serial Number

RUN DATE: 05/30/2018
Page 1 of 2

Adm State: AZ

Serial Number: AZA 013138PT
Total Case Acres: 24,649.070

<u>Casetype</u>	<u>Case Disp</u>	14	0200N	0140W	<u>Sect</u>	<u>Sur Typ</u>	<u>Sur Num</u>	<u>Suff</u>	<u>Subdivision</u>	<u>Act Pend</u>
220100	AUTHORIZED				005	ALIQ			S2N2,S2;	
						LOTS			1-4;	
					006	ALIQ			S2NE,SE,SW,E2SW,SE;	
						LOTS			1-7;	
					007	ALIQ			NE,E2NW;	

Serial Number: AZA 018820
Total Case Acres: 10.000

<u>Casetype</u>	<u>Case Disp</u>	14	0200N	0140W	<u>Sect</u>	<u>Sur Typ</u>	<u>Sur Num</u>	<u>Suff</u>	<u>Subdivision</u>	<u>Act Pend</u>
286203	AUTHORIZED				007	LOTS			4;	

Serial Number: AZA 022580
Total Case Acres: 1.010

<u>Casetype</u>	<u>Case Disp</u>	14	0200N	0140W	<u>Sect</u>	<u>Sur Typ</u>	<u>Sur Num</u>	<u>Suff</u>	<u>Subdivision</u>	<u>Act Pend</u>
281001	AUTHORIZED				007	LOTS			4;	

Serial Number: AZA 022698PT
Total Case Acres: 11,747.600

<u>Casetype</u>	<u>Case Disp</u>	14	0200N	0140W	<u>Sect</u>	<u>Sur Typ</u>	<u>Sur Num</u>	<u>Suff</u>	<u>Subdivision</u>	<u>Act Pend</u>
221006	AUTHORIZED				020	ALIQ			ALL;	

Serial Number: AZA 023263
Total Case Acres: 6.270

<u>Casetype</u>	<u>Case Disp</u>	14	0200N	0140W	<u>Sect</u>	<u>Sur Typ</u>	<u>Sur Num</u>	<u>Suff</u>	<u>Subdivision</u>	<u>Act Pend</u>
281001	AUTHORIZED				005	ALIQ			SENE;	
						LOTS			1;	
					007	MNR		1	S2S2S2NE;	

RUN TIME: 11:28 AM

UNITED STATES DEPARTMENT OF INTERIOR
BUREAU OF LAND MANAGEMENT
GEOGRAPHIC REPORT WITH LAND
Sorted by Serial Number

RUN DATE: 05/30/2018
Page 2 of 2

Adm State: AZ

Serial Number: AZA 029135
Total Case Acres: 22.560

<u>Casetype</u>	<u>Case Disp</u>	14	0200N	0140W	<u>Sect</u>	<u>Sur Typ</u>	<u>Sur Num</u>	<u>Suff</u>	<u>Subdivision</u>	<u>Act Pend</u>
281001	AUTHORIZED				007	LOTS MNR		1	2; S2SWNE,S2SEW;	

Serial Number: AZA 033143
Total Case Acres: 2.400

<u>Casetype</u>	<u>Case Disp</u>	14	0200N	0140W	<u>Sect</u>	<u>Sur Typ</u>	<u>Sur Num</u>	<u>Suff</u>	<u>Subdivision</u>	<u>Act Pend</u>
281001	AUTHORIZED				007	LOTS			4;	

Serial Number: AZAR 0002061
Total Case Acres: 46.160

<u>Casetype</u>	<u>Case Disp</u>	14	0200N	0140W	<u>Sect</u>	<u>Sur Typ</u>	<u>Sur Num</u>	<u>Suff</u>	<u>Subdivision</u>	<u>Act Pend</u>
285002	AUTHORIZED				007	LOTS			2-4;	Y

Extremely Urgent

Visit theupsstore.com or call **1-800-PICK-UPS®** (1-800-742-5877) to find a location near you.

Domestic Shipments

- To qualify for the Letter rate, UPS Express Envelopes may only contain correspondence, urgent documents, and/or electronic media, and must weigh 8 oz. or less. UPS Express Envelopes containing items other than those listed or weighing more than 8 oz. will be billed by weight.

International Shipments

- The UPS Express Envelope may be used only for documents of no commercial value. Certain countries consider electronic media as documents. Visit ups.com/importexport to verify if your shipment is classified as a document.
- To qualify for the Letter rate, the UPS Express Envelope must weigh 8 oz. or less. UPS Express Envelopes weighing more than 8 oz. will be billed by weight.

Note: Express Envelopes are not recommended for shipments of electronic media containing sensitive personal information or breakable items. Do not send cash or cash equivalent.

JOEL ADAMS
(646) 387-6859
THE UPS STORE #6514
163 AMSTERDAM AVE
NEW YORK NY 10023-5001

0.3 LBS LTR 1 0
SHP WT: LTR
DATE: 17 MAY 2018

SHIP (602) 417-9200
TO: BUREAU OF LAND MANAGEMENT
STE 800
1 N CENTRAL AVE

PHOENIX AZ 85004-4427

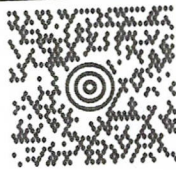

AZ 850 9-10



UPS 2ND DAY AIR A.M. 2A
TRACKING #: 1Z 0V0 937 19 5111 7227

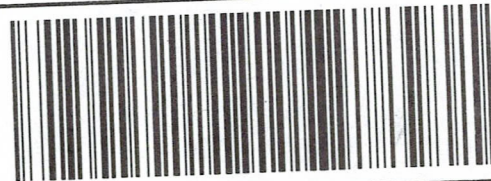

BILLING: P/P
SIGNATURE REQUIRED

REF #1: NJ

1SH 13.00N Z2P 450 99.5U 04/2018



SEE NOTICE ON REVERSE regarding UPS Terms, and notice of limitation of liability. Where allowed by law, shipper authorizes UPS to act as forwarding agent for export control and customs purposes. If exported from the US, shipper certifies that the commodities, technology or software were exported from the US in accordance with the Export Administration Regulations. Diversion contrary to law is prohibited. 800 R 0518

Serving you for more than 100 years
United Parcel Service.



Apply shipping documents on this side.

Do not use this envelope for:

- UPS Ground
- UPS Standard
- UPS 3 Day Select®
- UPS Worldwide Expedited®

Visit theupsstore.com to learn more about our Print & Business Services.

International Shipping Notice — Carriage hereunder may be subject to the rules relating to liability and other terms and/or conditions established by the Convention for the Unification of Certain Rules Relating to International Carriage by Air (the "Warsaw Convention") and/or the Convention on the Contract for the International Carriage of Goods by Road (the "CMR Convention"). These commodities, technology or software were exported from the U.S. in accordance with the Export Administration Regulations. Diversion contrary to U.S. law prohibited.

01880250709 07/15 United Parcel Service

The UPS Store®



Print & Business Services

Airpress envelope



theupsstore.com
theupsstorefranchise.com

Extremely Urgent

This envelope is for use with the following services: **UPS Next Day Air®**
UPS Worldwide Express™
UPS 2nd Day Air®

Visit theupsstore.com or call **1-800-PICK-UPS®** (1-800-742-5877) to find a location near you.

Domestic Shipments

- To qualify for the Letter rate, UPS Express Envelopes may only contain correspondence, urgent documents, and/or electronic media, and must weigh 8 oz. or less. UPS Express Envelopes containing items other than those listed or weighing more than 8 oz. will be billed by weight.

International Shipments

- The UPS Express Envelope may be used only for documents of no commercial value. Certain countries consider electronic media as documents. Visit ups.com/importexport to verify if your shipment is classified as a document.
- To qualify for the Letter rate, the UPS Express Envelope must weigh 8 oz. or less. UPS Express Envelopes weighing more than 8 oz. will be billed by weight.

Note: Express Envelopes are not recommended for shipments of electronic media containing sensitive personal information or breakable items. Do not send cash or cash equivalent.

Apply shipping documents on this side.

Do not use this envelope for:

- UPS Ground**
- UPS Standard**
- UPS 3 Day Select®**
- UPS Worldwide Expedited®**

Visit theupsstore.com to learn more about our Print & Business Services.

JOEL ADAMS
(646) 387-6859
THE UPS STORE #6514
163 AMSTERDAM AVE
NEW YORK NY 10023-5001

1.0 LBS LTR 1
SHIP WT: 1 LBS
DATE: 18 MAY 2018

SHIP ATTN: BUREAU OF LAND MANAGEMENT
TO: US DEPARTMENT OF THE INTERIOR
STE 800
1 N CENTRAL AVE

PHOENIX AZ 85004-4427

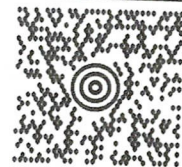

AZ 850 9-10



UPS NEXT DAY AIR 1
TRACKING #: 1Z 0V0 937 24 4945 2243

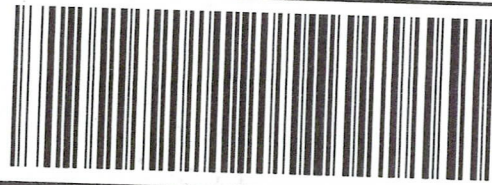

BILLING: P/P
SIGNATURE REQUIRED

REF #1: NJ

ISH 13.00M Z2P 450 99.5U 04/2018



SEE NOTICE ON REVERSE regarding UPS terms, and notice of limitation of liability. Where allowed by law, shipper authorizes UPS to act as forwarding agent for export control and customs purposes. If exported from the US, shipper certifies that the commodities, technology or software were exported from the US in accordance with the Export Administration Regulations. Diversion contrary to law is prohibited. #904 8 0518

More than 100 years
United Parcel Service.



International Shipping Notice — Carriage hereunder may be subject to the rules relating to liability and other terms and/or conditions established by the Convention for the Unification of Certain Rules Relating to International Carriage by Air (the "Warsaw Convention") and/or the Convention on the Contract for the International Carriage of Goods by Road (the "CMR Convention"). These commodities, technology or software were exported from the U.S. in accordance with the Export Administration Regulations. Diversion contrary to U.S. law prohibited.

01880250709 07/15 United Parcel Service

100% Recycled fiber
80% Post-Consumer



PHOENIX, ARIZONA
2018 MAY 22 P 1:26
RECEIVED
BLM / BUREAU OF LAND MANAGEMENT

Express

envelope

Print & Business Services • theupsstore.com

theupsstore.com

